

Peso distribuído de maneira uniforme

Peso distribuído de maneira uniforme

Distributed weight so uniform

Passo Paso Step 11

OPÇÃO 1
OPCIÓN 1
OPTION 1

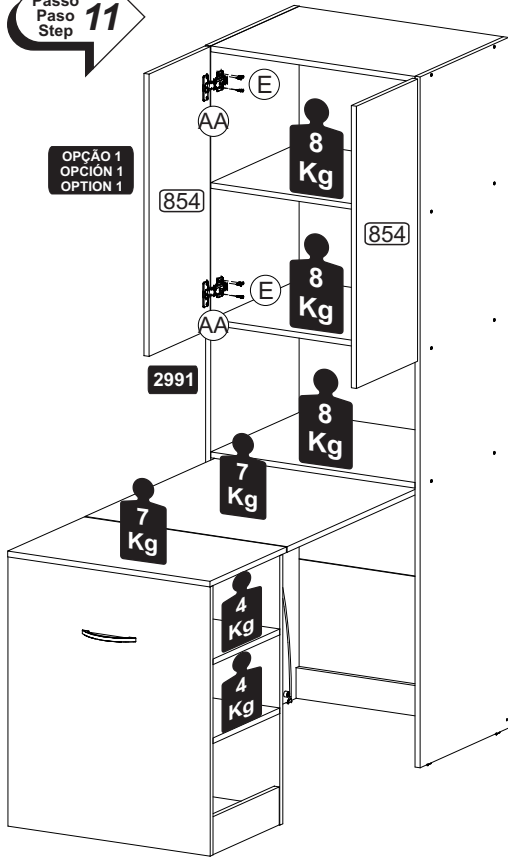

2991

OPÇÃO 2
OPCIÓN 2
OPTION 2

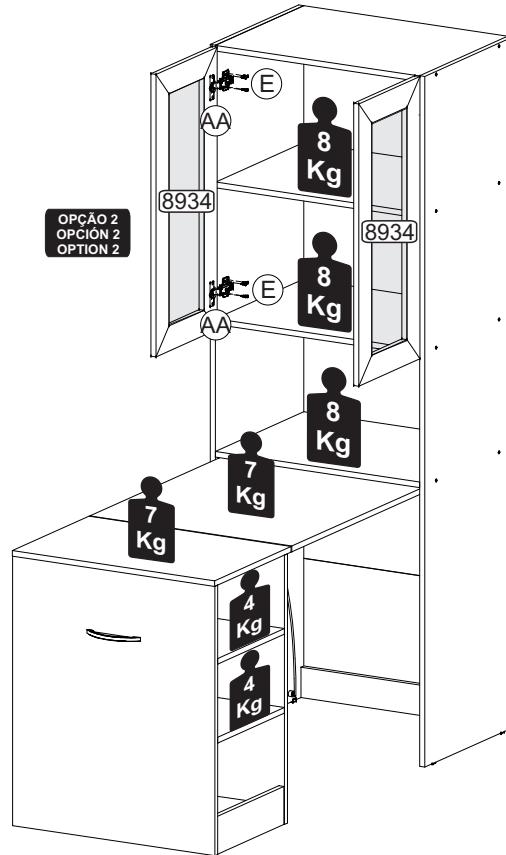

INSTRUÇÕES DE MONTAGEM
INSTRUCCIONES DE ARMADO
ASSEMBLY INSTRUCTIONS

2991

OPÇÃO 1
OPCIÓN 1
OPTION 1



OPÇÃO 2
OPCIÓN 2
OPTION 2

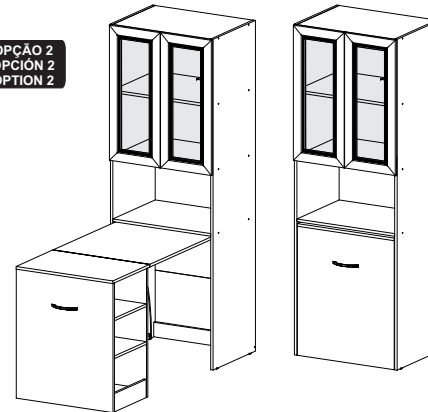

2992

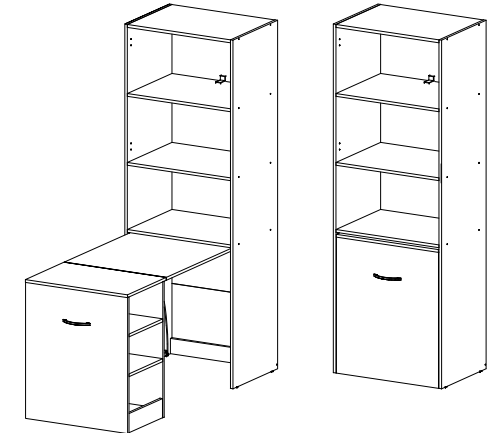

REF.: 2991/2992

OBRIGATÓRIO FIXAR NA PAREDE
OBLIGATORIO DE FIJAR EN LA PARED
MANDATORY TO FIX ON THE WALL

FERRAMENTAS NECESSÁRIAS
HERRAMIENTAS NECESARIAS
TOOLS NECESSARY

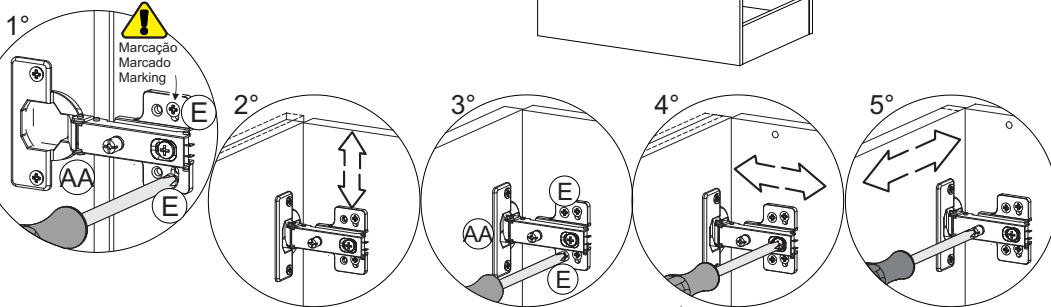
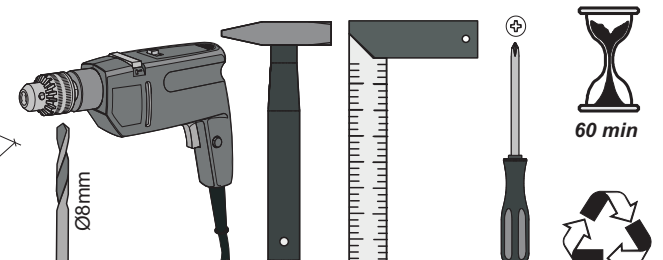
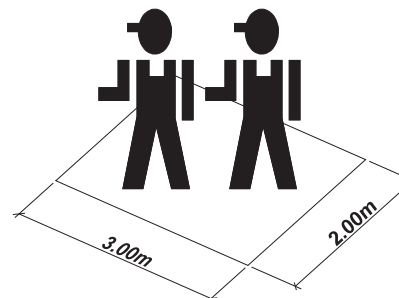

LISTA DE FERRAGENS / LISTA DE MATERIALES / HARDWARE LIST

Passo
Paso
Step **10**

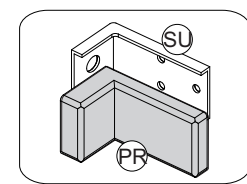
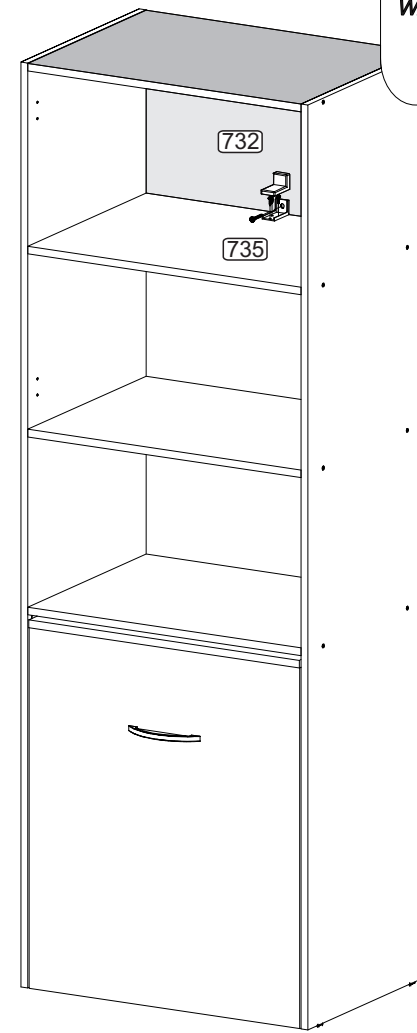
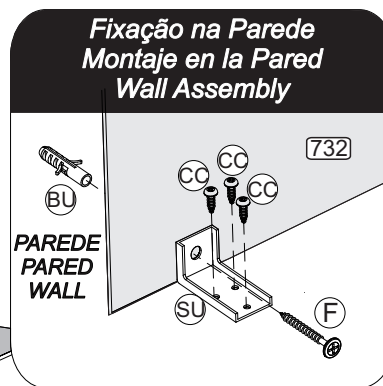
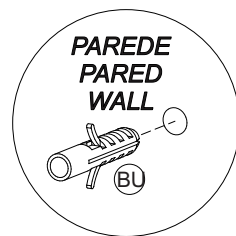
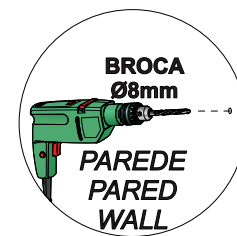

Ref.:2991/2992 - 14/Fevereiro/2020 - Rev. 00



AE		Fixador de Costa	04
B		Paraf. 4,5 x 50	18
BU		Bucha Ø8mm	01
BZ		Sapata L	04
BX		Bisnaga de cola 12gr	01
BW		Paraf. M4 x 20	02
CC		Parafuso 3,5 x 14	11
DO		Dobradiça	02
E		Paraf. 3,5 x 14	17
F		Parafuso 5,0 x 45	01
FF		Cantoneira	02
H		Cavilha 8,0 x 30	42
G		Tampa Adesiva	18
JJ		Paraf. 3,5 x 16	02
N		Bigfix Anelado	16
O		Tambor Minifix	16
PR		Capa p/ Suporte Aéreo	01
PX		Puxador	01
Q		Tampa Plastica	04
RD		Rodizio RB	04
SU		Suporte Aéreo	01
TT		Suporte Prateleira	02
Y		Prego 10 x 10	48

Somente na referência 2991 /Solo referencia 2991 /Reference 2991 only

AA		Dobradiça	04
E		Paraf. 3,5 x 14	24

**OBRIGATÓRIO FIXAR NA PAREDE
OBLIGATORIO DE FIJAR EN LA PARED
MANDATORY TO FIX ON THE WALL**



**COLOCAR O PINO DA CANTONEIRA (FF)
NA RANHURA E ARRASTAR ATÉ A MARCAÇÃO DA PEÇA TAMPO MESA MAIOR (731)
APÓS COLOCAR O PARAFUSO (E) NA CANTONEIRA (FF) NA MARCAÇÃO**

**COLOQUE EL PIN DEL CANTONERA (FF)
EN LA RANURA Y ARREGÚLELO A LA GRAN MESA DE MARCA SUPERIOR (731)
DESPUÉS COLOCAR EL TORNILLO (E) EN EL CANTONEIRA (FF) EN LA MARCA**

**PLACE THE CORNER PIN (TT)
IN THE AND DRAG IT TO THE MARKING OF THE LARGER TABLE TOP (731)
AFTER PLACING THE SCREW (E) IN THE CORNER (FF) IN THE MARKING**

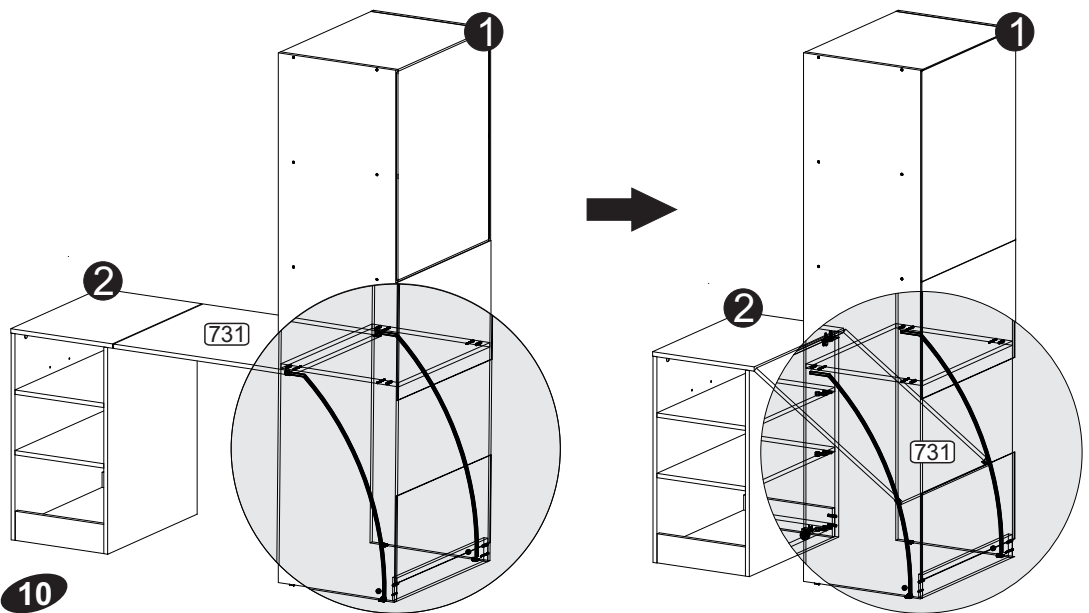
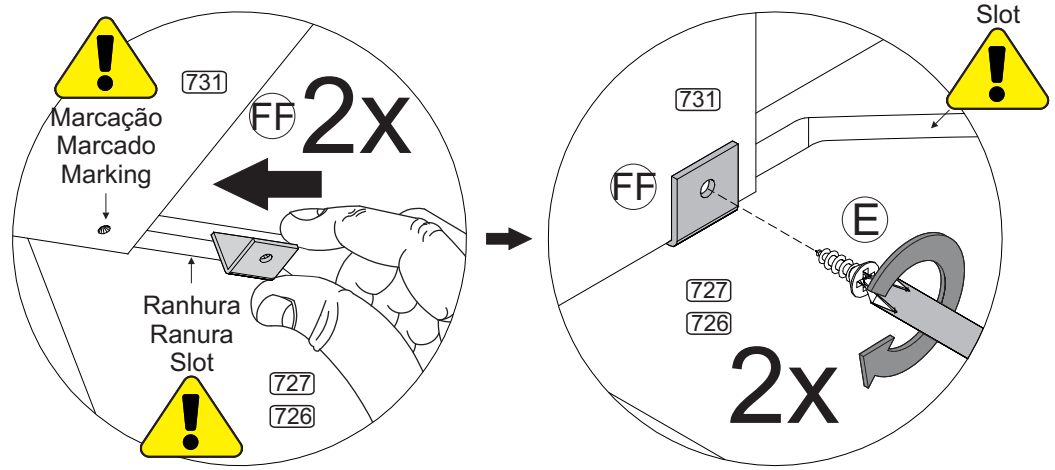

Senhor montador!
Informamos que a numeração das peças encontra-se no topo das mesmas conforme desenho acima.

Señor Armador!
Les informamos que la numeración de las piezas encuentranse arriba de las mismas, de acuerdo al modelo arriba.

Dear Assembler!
We inform you that the number of each piece is located on the top of it, according to the model shown above.

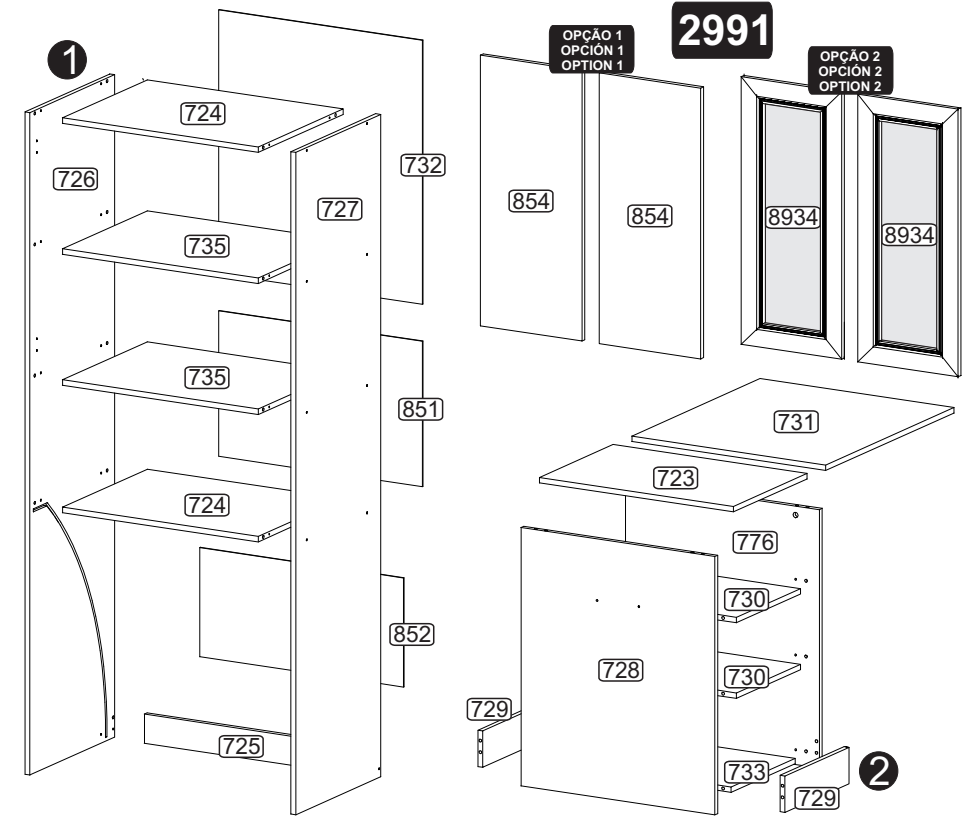

POR	LISTA DE PEÇAS	ESP	LISTA DE PIEZAS	ENG	PART LIST
Nº	DENOMINAÇÃO	Nº	DENOMINACIÓN	Nº	DESCRIPTION
723	TAMPO MESA MENOR	723	TAPA	723	TOP
724	TAMPO/PRATELEIRA	724	TAPA/ESTANTE	724	TOP/SHELF
725	RODAPÉ	725	ZÓCALO	725	SKIRTING BOARD
726	LATERAL ESQUERDA	726	LATERAL IZQUIERDA	726	LEFT SIDE
727	LATERAL DIREITA	727	LATERAL DERECHA	727	RIGHT SIDE
728	FRENTE MESA	728	MESA DELANTERA	728	FRONT TABLE
729	RODAPÉ MENOR	729	ZÓCALO MENOR	729	SMALLER SKIRTING BOARD
730	PRATELEIRA MENOR	730	ESTANTE MENOR	730	SMALLER SHELF
731	TAMPO MESA MAIOR	731	TAPA MESA MAYOR	731	TABLE LARGER TOP
732	COSTA SUPERIOR	732	RESPALDO SUPERIOR	732	UPPER BACK
733	BASE	733	BASE	733	BASE
735	PRATELEIRA SUPERIOR	735	ESTANTE SUPERIOR	735	UPPER SHELF
776	COSTA MESA	776	RESPALDO MESA	776	TABLE BACK
851	COSTA CENTRAL	852	RESPALDO CENTRAL	852	LOWER BACK
852	COSTA INFERIOR	852	RESPALDO INFERIOR	852	LOWER BACK
854	PORTA	854	PUERTA	854	DOOR
8934	PORTA DE VIDRO	8934	PUERTA DE VIDRIO	8934	GLASS DOOR

PRÉ-MONTAGEM / PRÉ-ARMADO / PRÉ-ASSEMBLAGE 1

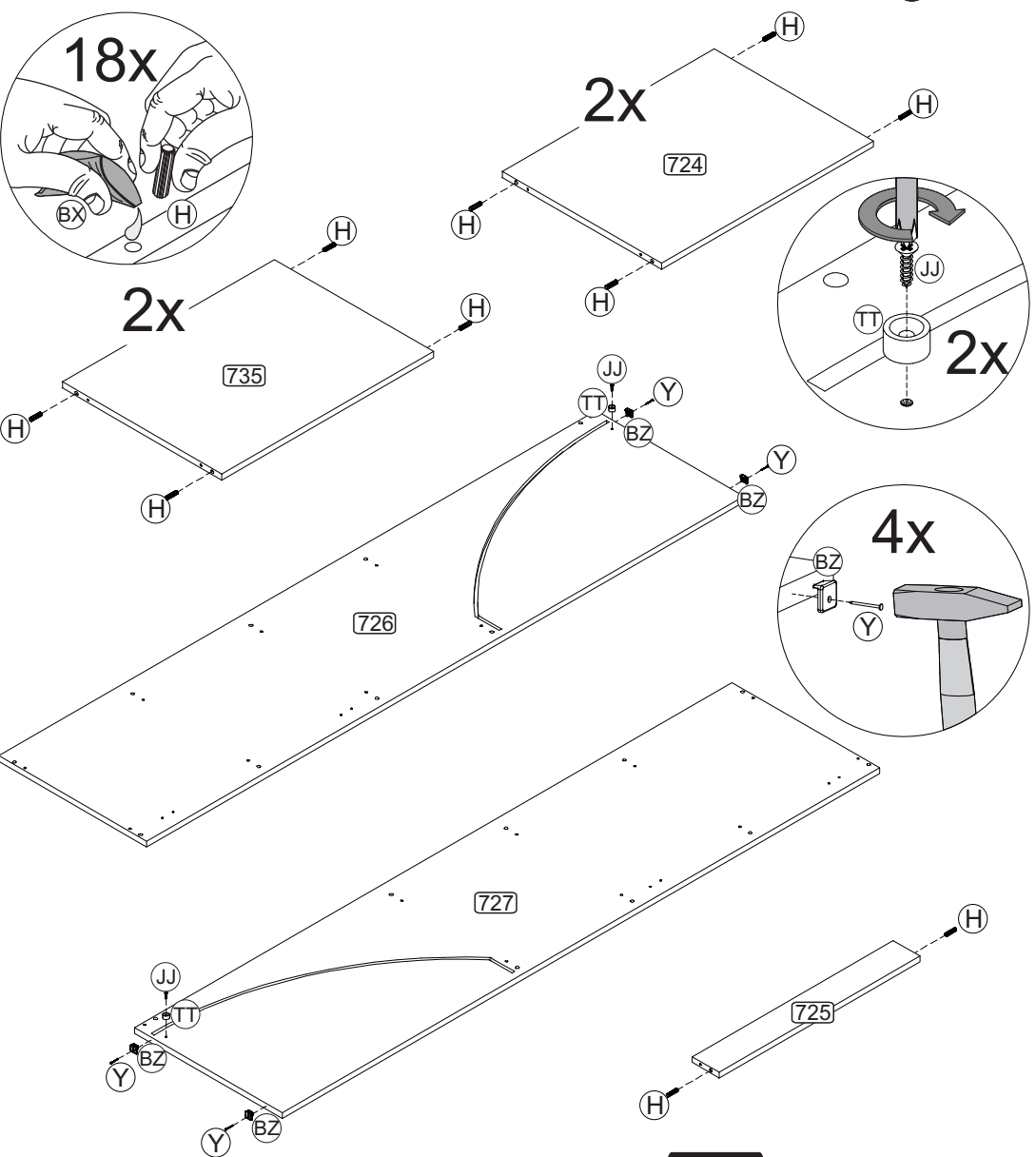

Passo
Paso
Step **07**

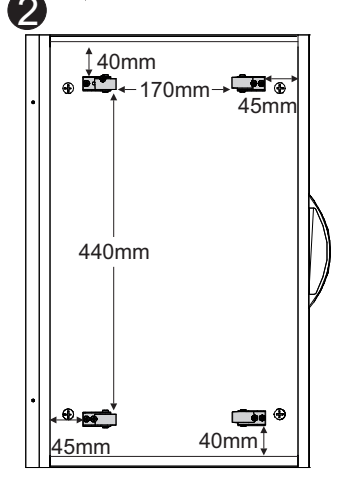

**ATENÇÃO À POSIÇÃO DOS RODÍZIOS (NA VERTICAL)
ATENCIÓN A LA POSICIÓN DE LAS RUEDAS (VERTICAL)
ATTENTION TO THE POSITION OF THE CASTERS (VERTICAL)**

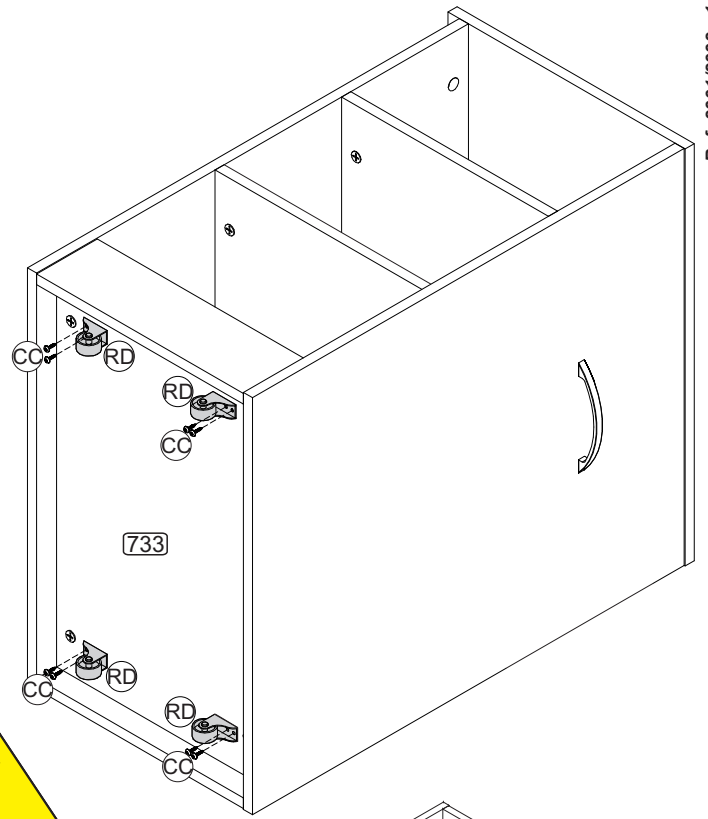

Passo
Paso
Step **08**



**FURAÇÃO CENTRAL NA MARCAÇÃO
PERFORACIÓN CENTRAL EN MARCADO
CENTRAL DRILLING IN MARKING**

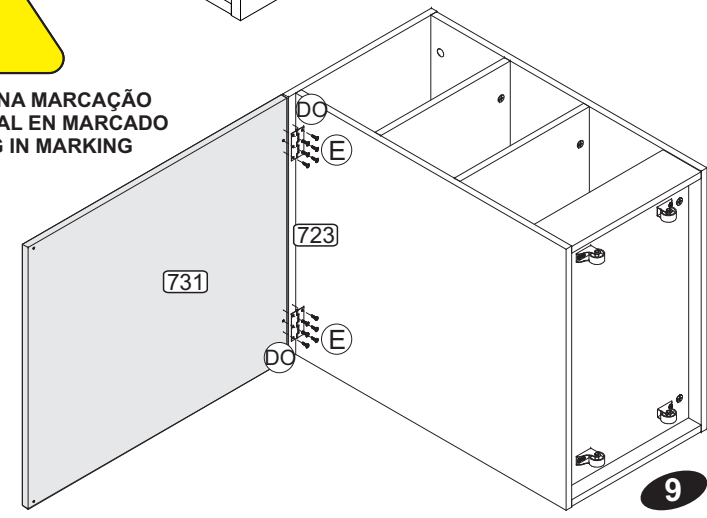
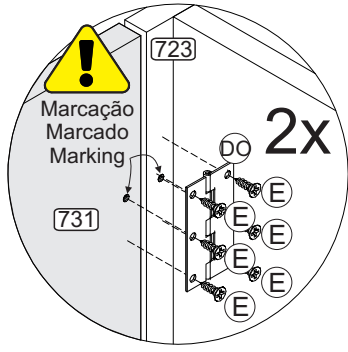
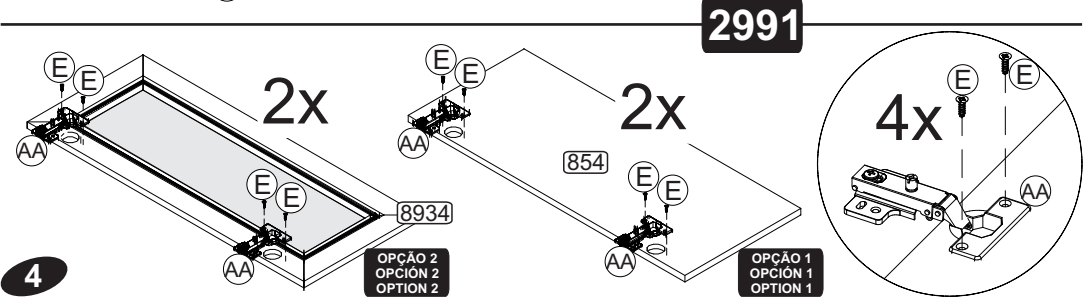

Passo
Paso
Step 05

2

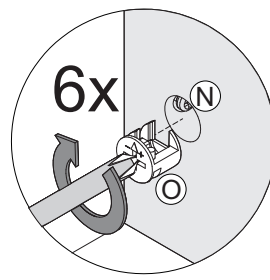
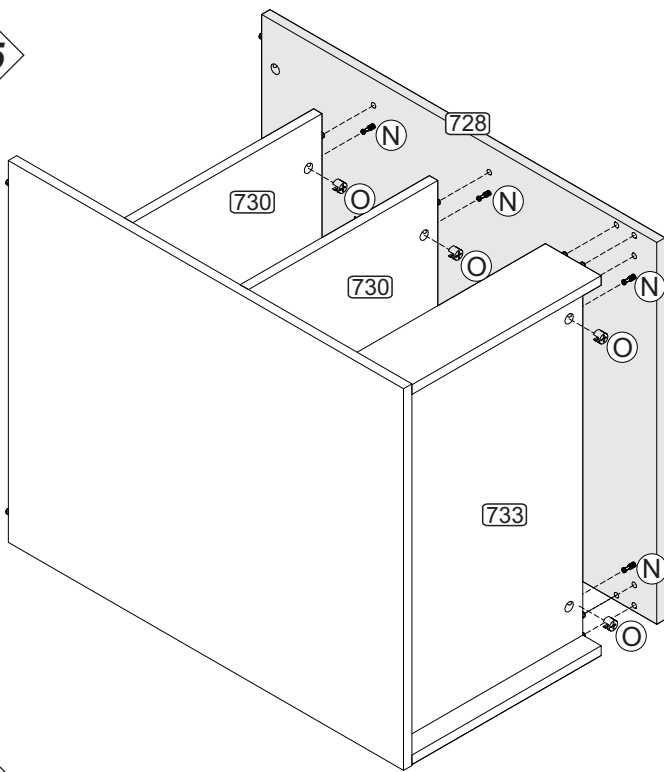

Passo
Paso
Step 06

2



DISTÂNCIA NO LADO OPOSTO DO PUXADOR
DISTANCIA EN EL LADO DE LA MANIJA
DISTANCE ON THE SIDE OF THE HANDLE

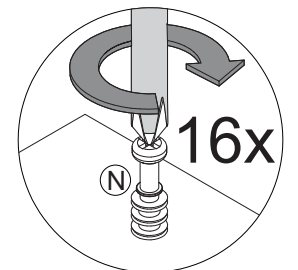
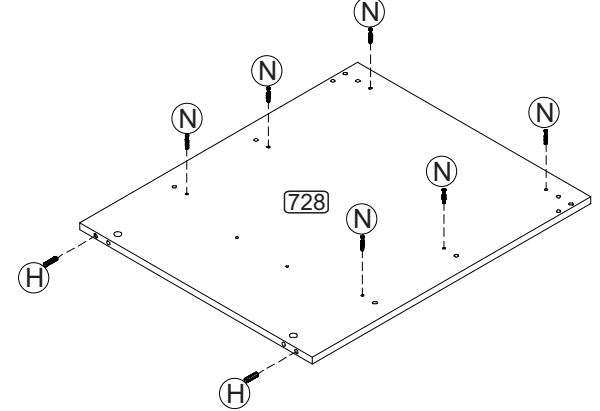
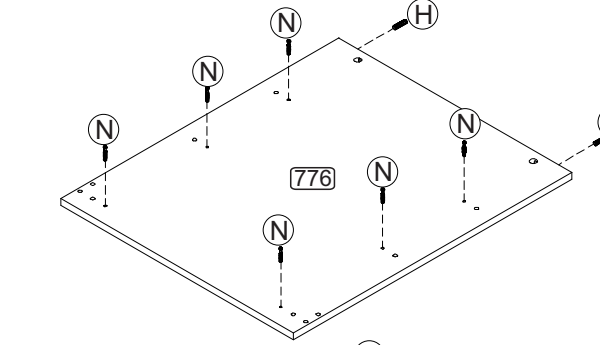
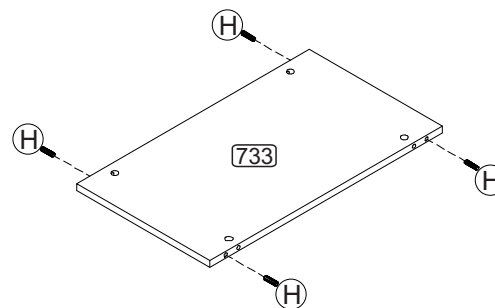
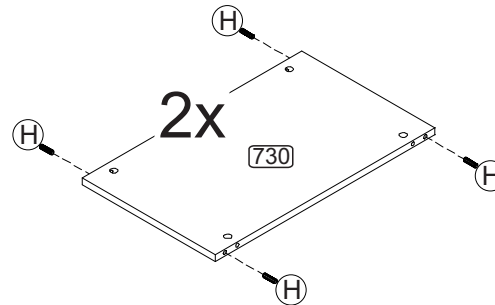
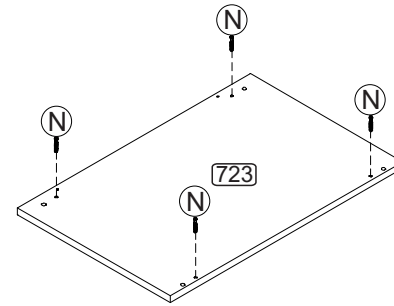
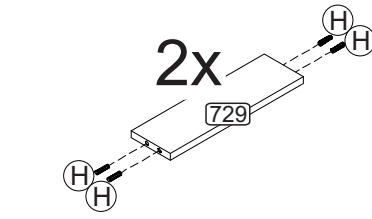
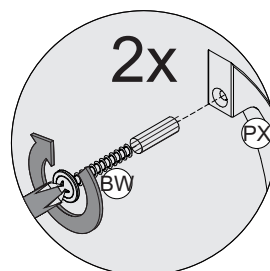
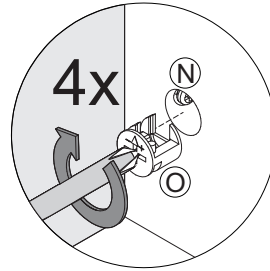
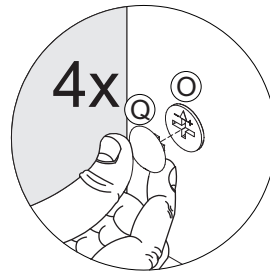
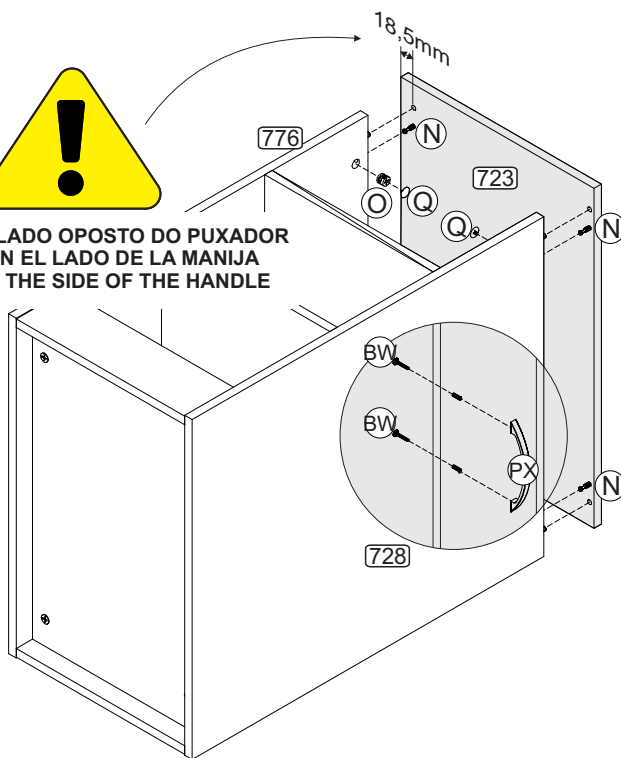

8

5

Passo
Paso
Step
01

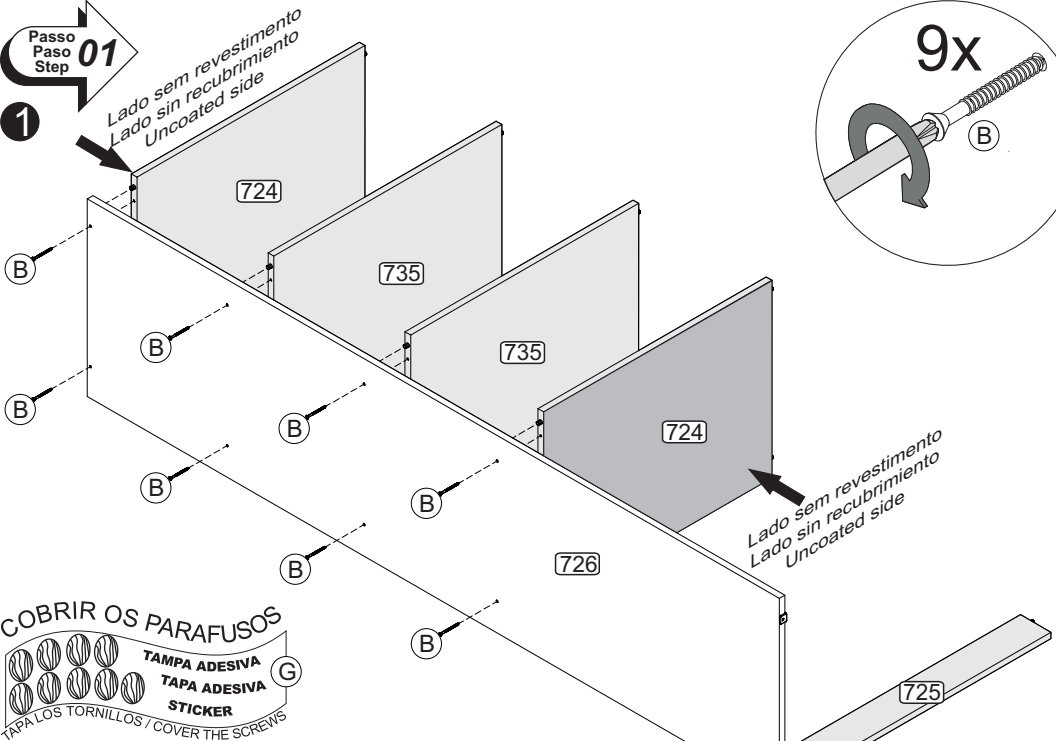

Passo
Paso
Step
02

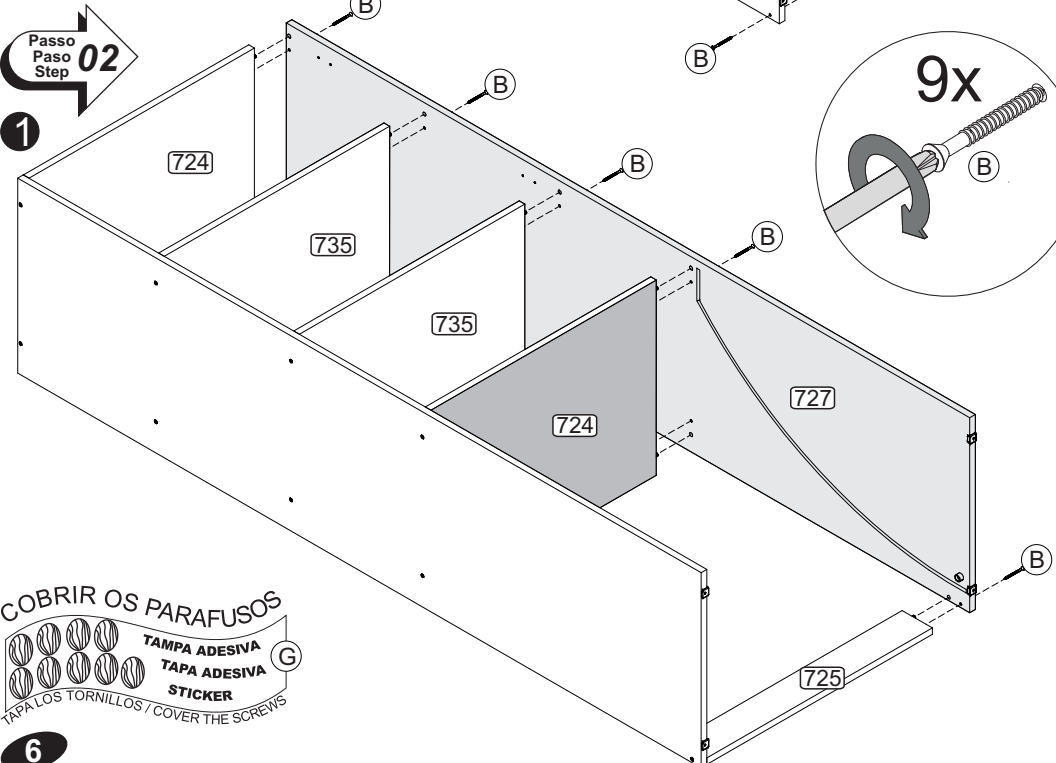

Passo
Paso
Step
03

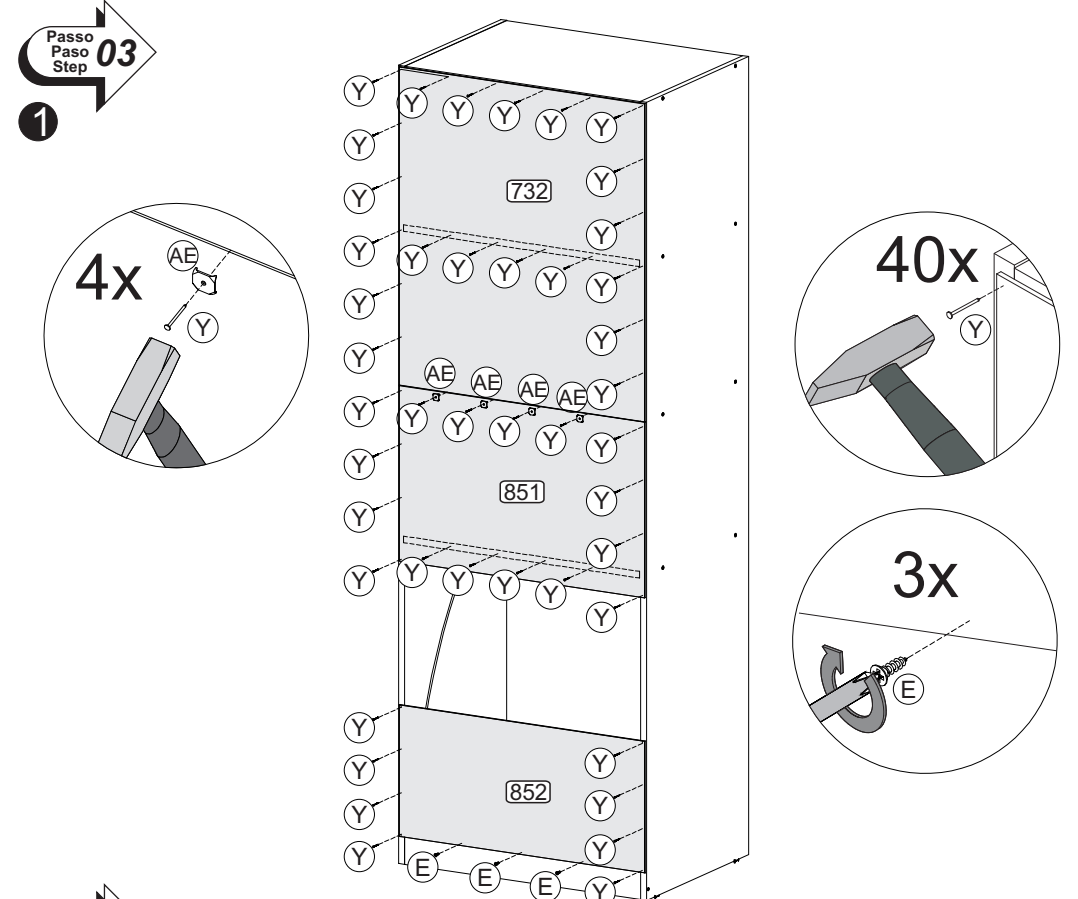

Passo
Paso
Step
04

