

**CÓDIGO DE PEÇAS | CODE OF PIECES | CÓDIGO DE PIEZAS**

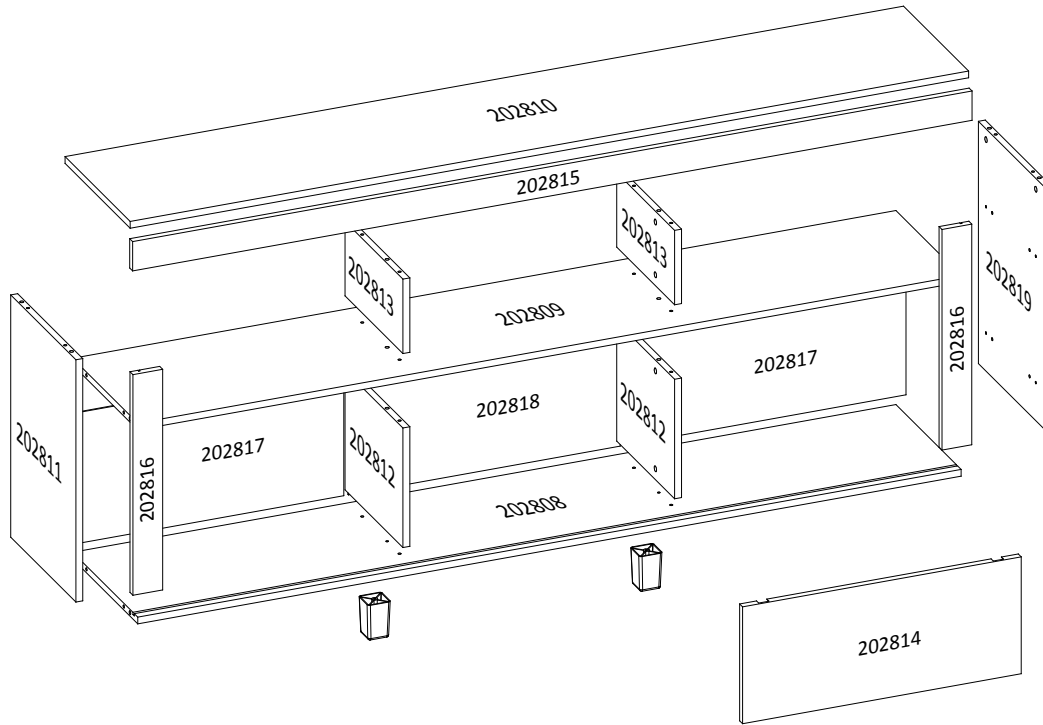

**INSTRUÇÕES | INSTRUCTIONS | INSTRUCCIONES**

- Prepare a montagem do móvel próximo ao local que ele ficará definitivamente e evite deslocá-lo depois de montado;
- Forre o chão com papelão ou similar e utilize a isomanta que vem entre as peças para evitar o contato entre elas durante a montagem;
- Monte o móvel obedecendo a ordem numérica da **sequência de montagem (S.M.)**, identificando as peças pelo **código de peça (C.P.)** carimbado na mesma, de acordo com a tabela.
- Prepare the assembly of the close piece of furniture to the place that it will be definitively and avoid to move after done. Will be definitively and avoid to move after done;
- Cover the ground with cardboard or similar and use the isomanta that it comes among the pieces to avoid the contact among them during the assembly;
- Set up the piece of furniture obeying the numeric order of the **assembly sequence (S.M.)**, identifying the pieces by **code of piece (C.P.)** stamped in the same, in agreement with the table.
- Prepare la montaje del mobiliario proximo al lugar que estará definitivamente y evite mover después de hecho;
- Tape la suelo con cartón o similar y use la "isomanta" que viene entre las piezas para evitar el contacto entre ellos durante la montaje;
- Monte el mobiliario obedeciendo el orden numérico de la **sucesión de montaje (S.M.)**, identificando las piezas por el **código de piezas (C.P.)** de la misma estampado en esta, de acuerdo con la tabla.

**ASPECTO FINAL | FINAL ASPECT**

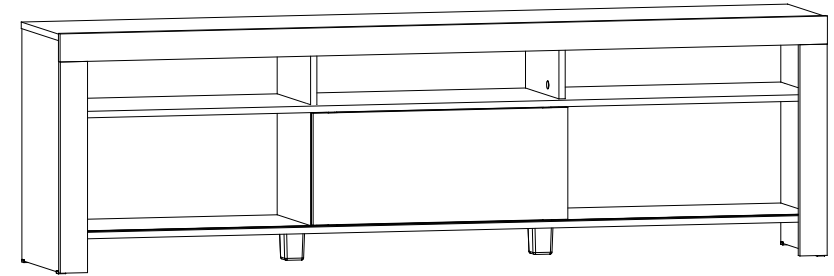

\*Dimensões em metros | *Dimensions in meters* | *Dimensiones en metros*

Espaço para Tv: → 1,830 m ⇐ 0,353 m  
Dimensão do Produto: → 1,830 m ↑ 0,555 m ⇐ 0,353 m

Edição: 14/10/2016

REF.:	PEÇAS PIECE PIEZA	MATÉRIA PRIMA	DIMENSÕES* DIMENSIONS DIMENSIONES	QUANT.
202808	Base   <i>Base</i>   <i>Base</i>	MDP	1,797 x 0,335 x 0,015	1
202809	Tampo intermediário   <i>Shelf</i>   <i>Estanteria</i>	MDP	1,797 x 0,335 x 0,015	1
202810	Tampo TV   <i>Top TV</i>   <i>Tapa TV</i>	MDP	1,830 x 0,335 x 0,015	1
202811	Lateral esquerda   <i>Left Side</i>   <i>Lado izquierdo</i>	MDP	0,537 x 0,335 x 0,015	1
202812	Divisão inferior esq/dir   <i>The lower division left/right</i>   <i>La división inferior</i>	MDP	0,298 x 0,265 x 0,015	2
202813	Divisão superior   <i>Upper Division</i>   <i>División superior</i>	MDP	0,298 x 0,165 x 0,015	2
202819	Lateral direita   <i>Right Side</i>   <i>Lado derecho</i>	MDP	0,537 x 0,335 x 0,015	2
202814	Porta deslizante   <i>Sliding door</i>   <i>Puerta corrediza</i>	MDP	0,608 x 0,259 x 0,015	2
202815	Vista do tampo   <i>View of the tabletop TV</i>   <i>Vista de la mesa TV</i>	MDP	1,832 x 0,065 x 0,015	1
202816	Vista lateral   <i>Upper left viewport</i>   <i>Viewport superior izquierda</i>	MDP	0,489 x 0,065 x 0,015	2
202817	Fundo lateral   <i>Bottom Side</i>   <i>Lado inferior</i>	MDP	0,614 x 0,290 x 0,003	1
202818	Fundo lateral   <i>Bottom Side</i>   <i>Lado inferior</i>	MDP	0,593 x 0,290 x 0,003	1

**ACESSÓRIOS | ACCESSORIES | ACESORIOS**

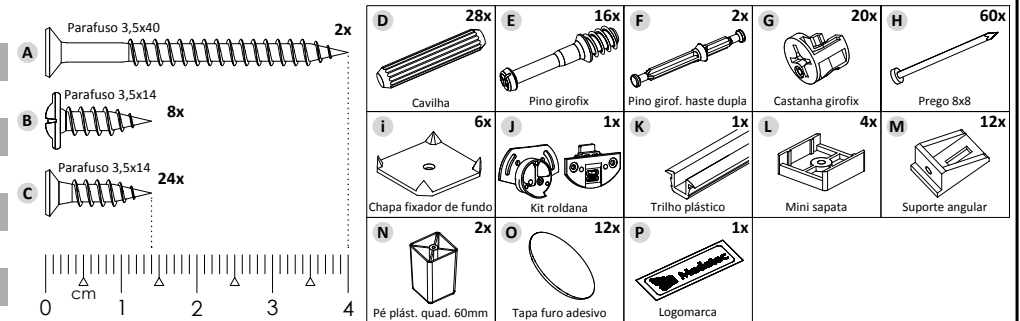

**CUIDADOS ESPECIAIS | SPECIAL CARES | CUIDADOS ESPECIALES:**

- LIMPEZA:** Pano limpo umedecido em água e sabão neutro - **BRILHO:** Flanela seca  
**CLEANING:** Clean cloth humidified in water and neutral soap - **SHINE:** Dry flannel  
**LIMPIEZA:** Tela limpia humedecida en la agua y el jabón neutro - **BRILLO:** Franela seca

1º PASSO | PASS | PASO

PEÇAS  
PIECES  
PIEZAS

S.M.	C.P.
01	202808
02	202812
03	202812
04	202809
05	202813
06	202813

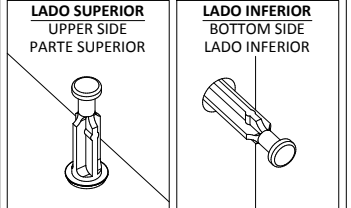
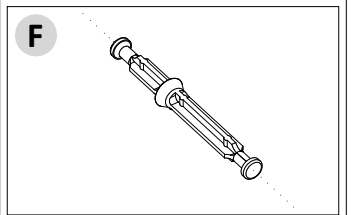
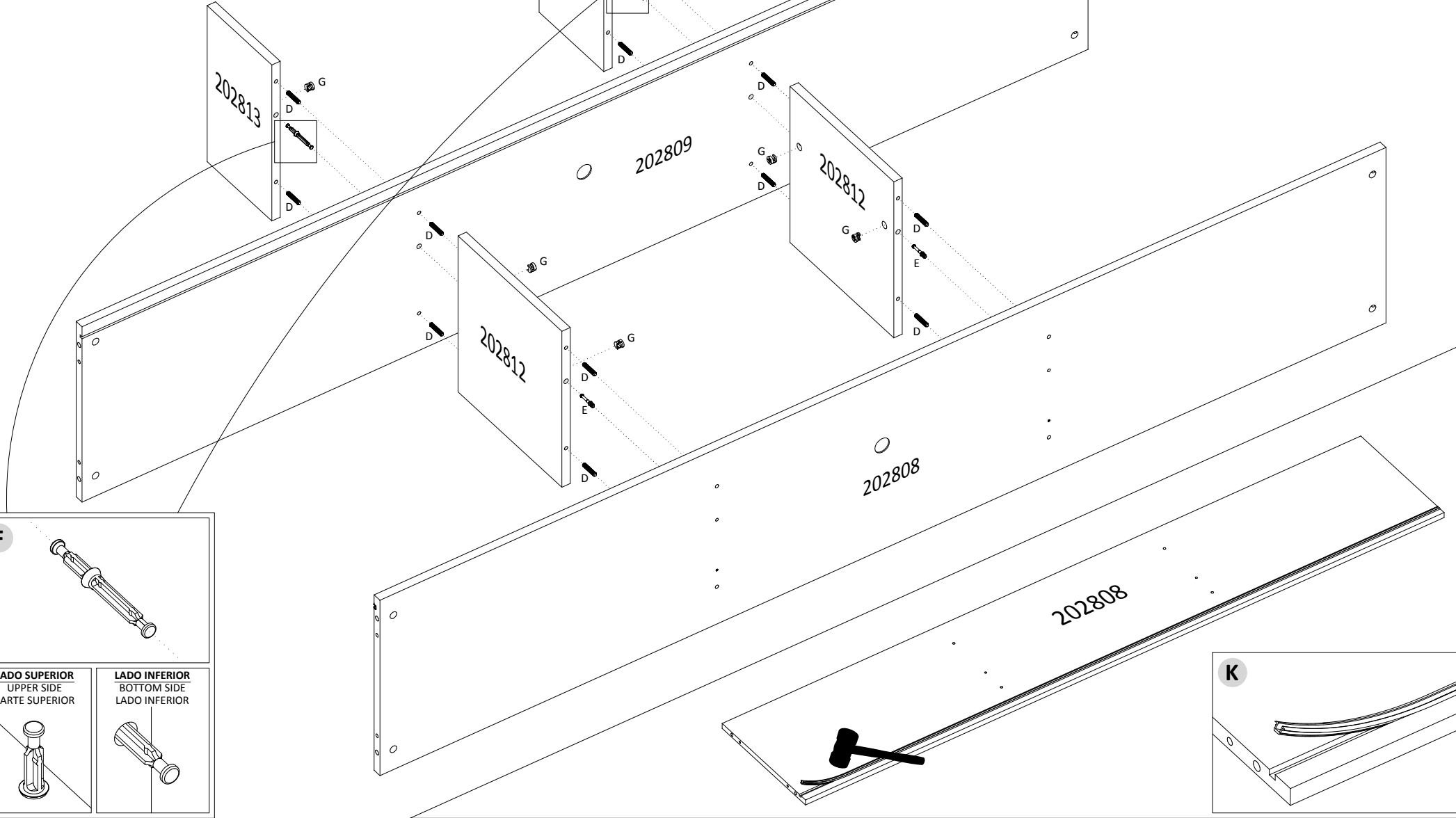
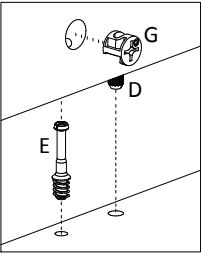

LADO SUPERIOR  
UPPER SIDE  
PARTE SUPERIOR

LADO INFERIOR  
BOTTOM SIDE  
LADO INFERIOR

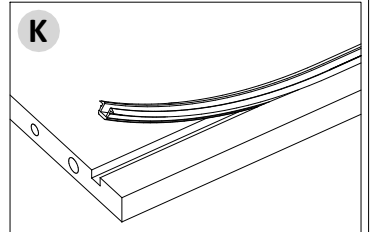

K

**2º PASSO** | PASS | PASO

PEÇAS  
PIECES  
PIEZAS

S.M.	C.P.
01	202819

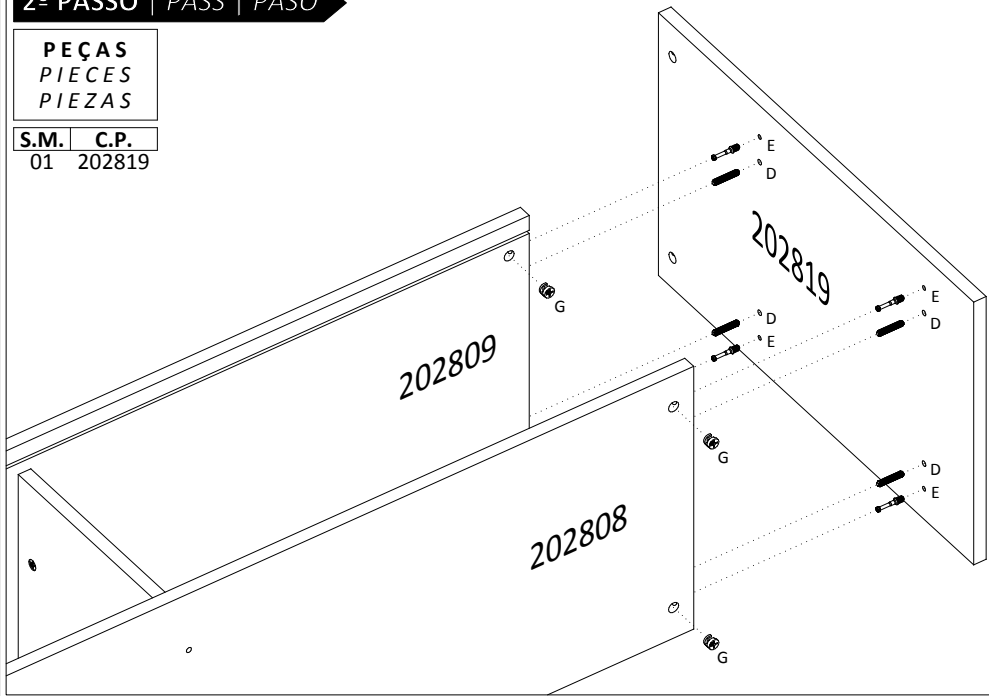

**3º PASSO** | PASS | PASO

PEÇAS  
PIECES  
PIEZAS

S.M.	C.P.
01	202811

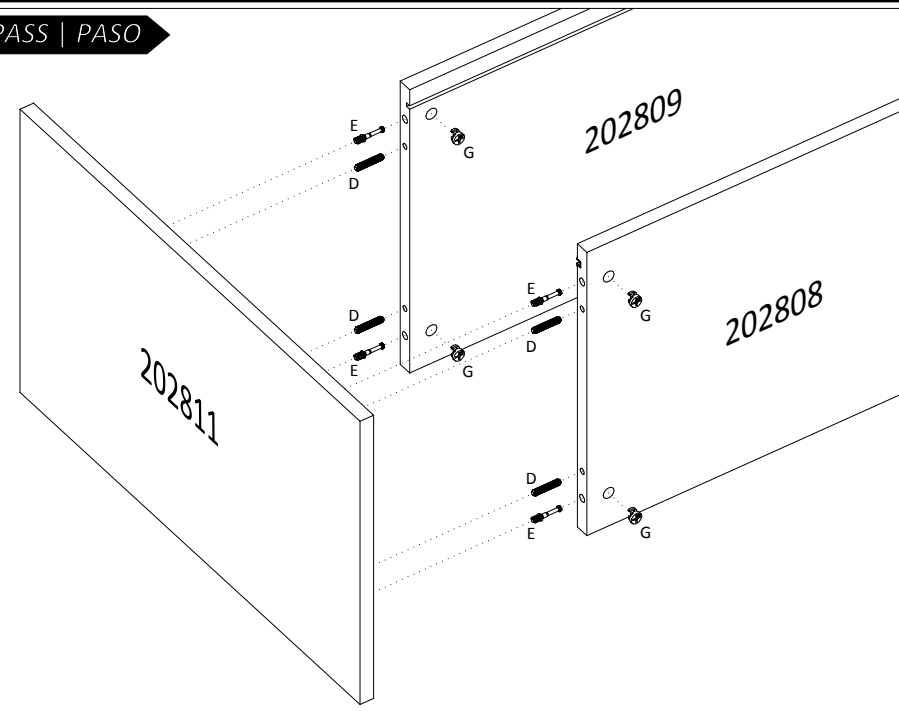

**4º PASSO** | PASS | PASO

PEÇAS  
PIECES  
PIEZAS

S.M.	C.P.
01	202810

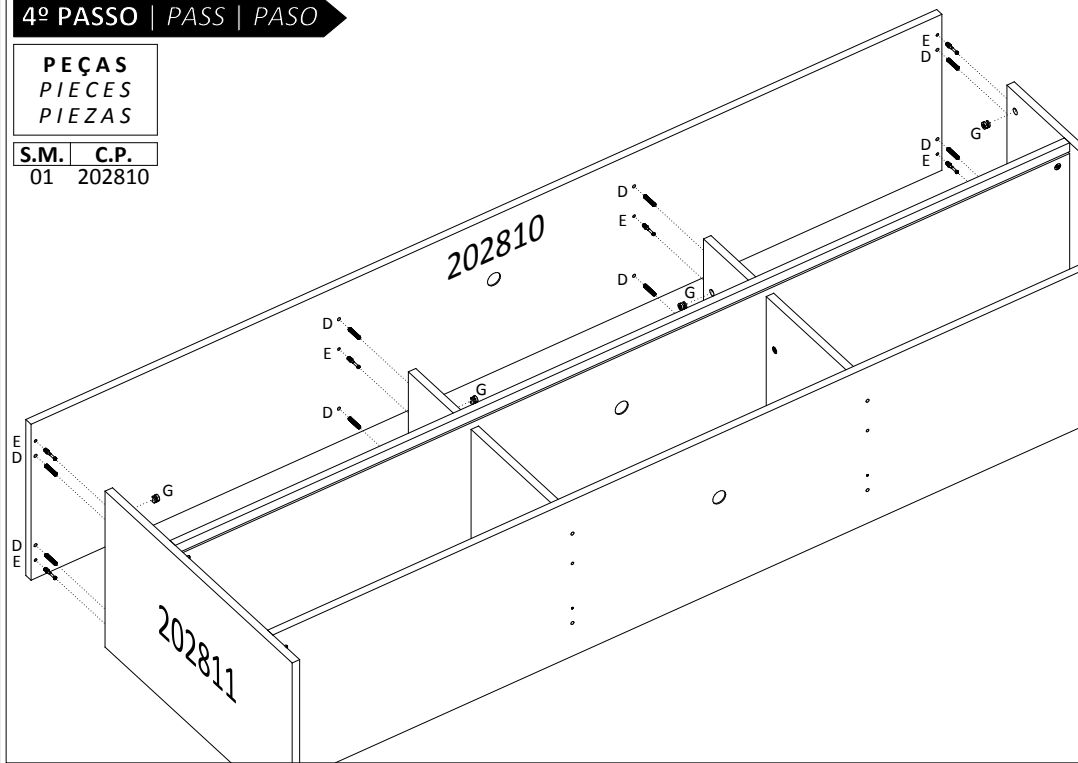

**5º PASSO** | PASS | PASO

PEÇAS  
PIECES  
PIEZAS

S.M.	C.P.
01	202815
02	202816
03	202816

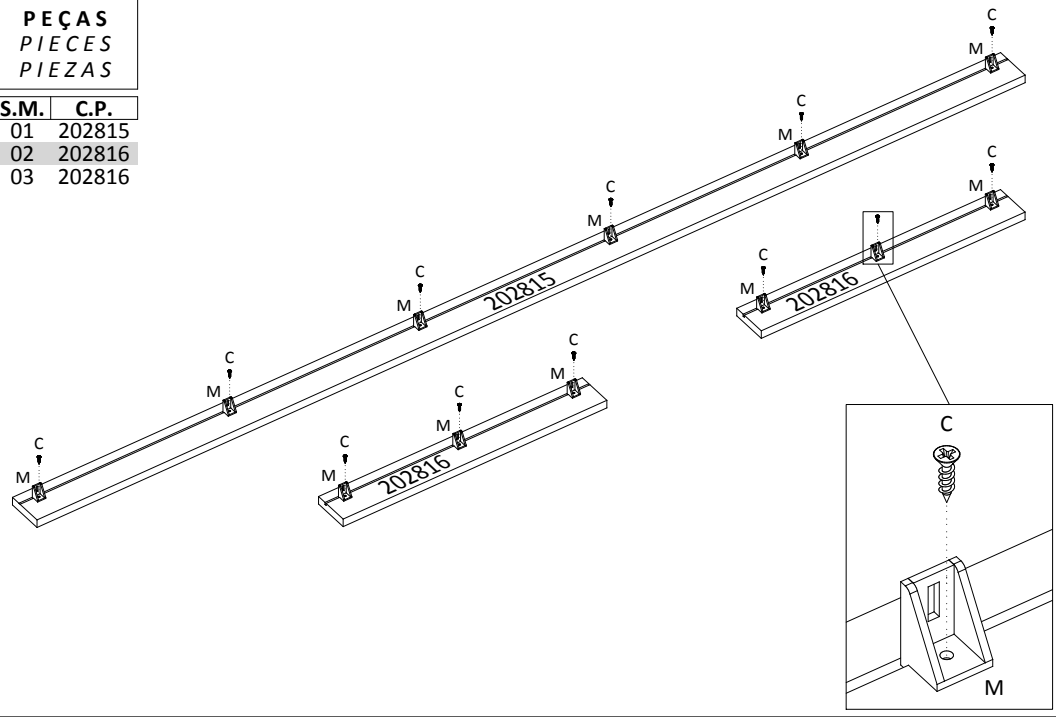

6º PASSO | PASS | PASO

PEÇAS  
PIECES  
PIEZAS

S.M.	C.P.
01	202815
02	202816
03	202816

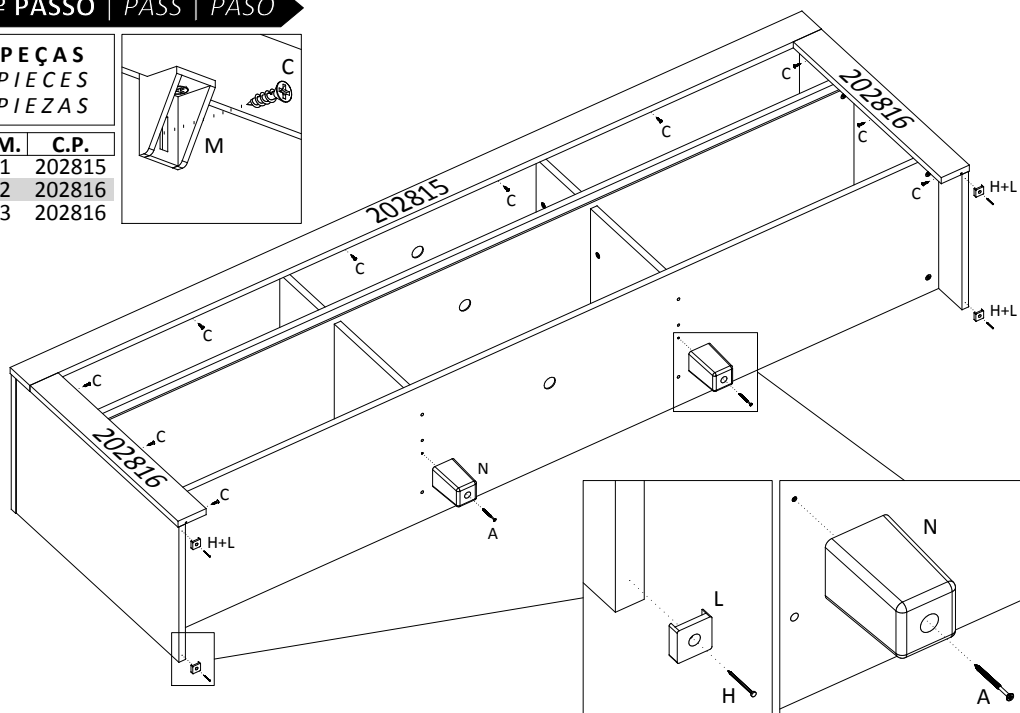
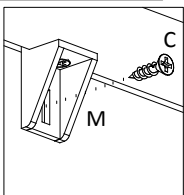

7º PASSO | PASS | PASO

PEÇAS  
PIECES  
PIEZAS

S.M.	C.P.
01	202818
02	202817
03	202817

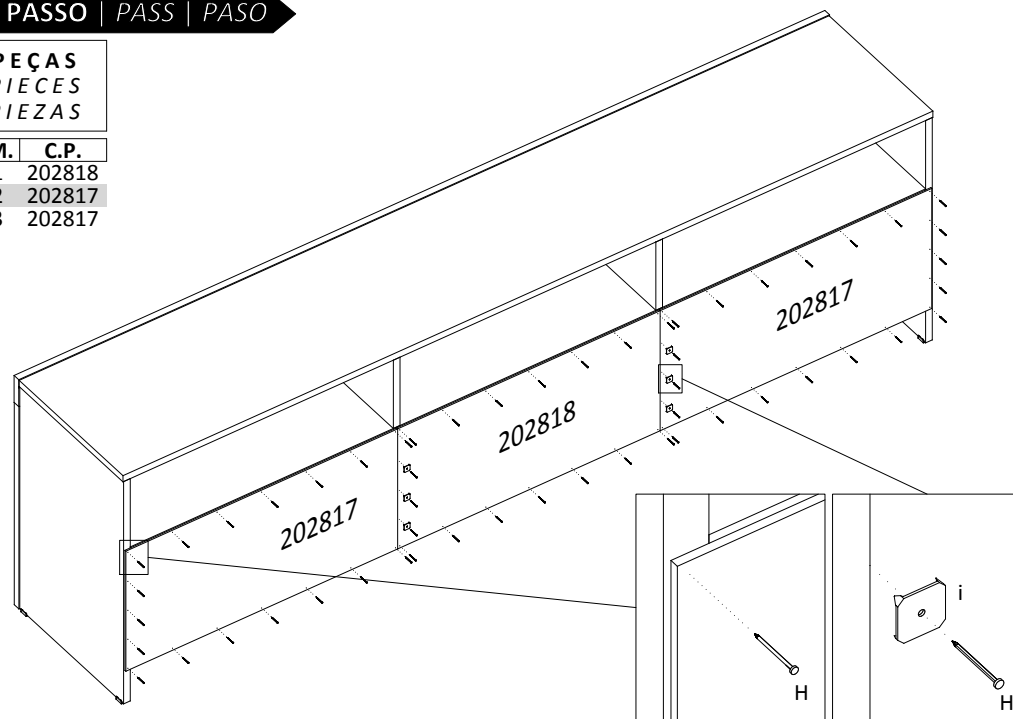

8º PASSO | PASS | PASO

PEÇAS  
PIECES  
PIEZAS

S.M.	C.P.
01	202814

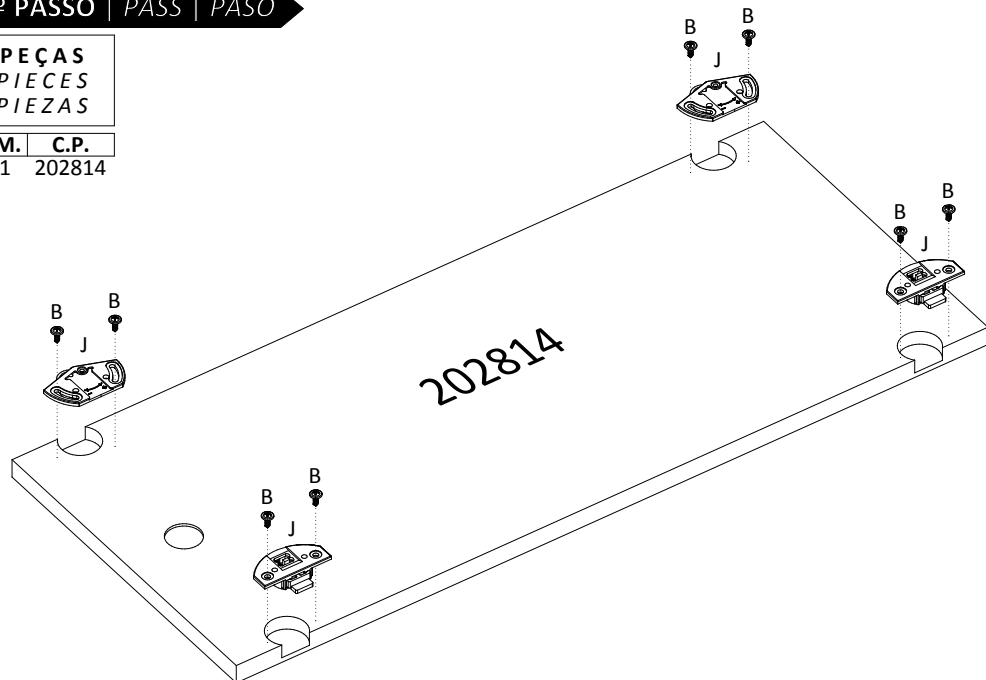

9º PASSO | PASS | PASO

