

**1°**

Colocar a cortina no suporte  
Put the curtain the support  
Ponga la cortina el apoyo

**2°**

Fixar na parte superior respeitando as medidas  
*130 mm do vazado*  
Set at the top of respecting the distances  
*130 mm cast*  
Establecer en la parte superior de  
respetar las distancias  
*130 mm fundido*

**3°**

Fixar na parte inferior esticando a cortina  
Fix the bottom of stretching the curtain  
Fijar la parte inferior de la  
cortina de estiramiento

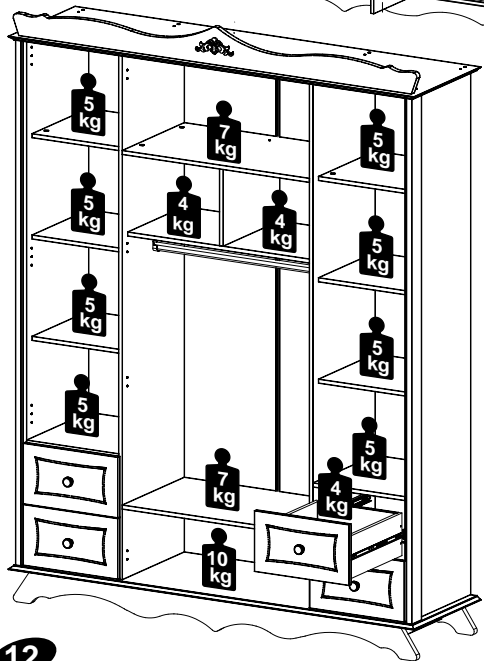
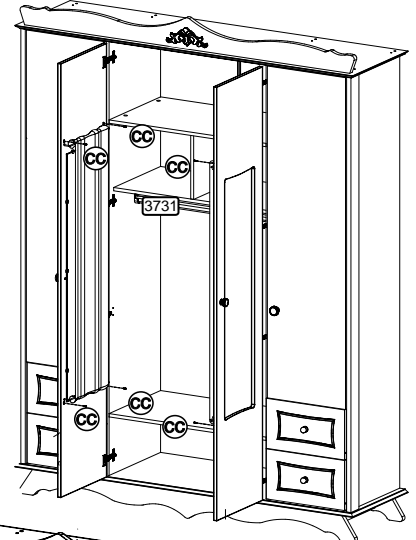

Peso distribuido  
de maneira  
uniforme

Peso distribuido  
de maneira  
uniforme

Distributed  
weight so  
uniform



**MULTIMÓVEIS**  
*baby*

Rua Carlos Dreher Neto, 1918, Fone: (54) 2102 4000, FAX: (54) 2102 4050  
CEP 95700-000 - BENTO GONÇALVES - RS - BRASIL  
CNPJ: 00.349.443/0001-92  
e-mail: multimoveis@multimoveis.com / site: www.multimoveis.com

**INSTRUÇÕES DE MONTAGEM  
INSTRUCCIONES DE ARMADO  
ASSEMBLY INSTRUCTIONS**

**REF.: 2347**

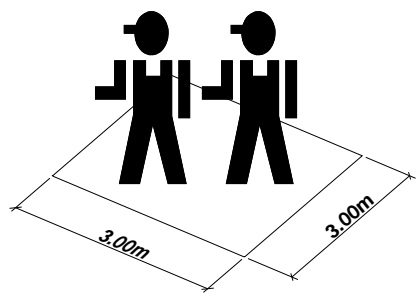
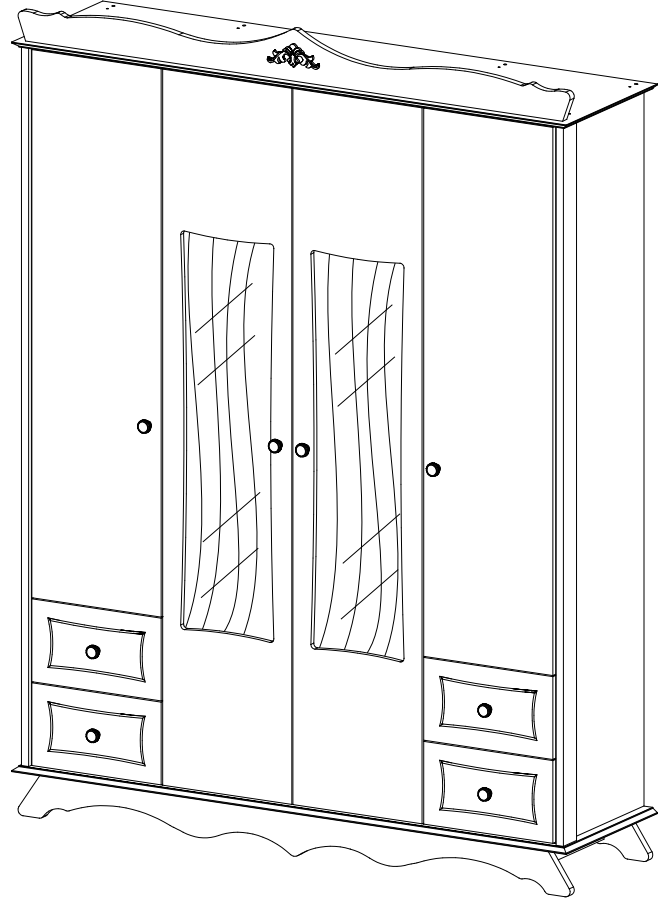

**FERRAMENTAS NECESSÁRIAS  
HERRAMIENTAS NECESARIAS  
TOOLS NECESSARY**

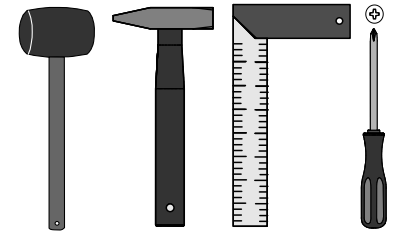

# LISTA DE FERRAGENS / LISTA DE MATERIALES / HARDWARE LIST

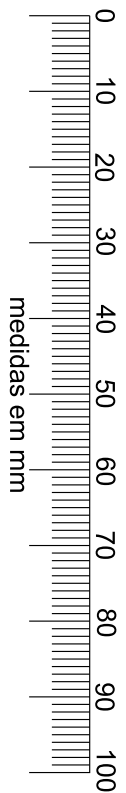

Utilizar a régua abaixo para medir as ferragens:

B		4,5 x 50	35
D		4,0 x 35	16
E		3,5 x 14	128
H		8,0 x 30	68
J		8,0 x 50	04
K			20
L		6,0 x 30	16
N			22
O			30
P			22
V			04
Y		10 x 10	140
W			02
AA			14
AE			34
AP		Aplique	01
AT			07
BA		4,0 x 25	08
BX		COLA	02
BY			06
BW		4,0 X 25	08
CC		3,5 X 12	22
ED		Tampa Adesiva Papel	13
GA		Gabarito	01
GO		Corrediça Telescópica	04
HU		Fita dupla face 40mm	01
HV		Fita dupla face 20mm	02
PU			08

Passo  
Paso  
Step  
**09**

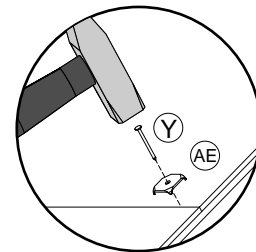
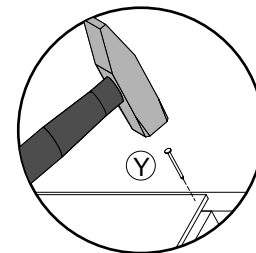
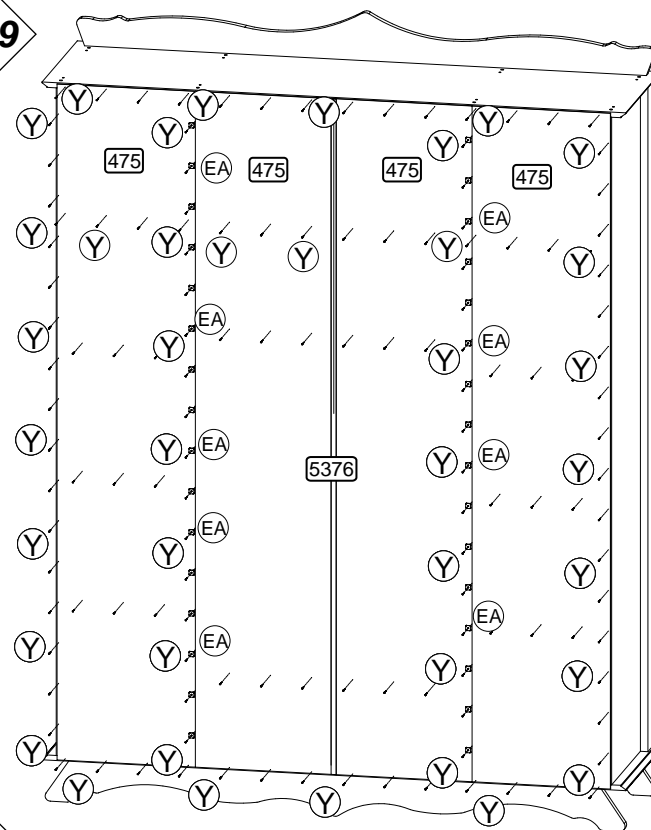

Passo  
Paso  
Step  
**10**

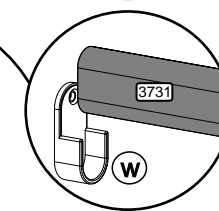
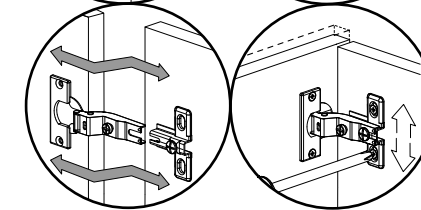
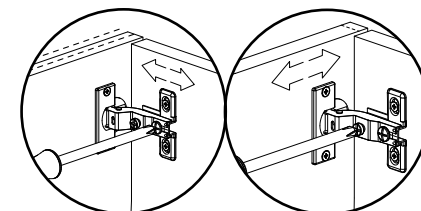
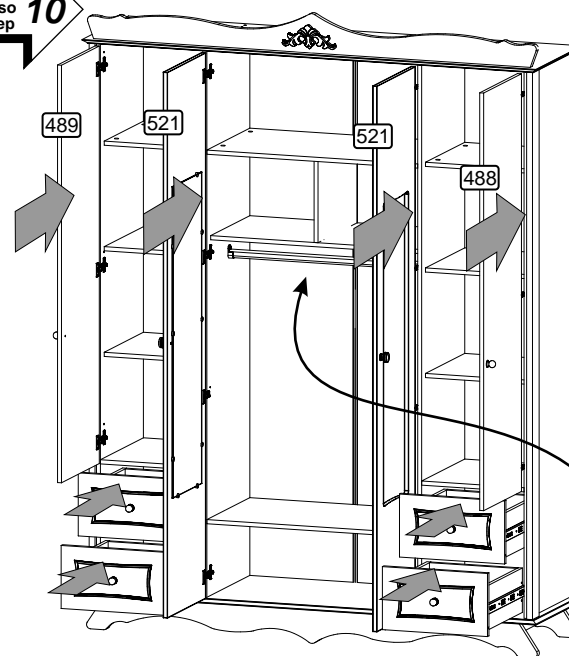

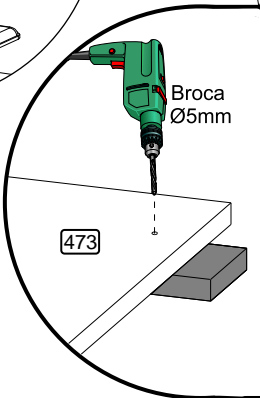
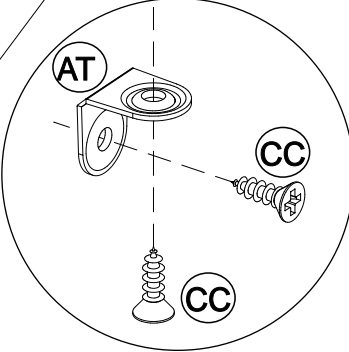
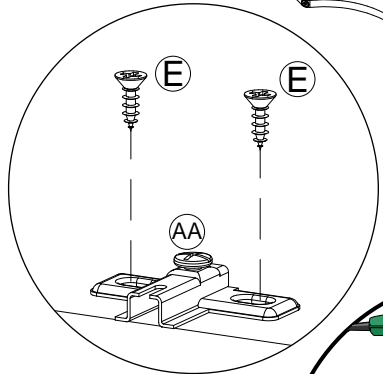
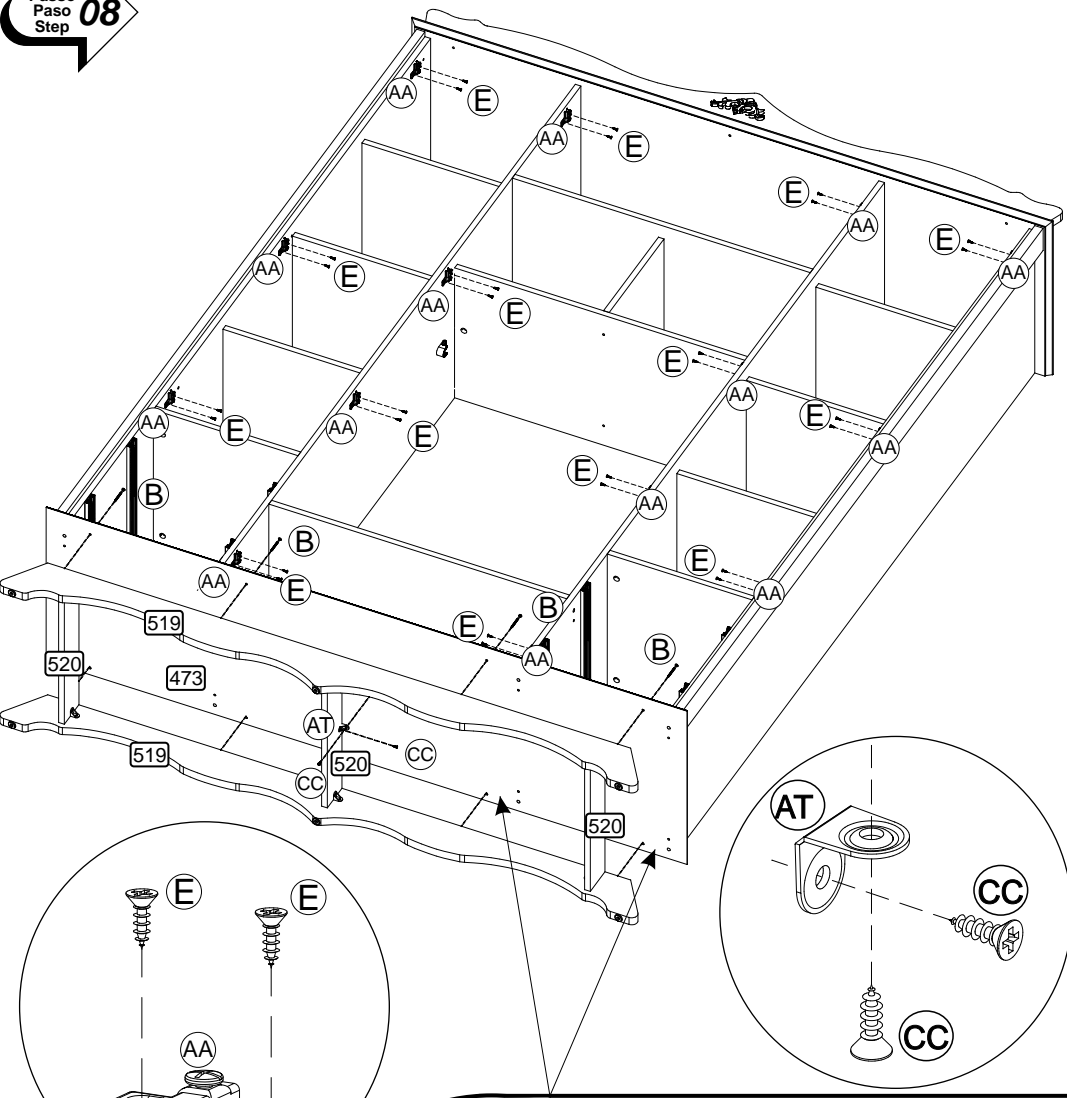

Utilizar calço para fazer a furação da peça **473**

Use shim to make drilling part **473**

Utilice cuña para hacer la perforación parte **473**

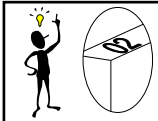

Senhor montador!  
Informamos que a numeração das peças encontra-se no topo das mesmas conforme desenho acima.

Señor Armador!  
Les informamos que la numeración de las piezas encuentranse arriba de las mismas, de acuerdo al modelo arriba.

Dear Assembler!  
We inform you that the number of each piece is located on the top of it, according to the model shown above.

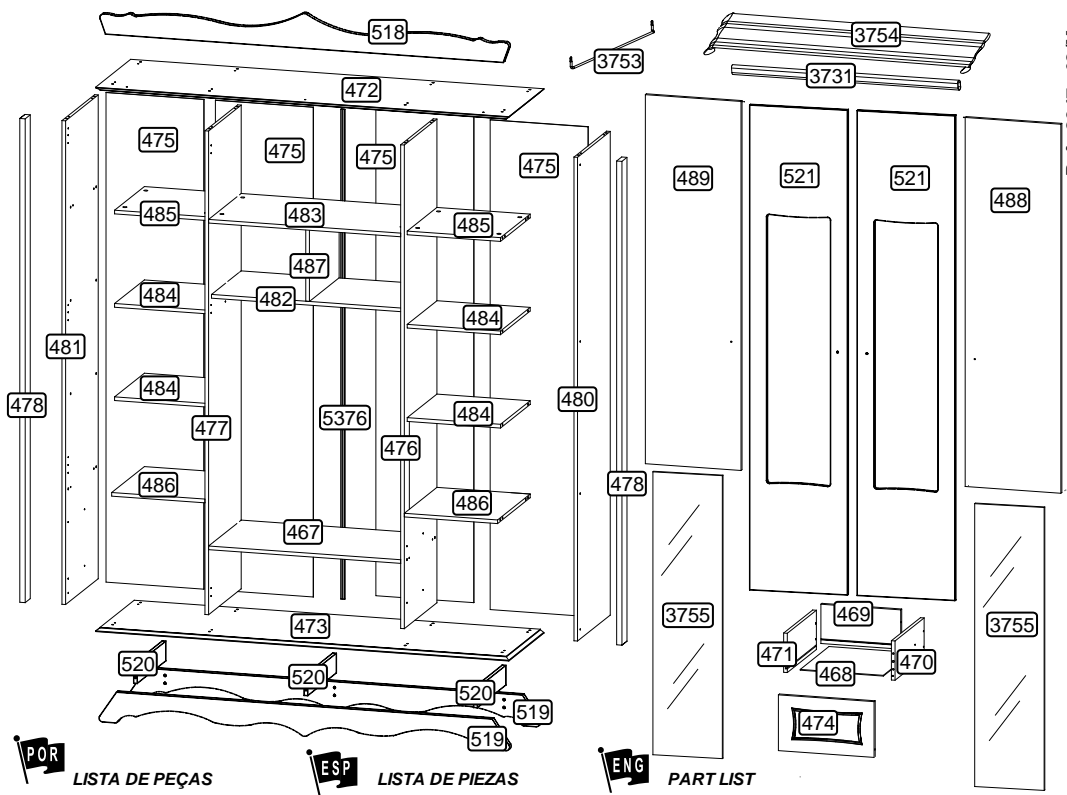

**POR** LISTA DE PEÇAS

- | N°   | DESCRIPTION                 |
|------|-----------------------------|
| 467  | PRATELEIRA INFERIOR MAIOR   |
| 468  | FUNDO DE GAVETA             |
| 469  | COSTA DE GAVETA             |
| 470  | LATERAL GAVETA DIREITA      |
| 471  | LATERAL GAVETA ESQUERDA     |
| 472  | TAMPO                       |
| 473  | BASE                        |
| 474  | FRENTE DE GAVETA            |
| 475  | COSTA                       |
| 476  | DIVISÃO DIREITA             |
| 477  | DIVISÃO ESQUERDA            |
| 478  | MOLDURA LATERAL             |
| 480  | LATERAL DIREITA             |
| 481  | LATERAL ESQUERDA            |
| 482  | PRATELEIRA CENTRAL          |
| 483  | PRATELEIRA CENTRAL SUPERIOR |
| 484  | PRATELEIRA CAVILHA          |
| 485  | PRATELEIRA                  |
| 486  | TAMPO GAVETA                |
| 487  | DIVISÃO MENOR               |
| 488  | PORTA DIREITA               |
| 489  | PORTA ESQUERDA              |
| 521  | PORTA RISCADA               |
| 518  | MOLDURA SUPERIOR            |
| 519  | RODAPÉ                      |
| 520  | RODAPÉ MENOR                |
| 3731 | CABIDEIRO                   |
| 5376 | PERFIL I                    |
| 3755 | VIDRO                       |
| 3754 | CORTINA                     |
| 3753 | SUPORTE                     |

**ESP** LISTA DE PIEZAS

- | N°   | DESCRIPTION              |
|------|--------------------------|
| 467  | ESTANTE MAYOR INFERIOR   |
| 468  | FONDO CAJÓN              |
| 469  | RESPALDO CAJÓN           |
| 470  | LATERAL CAJÓN DERECHA    |
| 471  | LATERAL CAJÓN IZQUIERDA  |
| 472  | TAPA                     |
| 473  | BASE                     |
| 474  | FRENTE CAJÓN             |
| 475  | RESPALDO                 |
| 476  | DIVISIÓN DERECHA         |
| 477  | DIVISIÓN IZQUIERDA       |
| 478  | MOLDURA LATERAL          |
| 480  | LATERAL DERECHA          |
| 481  | LATERAL IZQUIERDA        |
| 482  | ESTANTE CENTRAL          |
| 483  | ESTANTE CENTRAL SUPERIOR |
| 484  | ESTANTE TARUGO           |
| 485  | ESTANTE                  |
| 486  | TAPA CAJÓN               |
| 487  | DIVISIÓN MENOR           |
| 488  | PUERTA DERECHA           |
| 489  | PUERTA IZQUIERDA         |
| 521  | PUERTA RASGUÑADA         |
| 518  | MOLDURA SUPERIOR         |
| 519  | ZÓCALO                   |
| 520  | ZÓCALO MENOR             |
| 3731 | PERCHA                   |
| 5376 | PERFIL I                 |
| 3755 | VIDRIO                   |
| 3754 | CURTINA                  |
| 3753 | APOYO                    |

**ENG** PART LIST

- | N°   | DESCRIPTION            |
|------|------------------------|
| 467  | LARGER LOWER SHELF     |
| 468  | BOTTOM DRAWER          |
| 469  | DRAWER BACK            |
| 470  | RIGHT DRAWER SIDE      |
| 471  | LEFT DRAWER SIDE       |
| 472  | TOP                    |
| 473  | BASE                   |
| 474  | FRONT DRAWER           |
| 475  | BACK                   |
| 476  | RIGHT DIVISION         |
| 477  | LEFT DIVISION          |
| 478  | SIDE FRAME             |
| 480  | RIGHT SIDE             |
| 481  | LEFT SIDE              |
| 482  | CENTRAL SHELF          |
| 483  | UPPER CENTRAL SHELF    |
| 484  | BOLT SHELF             |
| 485  | SHELF                  |
| 486  | DRAWER TOP             |
| 487  | SMALLER DIVISION       |
| 488  | RIGHT DOOR             |
| 489  | LEFT DOOR              |
| 521  | DOOR SCRATCHED         |
| 518  | UPPER FRAME            |
| 519  | SKIRTING BOARD         |
| 520  | SMALLER SKIRTING BOARD |
| 3731 | HANGER                 |
| 5376 | I PROFILE              |
| 3755 | GLASS                  |
| 3754 | CURTAIN                |
| 3753 | SUPPORT                |

COBRIR OS PARAFUSOS

TAMPA ADESIVA  
TAPA ADESIVA  
STICKER

TAPA LOS TORNILLOS / COVER THE SCREWS

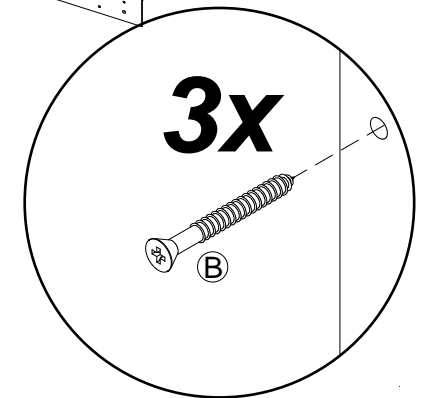
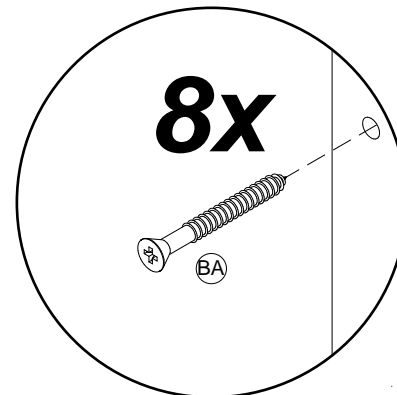
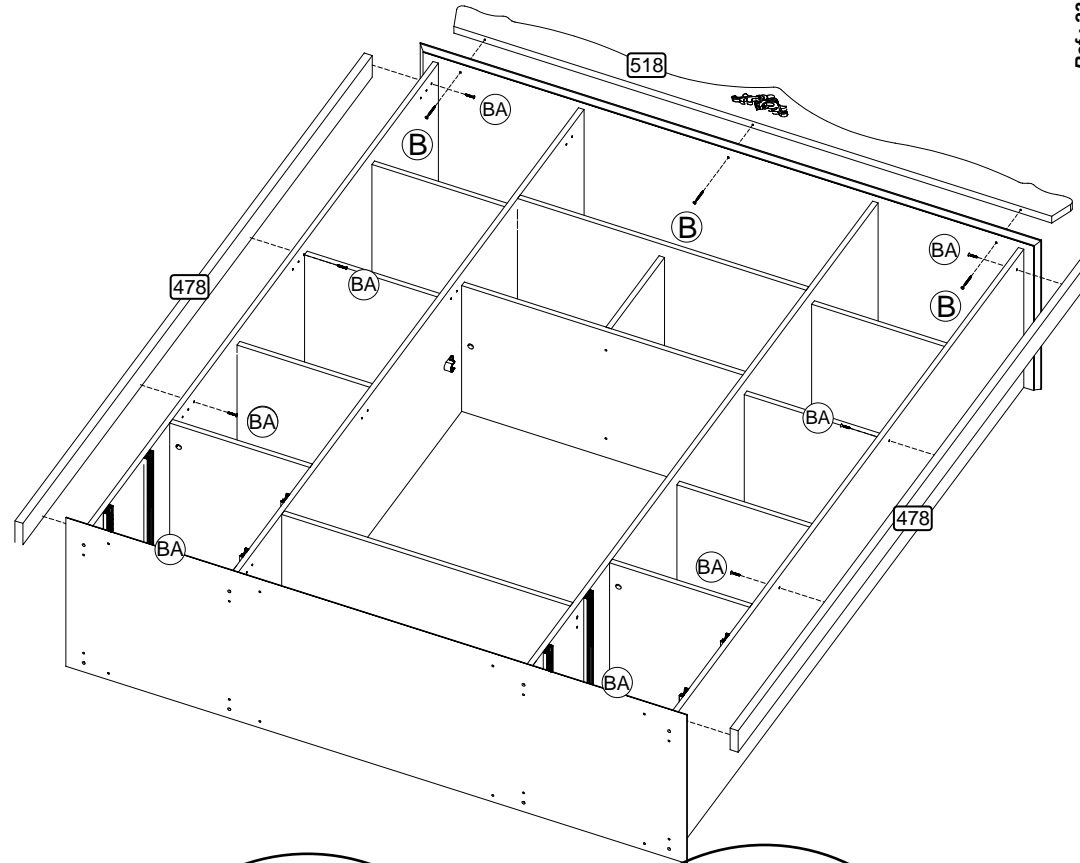
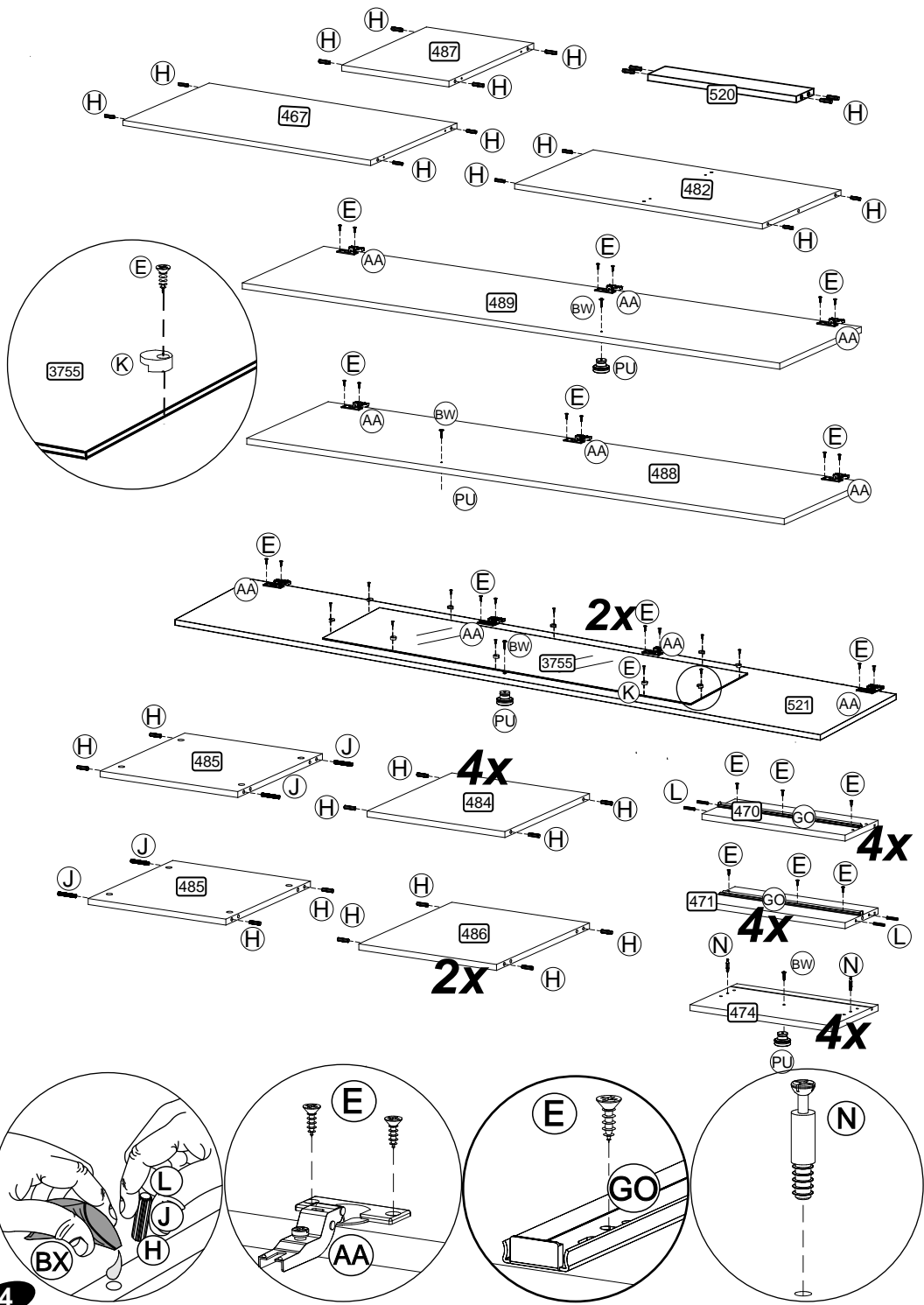

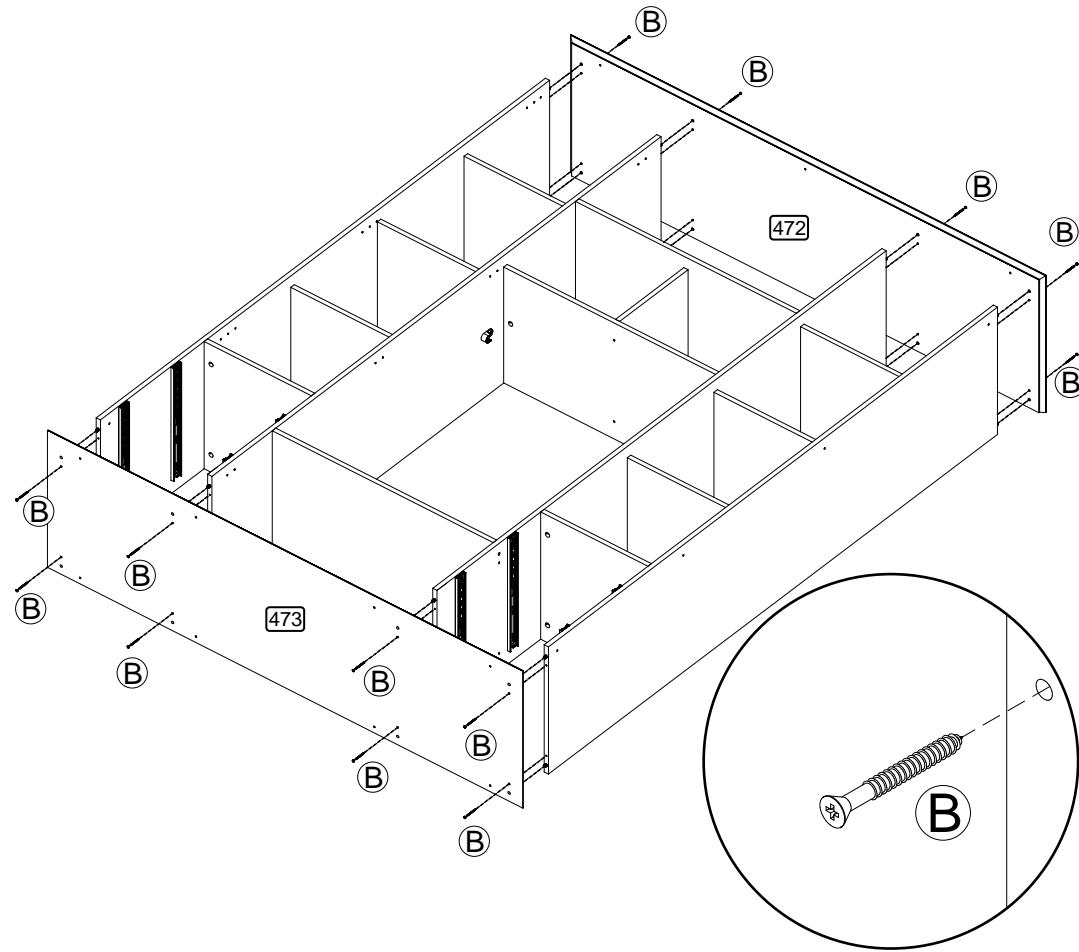

**PRÉ-MONTAGEM / PRÉ-ARMADO / PRÉ-ASSEMBLAGE**

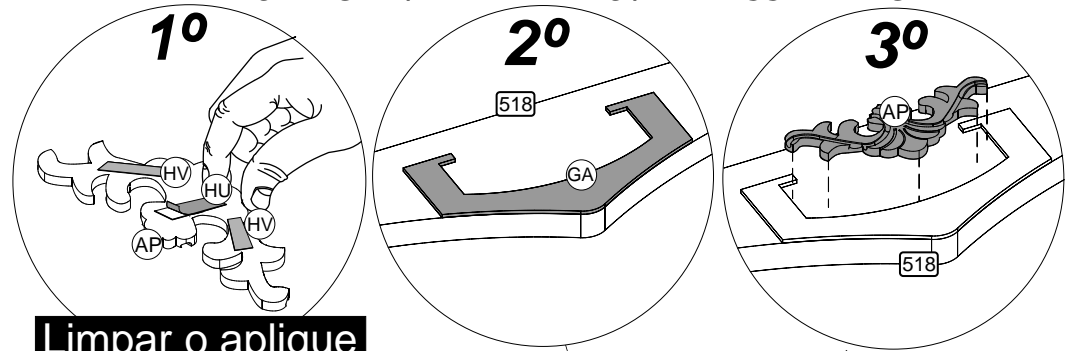

**Limpar o aplico  
Clean the apply  
Limpie el aplicar**

