

Los pies se venden por separado. Ver el montaje en la última página.  
 Feet sold separately. See assembly on the last page.  
 Pés vendidos separadamente. Veja montagem na última página.

## ACESSORIOS / HARDWARE / ACESSÓRIOS



A 6 un.



B 20 un.



C 32 un.



D Ø6,0 x 30 33 un.



E Ø6,0 x 50 04 un.

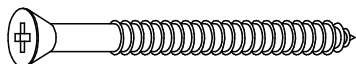

F Ø 4 x 50 56 un.

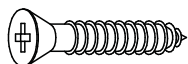

G Ø 4,0 x 25 10 un.



H Ø3,5 x 20 4 un.



I 14 un.



J Ø4,0 x 14 243 un.



K Ø4,0 x 14 48 un.

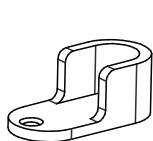

L 04 un.



M 03 un.



N 03 un.



O 1 un.



P 08 un.

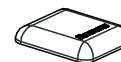

Q 08 un.

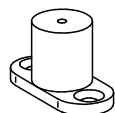

R 08 un.

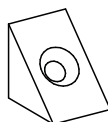

S 4 un.

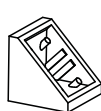

T 24 un.

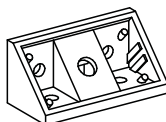

U 19 un.



V 10 x 10 ANELADO 60 un.

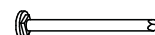

X 11 x 11 180 un.



Z 30 un.



A1 36 un.



B1 64 un.

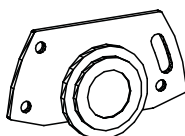

C1 08 un.

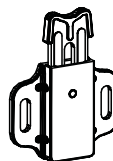

D1 08 un.



E1 Ø3,5 x 22 12 un.

FERRAMIENTAS  
 HARDWARE  
 FERRAMENTAS

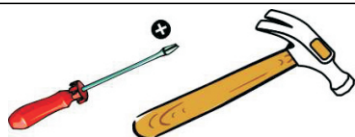

PERSONAS NECESARIAS PARA EL MONTAJE  
 PEOPLE REQUIRED FOR ASSEMBLY  
 PESSOAS NECESSÁRIAS PARA A MONTAGEM



### Consejos de Conservación

- No debe utilizarse en la limpieza, abrasivos como lana de acero, alcohol, vinagre, limón, o productos corrosivos que puedan rayar o quitar la película protectora en los muebles.
- Cuando la limpieza de muebles en general, napa y formica, deben utilizarse un paño ligeramente humedecido y jabón suave.
- Para mover el móvil, es importante que este se eleve desde el suelo, debido a que el arrastre puede causar daño estructural.
- No deje a su móvil en exposición a la intemperie.

### Conservation Tips

- Do not use abrasive products to clean such as steel wool, alcohol, vinegar, lemon, scouring powder, or corrosive products which can scratch or peel off the protective film of the furniture.
- The best way to clean your furniture is to use a slightly moistened cloth with a mild soap.
- To move the furniture assembled, it is important that it is lifted off the ground, because the drag it can cause structural damage.
- Do not leave your furniture in weather exposure.

### Dicas de Conservação

- Não utilizar na limpeza produtos abrasivos tais como: palha de aço, álcool, vinagre, limão, saponáceo, ou produtos corrosivos que possam riscar ou descolar a película protetora dos móveis.
- Na limpeza de móveis em geral, napa e fórmicas, deve ser utilizado um pano levemente umedecido e sabão neutro.
- Para a movimentação do móvel, é importante que este seja levantado do chão, pois ao arrastá-lo pode causar avarias estruturais.
- Não deixe o móvel em exposição a intempéries.

### Certificado de Garantia

A garantia dos produtos fabricados pela Carraro, abrange eventuais defeitos/vícios de fabricação, no prazo estabelecido pelo Código de Defesa do Consumidor, em seu artigo 26,II, o qual prevê a garantia legal de 90 (noventa) dias.



No aplique carga sobre el producto. Riesgo de mal funcionamiento de la puerta corredera.  
Do not apply load on the product. Risk of malfunction of the sliding door.  
Não ponha peso sobre o produto. Risco de mal funcionamento da porta de correr.

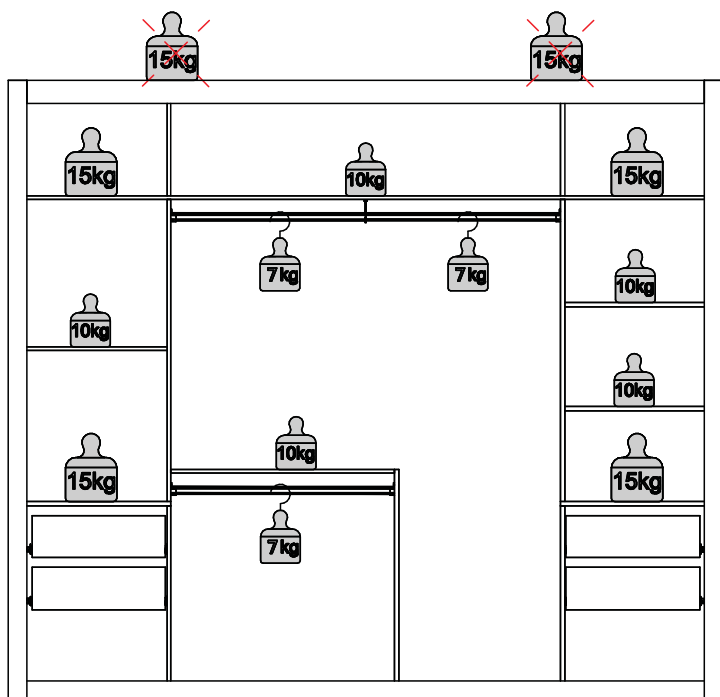

### Peso por estante

Por favor, preste atención a los pesos máximos admitidos por cada compartimento del producto. Tenga cuidado de no exceder estos pesos, con el fin de garantizar la calidad y durabilidad del producto.

Es importante recordar que los pesos muestran en caso de ser distribuida en toda el área de la plataforma.

### Weight per shelf

Please pay attention to the maximum weights supported by each compartment product. Be careful not to exceed these weights, in order to ensure the quality and durability of the product. It is important to remember also that the weights shown should be distributed throughout the area of the shelf.

### Peso por Prateleira

Ao lado são demonstrados os pesos máximos suportados por cada compartimento do produto. Cuide para não exceder esses pesos, afim de garantir a qualidade e a durabilidade do mesmo. É importante lembrar também, que os pesos mostrados devem ser DISTRIBUÍDOS ao longo de toda a área da peça.

# Lista de piezas Parts List Lista de peças

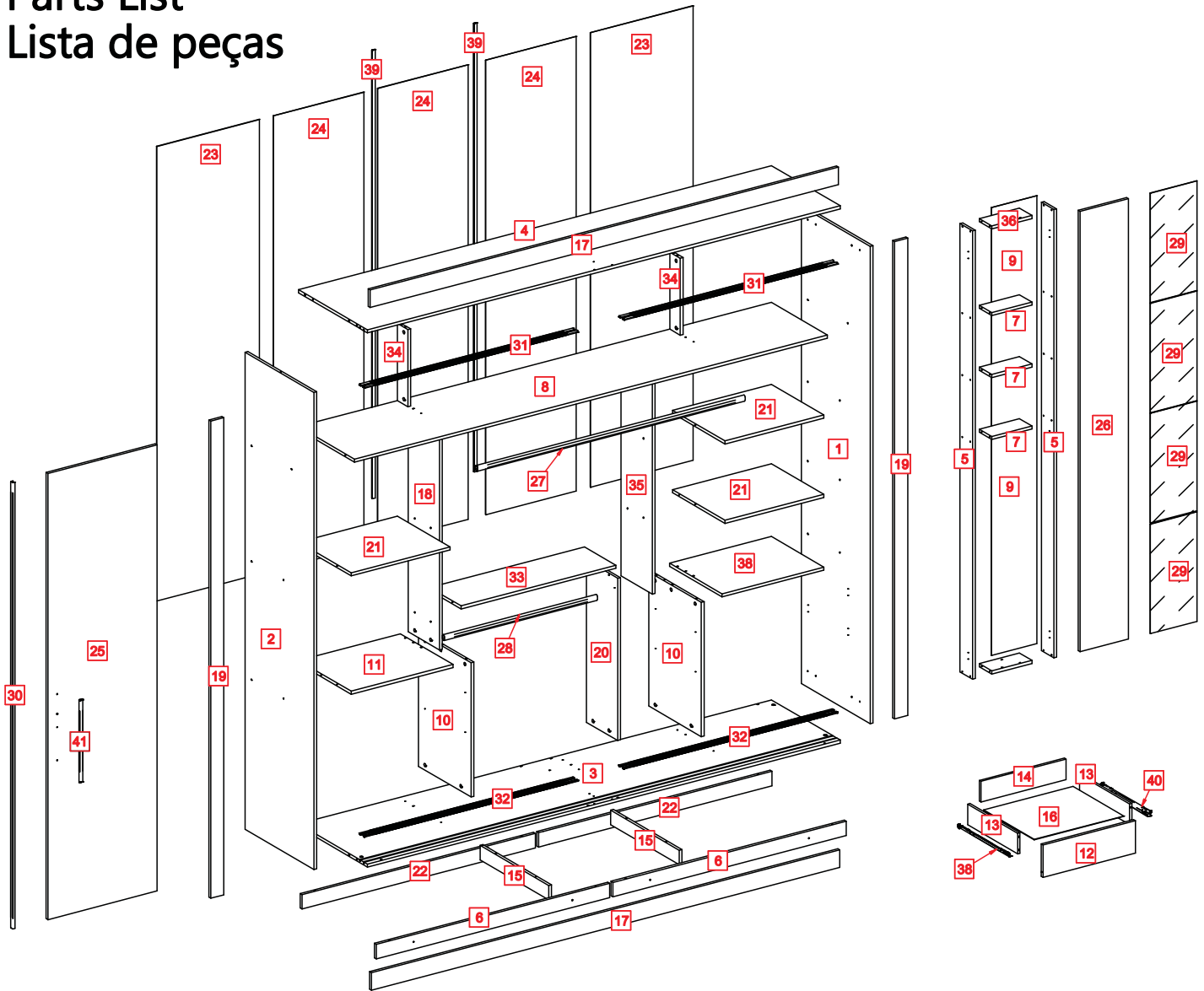

#	Qtde	Español	English	Português	Dimensões	Volume*	#	Qtde	Español	English	Português	Dimensões	Volume*
1	1	Lateral Derecha	Right Side	Lateral Direita	2310 x 550 x 15	1	22	2	Zócalo Trasero	Back Baseboard	Rodapé Traseiro	1266 x 70 x 15	4
2	1	Lateral Izquierda	Left Side	Lateral Esquerda	2310 x 550 x 15	1	23	2	Costado Maior	Biggest Back Panel	Costa Maior	2200 x 550 x 2,5	3
3	1	Base	Base	Base	2535 x 550 x 15	2	24	3	Costado Medio	Middle Back Panel	Costa Média	2200 x 485 x 2,5	1
4	1	Tapa	Top	Chapéu	2535 x 550 x 15	2	25	2	Puerta Corredera Izquierda	Left Slide Door	Porta de Correr Esquerda	2160 x 585 x 15	3
5	2	Pilastra Maior	Biggest Pilaster	Pilastra Maior	2170 x 100 x 15	1	26	1	Puerta Central	Central Door	Porta Central	2132 x 260 x 15	2
6	2	Zócalo Frontal	Front Baseboard	Rodapé Dianteiro	1266 x 70 x 15	4	27	1	Rolizo Percha Maior	Biggest Hanger Rod	Cabideiro Maior	28x16x0,45x1435	1
7	3	Estante Nicho	Niche Shelf	Prateleira Nicho	215 x 100 x 15	1	28	1	Rolizo Percha Menor	Smaller Hanger Rod	Cabideiro Menor	28x16x0,45x820	1
8	1	Tapa Intermedia	Intermediate Top	Chapéu Intermediário	2535 x 447 x 15	2	29	4	Espejo	Mirror	Espelho	530 x 250 x 3	5
9	1	Costado Menor	Smaller Back Panel	Costa Menor	2168 x 243 x 2,5	1	30	4	Enderezador	Straightener	Desempenador	2160x11x18,5x15	1
10	2	Divisións Cajones	Drawer Division	Divisão Gavetas	650 x 420 x 15	4	31	4	Trilho Superior	Upper Profile	Trilho Superior	1144mm	2
11	1	Tapa Cajones Izquierdo	Top left drawer	Tampo Gavetas Esquerdo	546 x 420 x 15	4	32	4	Trilho Inferior	Lower Profile	Trilho Inferior	1144mm	2
12	4	Frente del Cajón	Drawer Front	Frente de Gaveta	495 x 157 x 15	4	33	1	Estante Reducida	Reduced Shelf	Prateleira Reduzida	830 x 250 x 15	1
13	8	Lateral del Cajón	Drawer Side	Lateral de Gaveta	400 x 100 x 12	2	34	2	Pilastra Menor	Smaller Pilaster	Pilastra Menor	373 x 84 x 15	1
14	4	Costado del Cajón	Drawer Back	Costa de Gaveta	456 x 100 x 12	4	35	1	División Derecha	Right Division	Divisão Direita	1117 x 250 x 15	4
15	2	Zócalo Interno	Internal Baseboard	Rodapé Interno	519 x 70 x 15	2	36	2	Base Tapa Nicho	Niche Base Top	Base Tampo Nicho	215 x 100 x 15	1
16	4	Fondo del Cajón	Drawer Bottom	Fundo de Gaveta	480 x 405 x 2,5	4	37	2	Puerta Corredera Derecha	Right Sliding Door	Porta de Correr Direita	2160 x 585 x 15	3
17	2	Marco Superior-Inferior	Upper-Lower Frame	Moldura Superior-Inferior	2510 x 85 x 15	2	38	1	Tapa Cajones Derecha	Top Right Drawer	Tampo Gavetas Direito	546 x 420 x 15	4
18	1	División Izquierda	Left Division	Divisão Esquerda	1117 x 250 x 15	4	39	2	Perfil "I"	Profile "I"	Perfil "I"	2170 x 15 x 6	2
19	2	Marco Lateral	Side Frame	Moldura Lateral	2310 x 70 x 15	1	40	4	Corredera Metalica	Metalic Slide	Corrediça Metálica	Compr.: 400mm	4
20	1	Division del Rolizo	Hanger Rod Division	Divisão Cabideiro	785 x 250 x 15	1	41	4	Tirador	Handle	Puxador		4
21	3	Estante	Shelf	Prateleira	530 x 420 x 15	4	* Vol 1 - Volume Lateral   Vol 2 - Base Chapéu   Vol. 3 - Porta   Vol. 4 - Prateleira   Vol. 5 - Espelho						

01

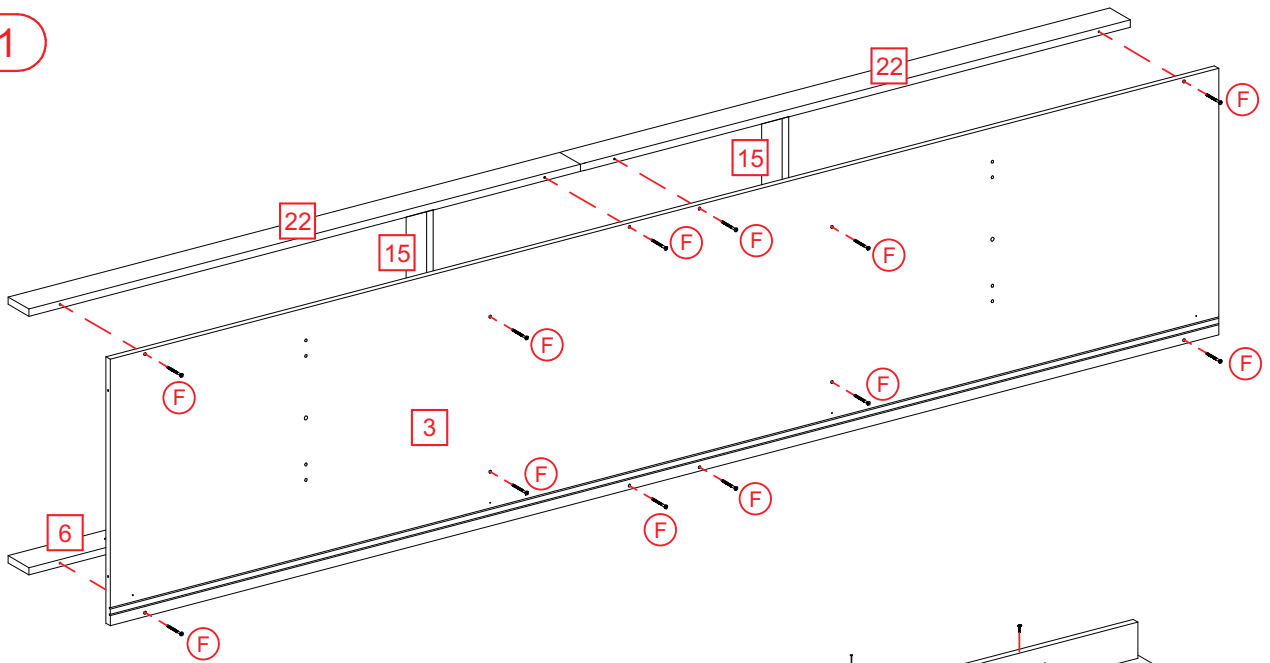

02

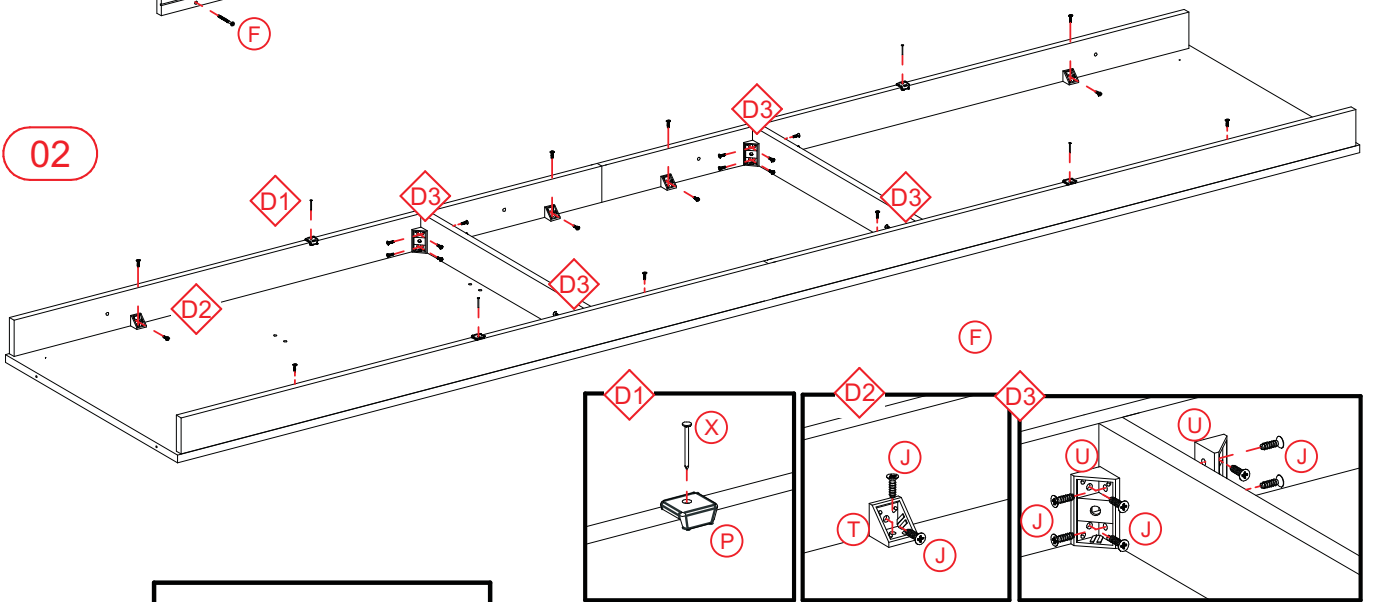

03

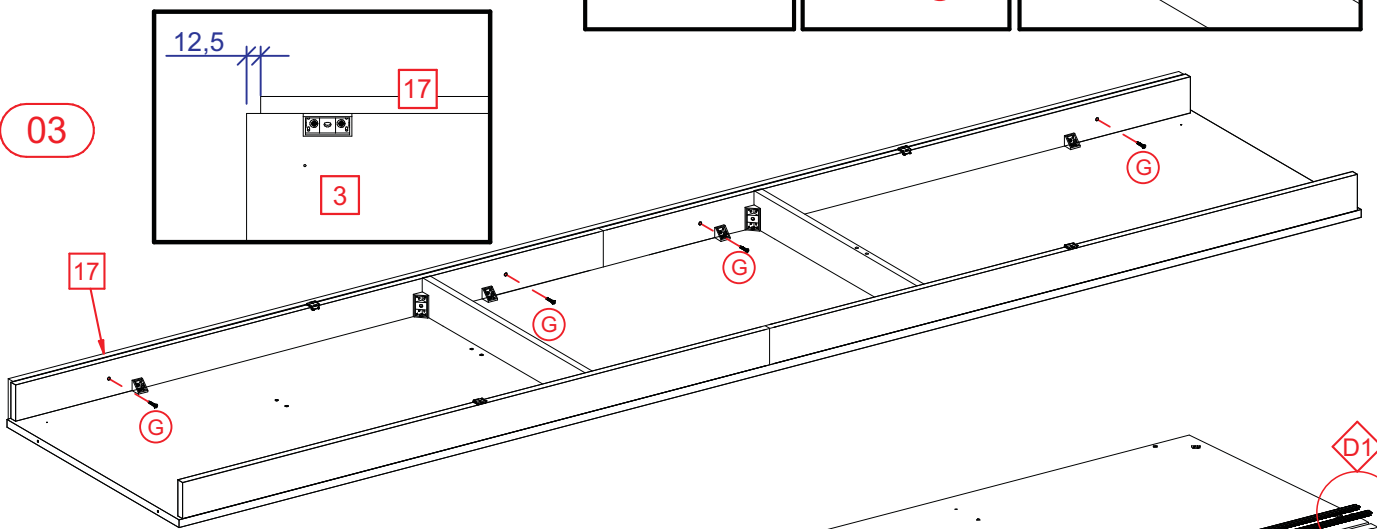

04

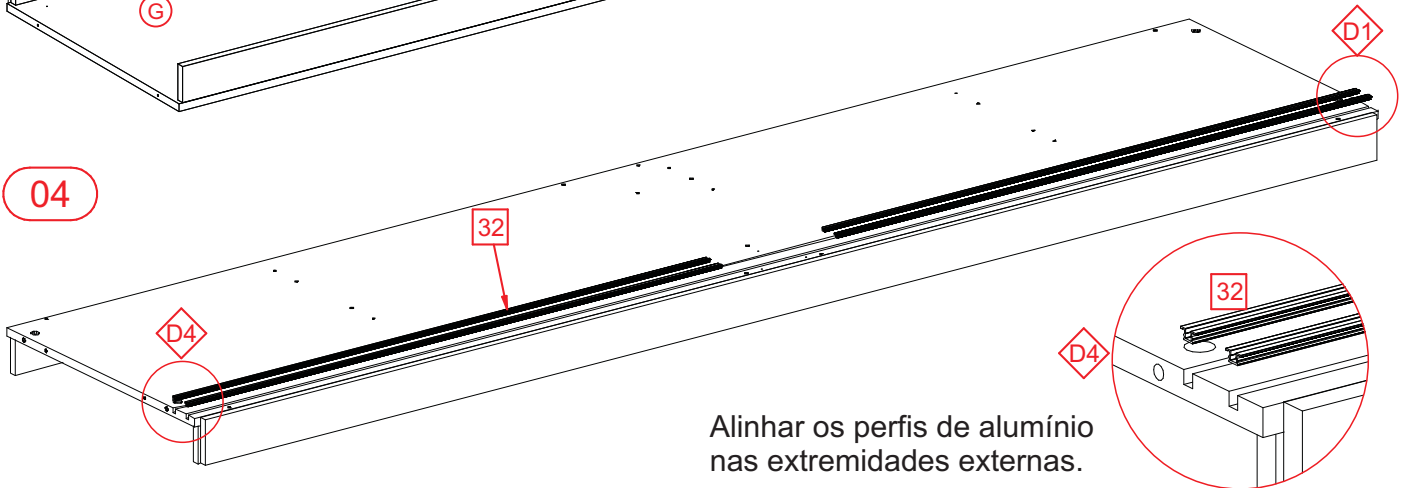

Alinhar os perfis de alumínio nas extremidades externas.

05

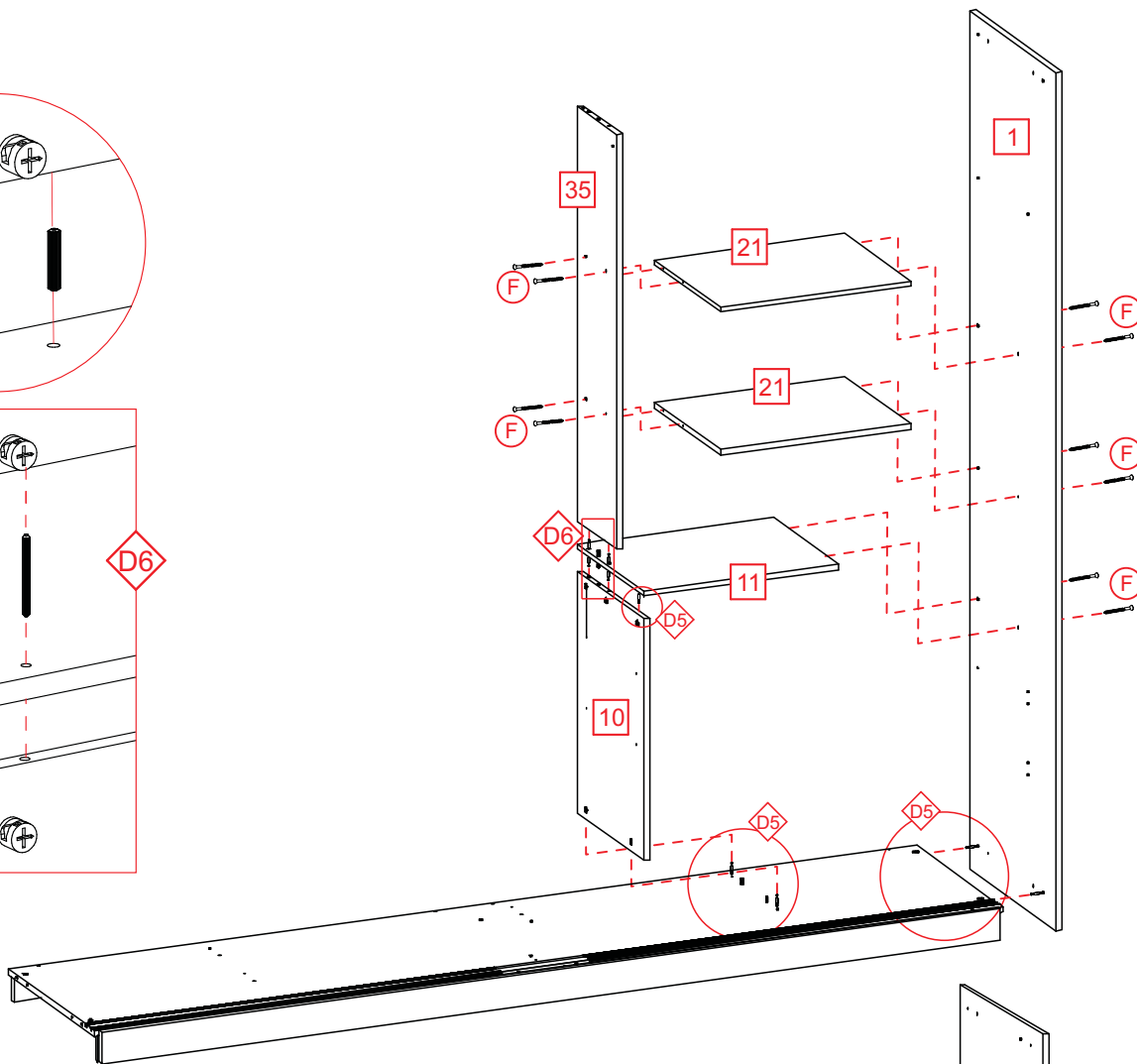
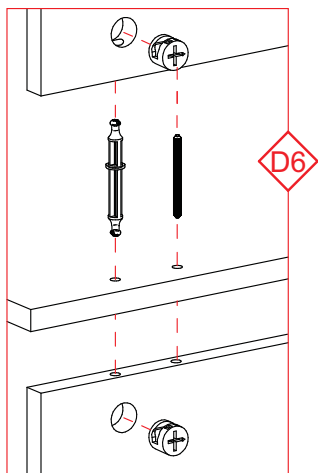
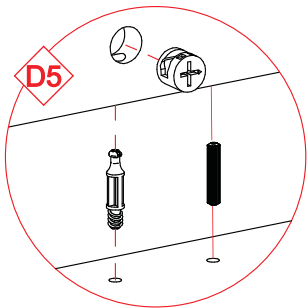

06

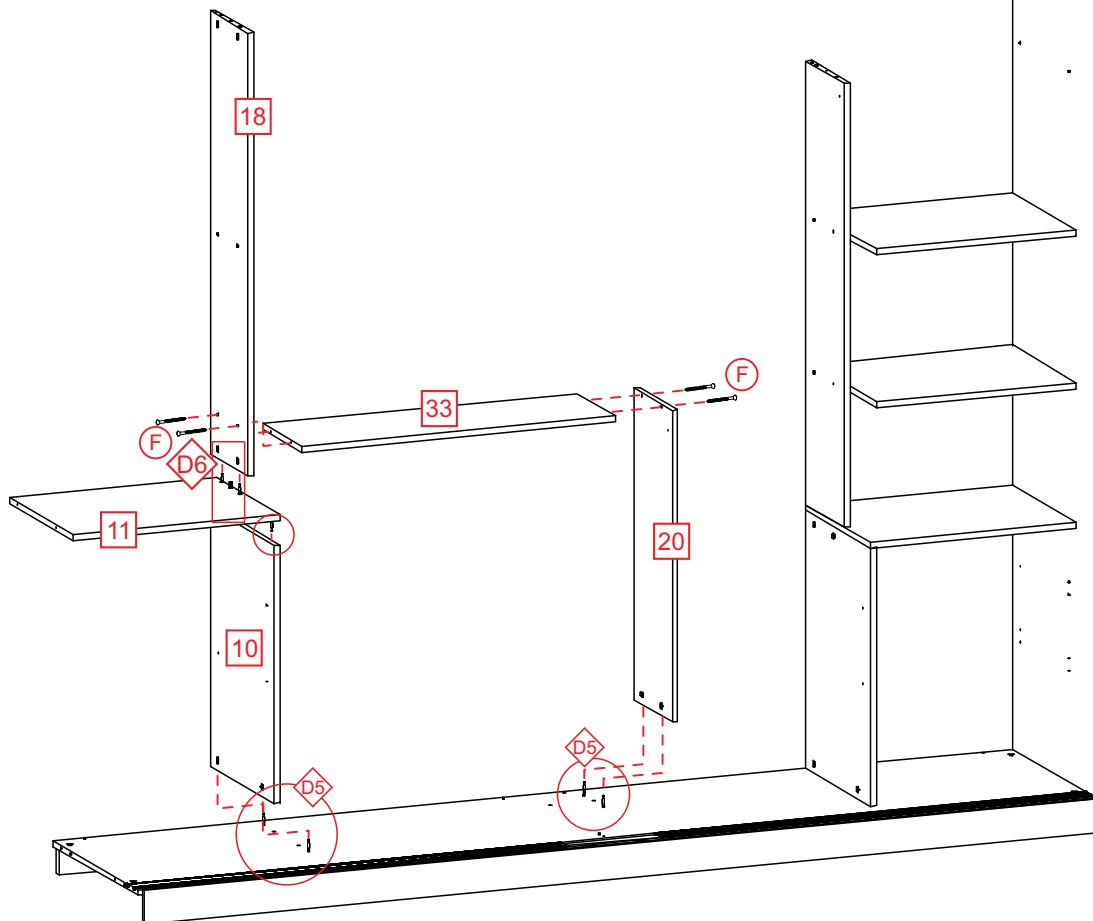

07

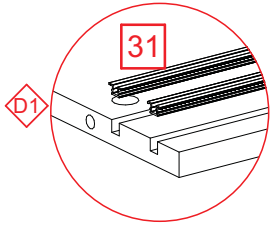

Alinhar os perfis plásticos nas extremidades externas.

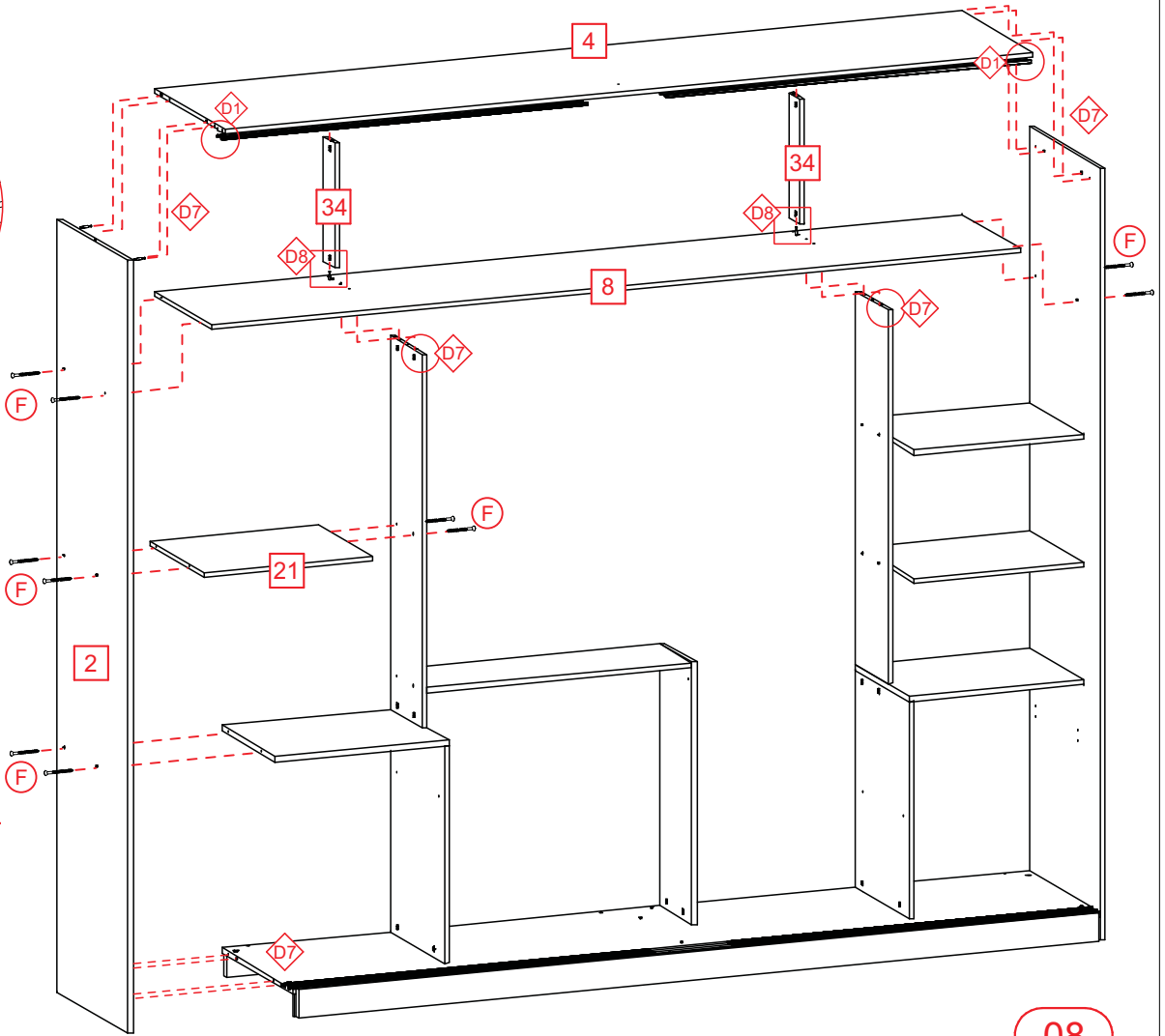
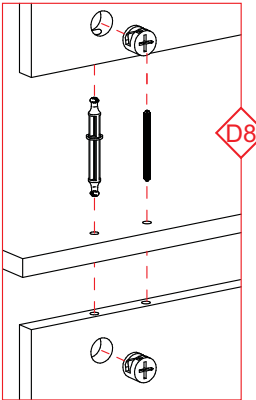
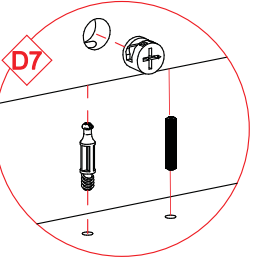

08

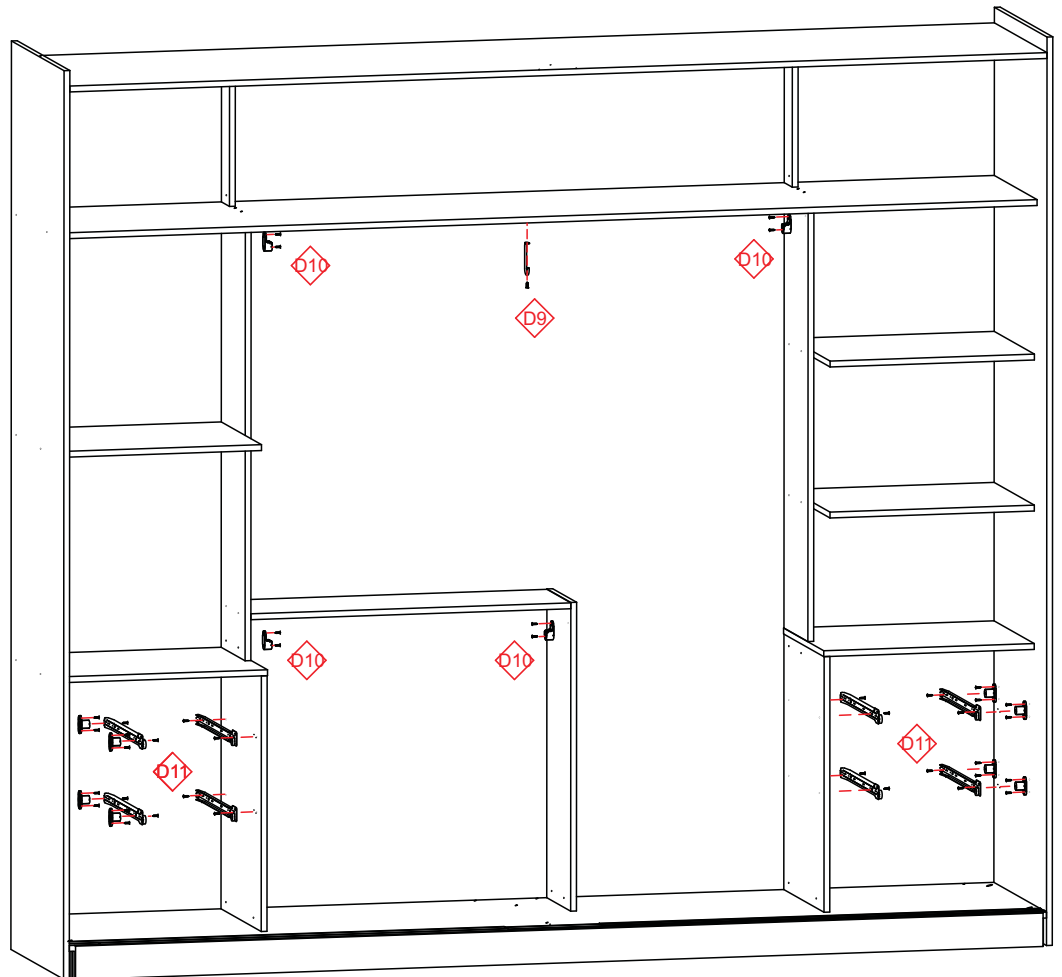
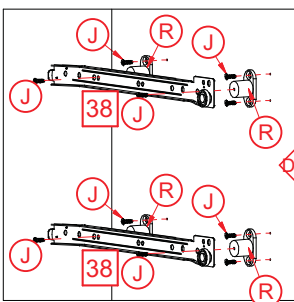
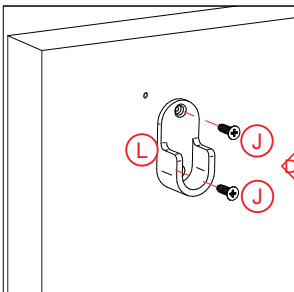
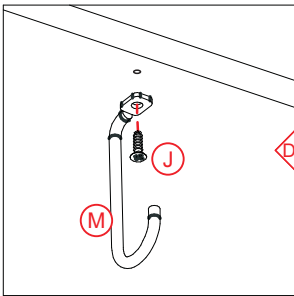

07

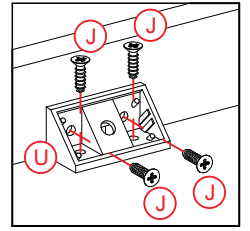
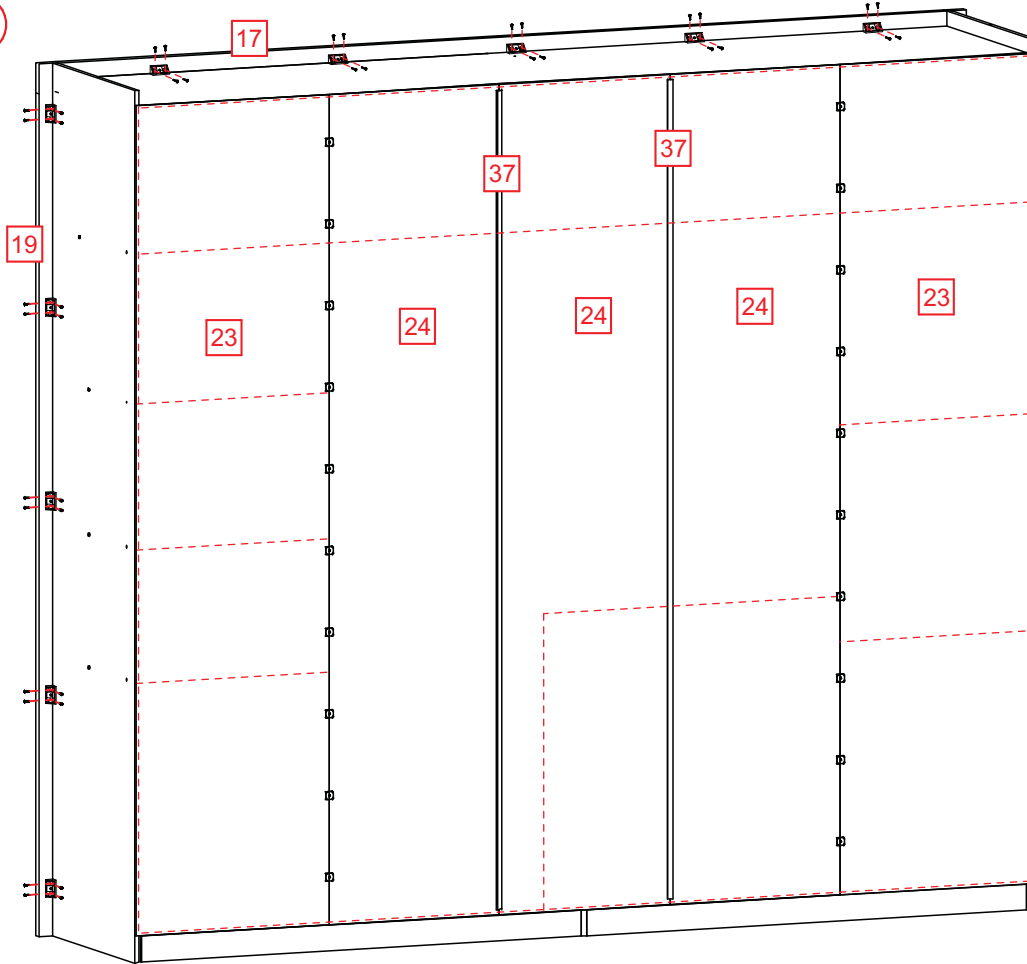

Fijar fondo con clavos cada 150mm, en la línea de puntos.

Fasten bottom drawer with nails every 150mm, where indicated by the dotted line.

08

Fixar o fundo das gavetas com pregos a cada 150mm, onde indicado pela linha vermelha.

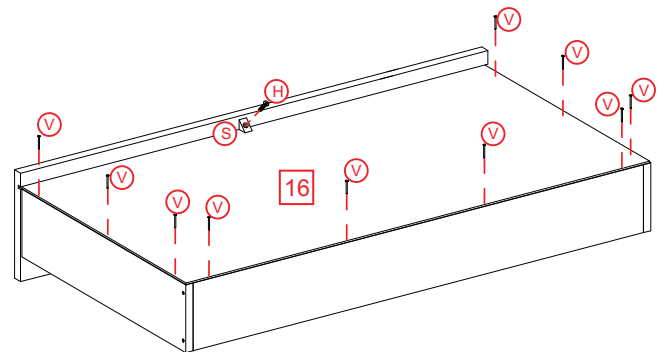
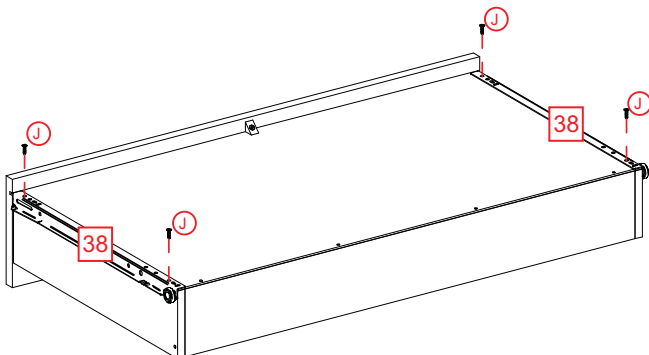
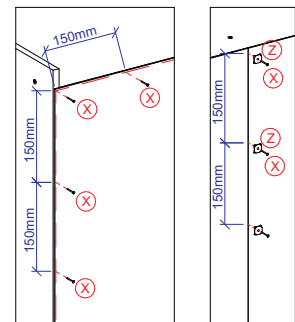
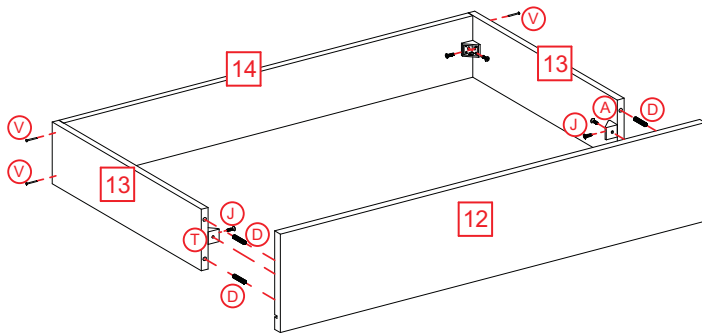

09

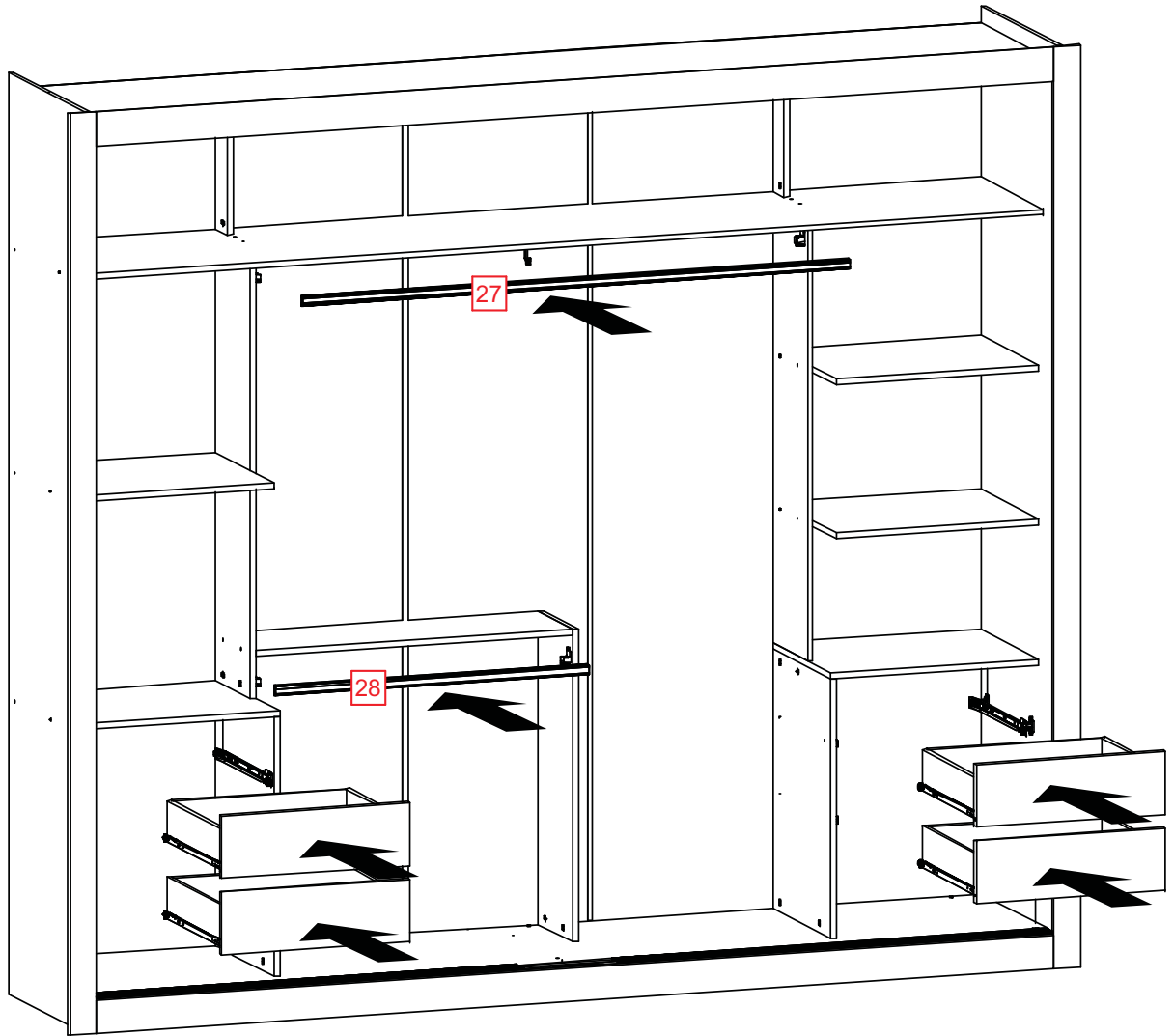

10

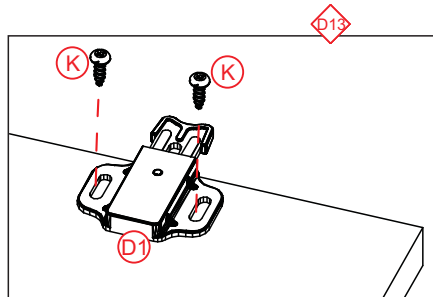
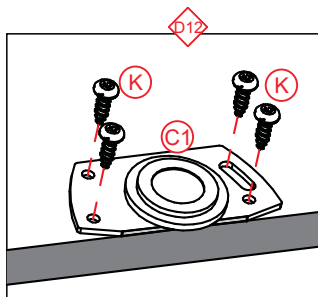
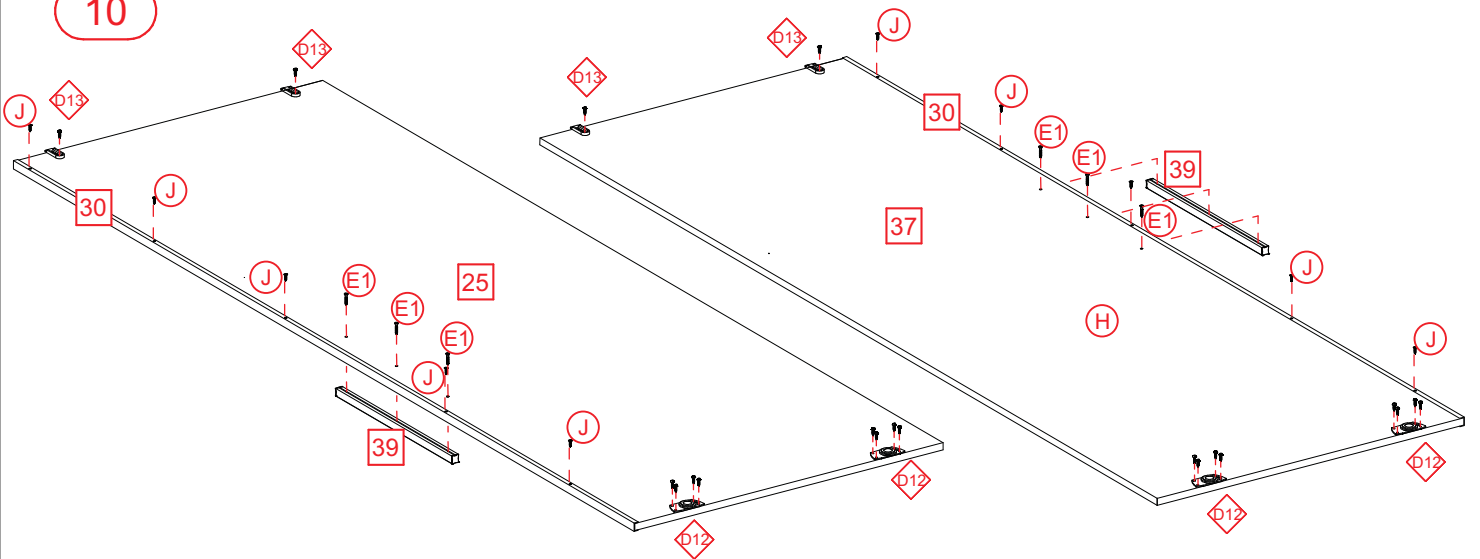



11

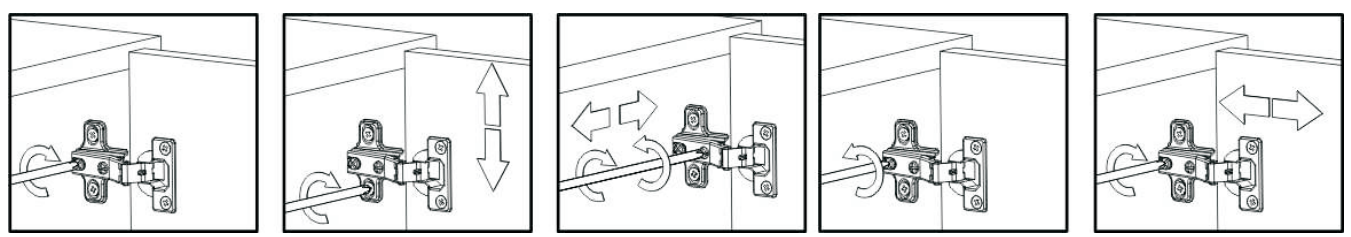
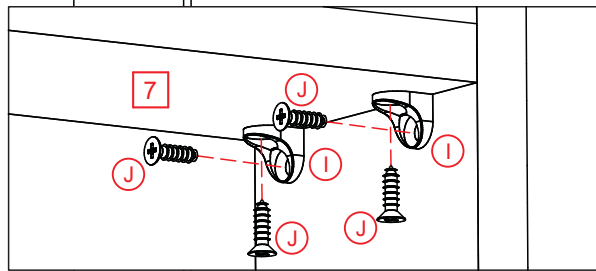
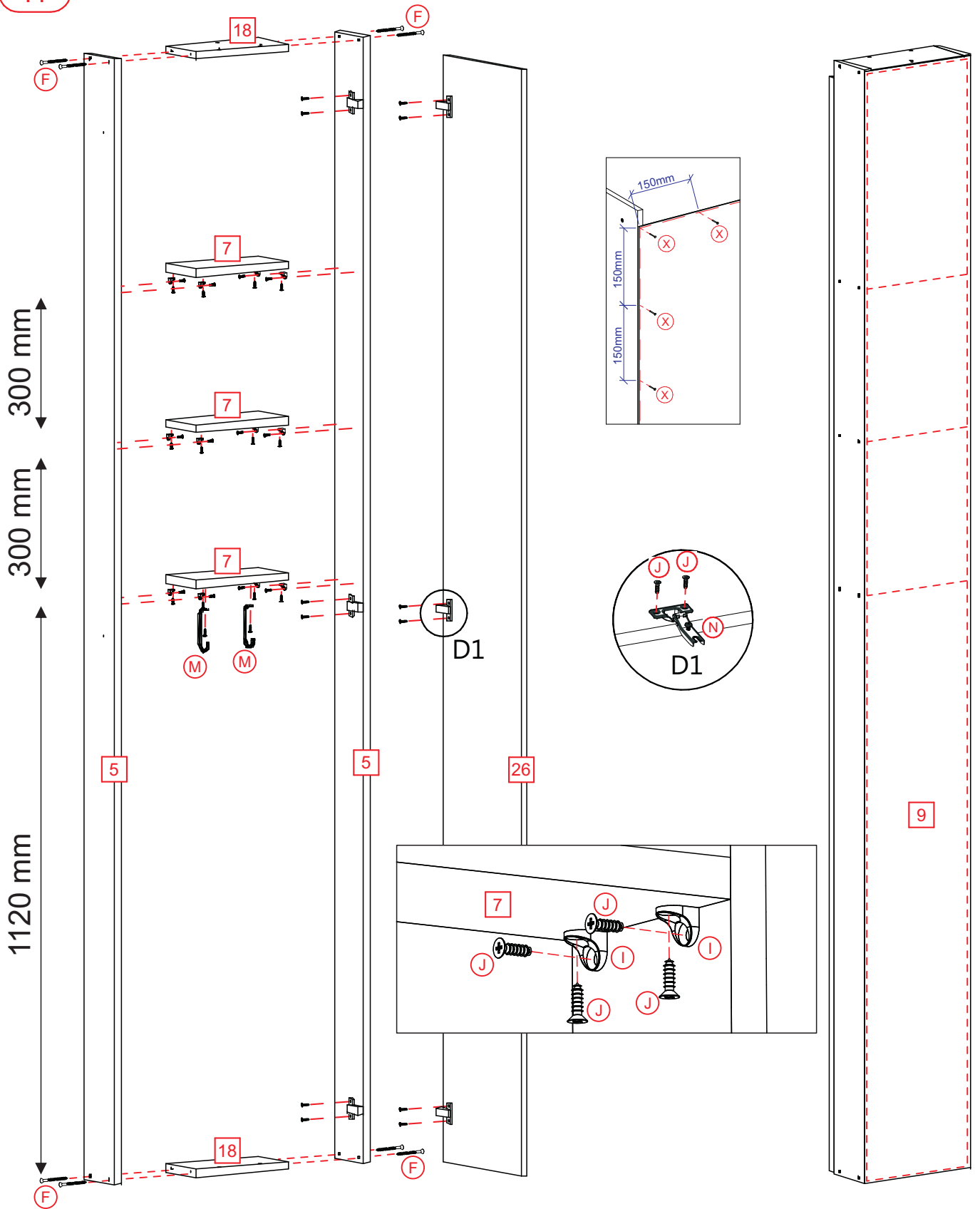

12

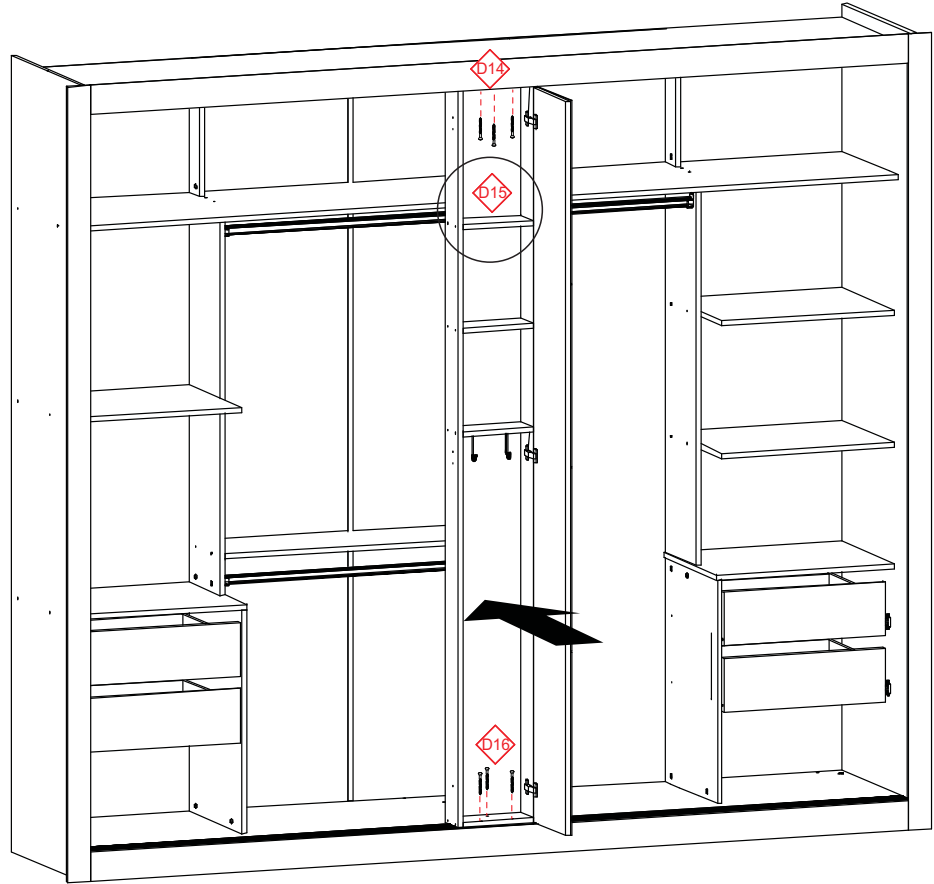
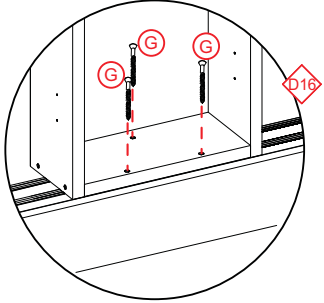
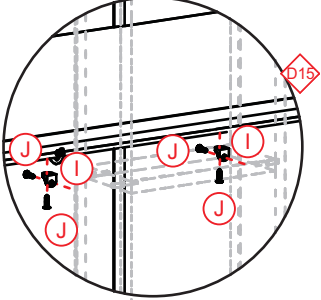
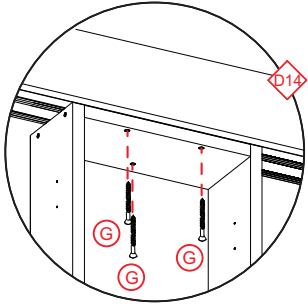

13

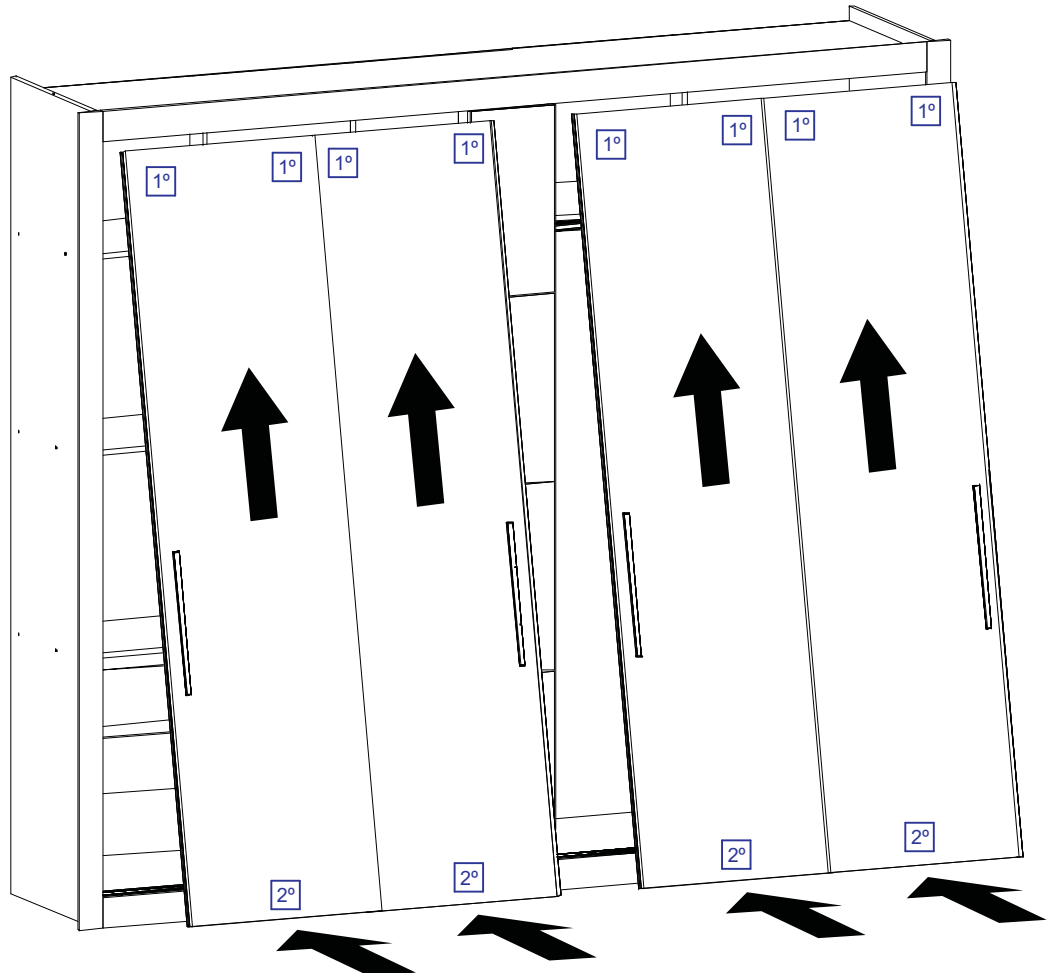
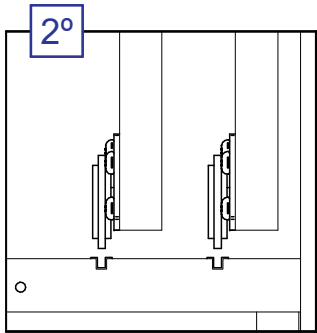
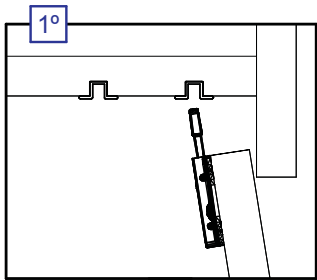

# Montaje de los pies Feet assembly Montagem dos pés

Los pies se venden por separado.  
Feet sold separately.  
Pés vendidos separadamente.

