

# 05

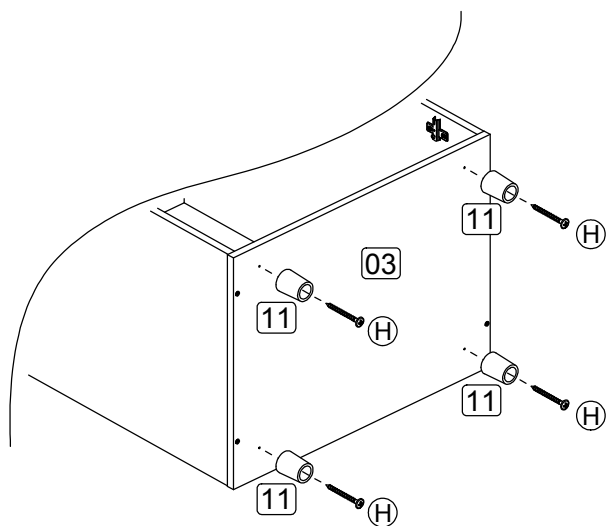

# 06

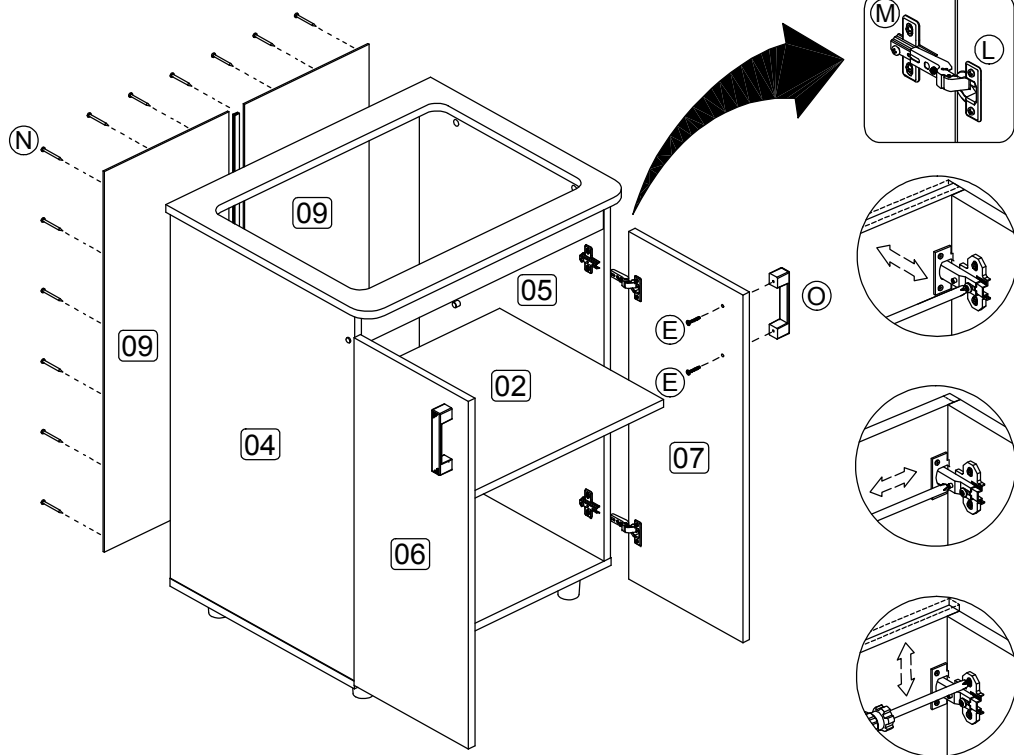

**INSTRUÇÕES DE MONTAGEM**  
**INSTRUCTIVO DE ARMADO**  
**ASSEMBLY INSTRUCTIONS**

## Armário Natal

Modelo  
 Modelo  
 Model

3375xx/3376xx

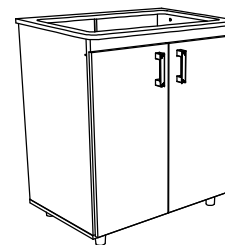

RST 470 - 203,3 - FONE: (0XX54) 3458.1300 - FAX: (0XX54) 3458.1304 - BENTO GONÇALVES - RS - BRASIL  
 DÚVIDAS? ENVIE SEU E-MAIL PARA O SETOR DE ENGENHARIA DA POLITORNO: [engenharia@politorno.com.br](mailto:engenharia@politorno.com.br)  
 DUDAS? ENVIE SEU E-MAIL PARA EL SETOR DE ENGENARIA DA POLITORNO: [engenharia@politorno.com.br](mailto:engenharia@politorno.com.br)  
 QUESTIONS? SEND YOUR E-MAIL TO ENG. SECTION OF POLITORNO: [engenharia@politorno.com.br](mailto:engenharia@politorno.com.br)

KIT FERRAGEM  
 KIT HERRAJE  
 HARDWARE KIT



A	08x30	10
B		04
C		04
D		04
E		04
G		02
H		20
I		02
J		01
K		04
L		04
M		04
N		20
O		02

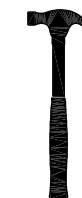

ANTES DE INICIAR A MONTAGEM, IDENTIFIQUE TODAS AS PEÇAS E ACESSÓRIOS.  
 ANTES DE EMPEZA LA ASAMBLE, IDENTIFIQUE TODAS LAS PIEZAS Y ACCESORIOS.  
 BEFORE STARTING THE ASSEMBLY, IDENTIFY ALL PARTS AND ACCESSORIES.

01

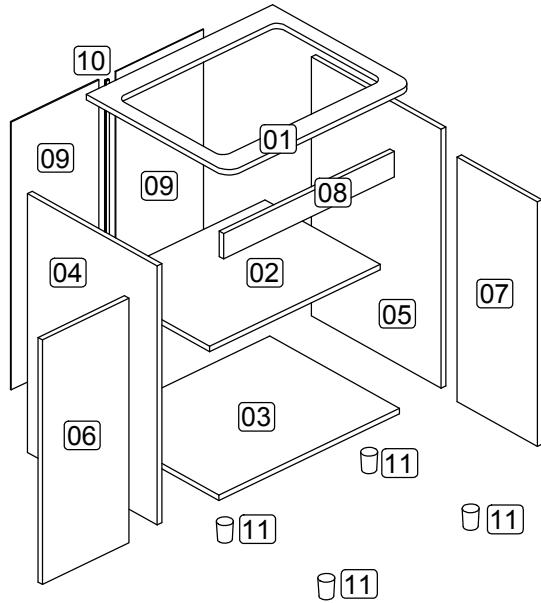

02

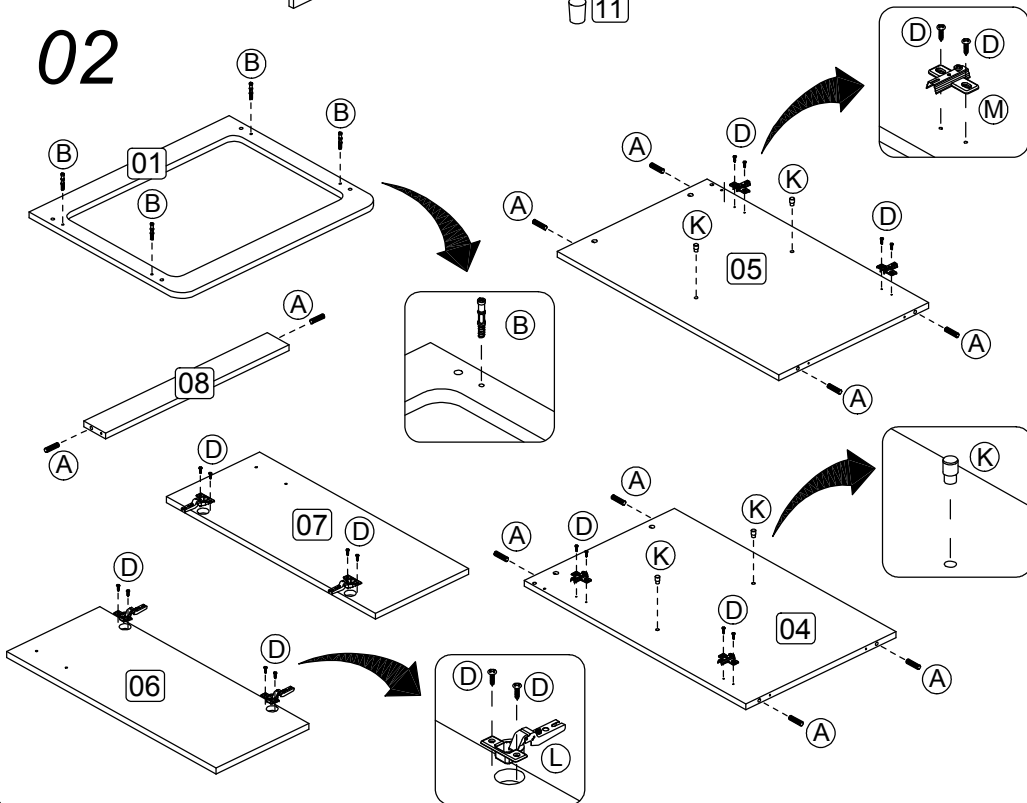

03

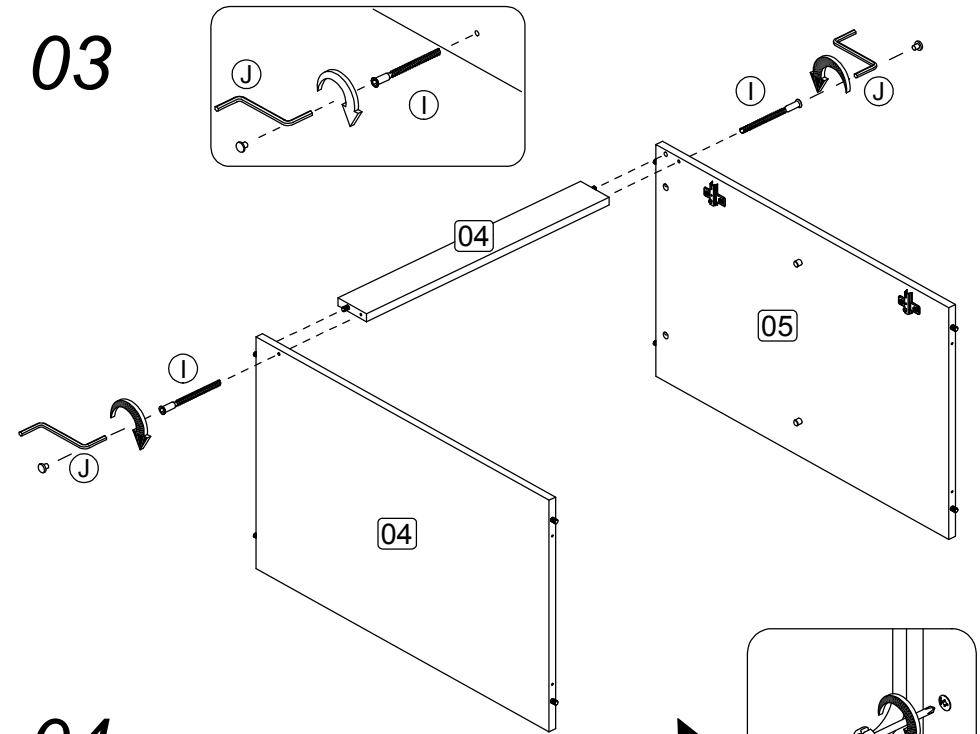

04

