

Item	Caixa Caja Box	Qtd Ctd Qty	Descrição Descripción Description	Medidas (mm) Dimensions (mm) Size (measurements) (mm)
01	1/3	01	Rodapé Frontal Rodapié Frontal Front baseboard	1897x73x12
02	2/3	02	Travessa do rodapé Carril pie Baseboard crosspiece	456x73x12
03	1/3	01	Rodapé Traseiro Rodapié trasero Rear baseboard	1897x73x12
04	1/3	01	Lateral esquerda Lateral izquierda Left side	2050x500x15
05	1/3	01	Travessa da base frontal Carril de la base frontal Front base crossbar	1897x68x12
06	1/3	01	Travessa da base traseira Carril de la base trasera Rear base rail	1897x68x12
07	2/3	02	Divisão das gavetas División de cajones Division of drawers	500x456x12
08	1/3	01	Tampo das gavetas Tapa de los cajones Drawers cover	1897x500x15
09	3/3	01	Divisão esquerda División izquierda Left Division	1132x420x12
10	3/3	01	Divisão direita División derecha Right Division	1132x420x12
11	2/3	02	Prateleira Estante Shelf	624x350x12
12	1/3	01	Chão do maleiro Piso del portaequipajes Floor of the closet top shelf	1897x420x12
13	2/3	02	Ripa do maleiro Portaequipajes de ripa Lath of the closet top shelf	300x68x12
14	1/3	01	Lateral direita Lateral derecha Right side	2050x500x15
15	1/3	01	Tampo superior Cubierta superior top panel	1897x500x15
16	3/3	03	Fundo Fondo Bottom	1466x638x3
17	3/3	03	Fundo inferior Fondo inferior Lower background	638x475x3
18	1/3	01	Chapéu Sombrero Hat	1925x65x15
19	3/3	03	Porta correr Puerta corrediza Sliding door	1430x646x15
20	2/3	09	Frente de gaveta Frente de cajón Front of drawer	632x152x15
21	2/3 e 3/3	18	Lado de gaveta Lado del cajón Side of drawer	350x110x12
22	2/3	09	Fundo de gaveta Fondo del cajón Drawer bottom	586x361x3
23	2/3 e 3/3	09	Ripa de trás Malla detrás Rear lath	599x110x12

Ferragens | Herrajes | Hardware

A 12x Parafuso 4,5x50mm CHT. Tornillo 4,5x50mm CHT. Screw 4,5x50mm CHT.	B 20x Parafuso 3,5x40mm CHT. Tornillo 3,5x40mm CHT. Screw 3,5x40mm CHT.	C 18x Parafuso 3,5x25mm FLA. Tornillo 3,5x25mm FLA. Screw 3,5x25mm FLA.	D 22x Adesivo tapa parafuso 10mm Adhesivo tapón de tornillo 10mm Bolt cover adhesive 10mm	E 56x Parafuso 3,5x12mm FLA. Tornillo 3,5x12mm FLA. Screw 3,5x12mm FLA.
F 134x Parafuso 3,5x12mm CHT. Tornillo 3,5x12mm CHT. Screw 3,5x12mm CHT.	G 18x Parafuso 3,0x16mm FLA. Tornillo 3,0x16mm FLA. Screw 3,0x16mm FLA.	H 128x Cavilha 5x25mm Cinta 5x25mm Dowel 5x25mm	I 26x Prego 12x12mm Anelado Clavo 12x12mm Anillado Ringed Nails 12x12mm	J 125x Prego 10x10mm Clavo 10x10mm Nail 10x10mm
K 12x Porca cilíndrica Tuerca cilíndrica Cylindrical nut	L 35x Fixador de fundos Fijador de fondos Bottom fixer	M 04x Sapata "L" 16x20mm Zapata "L" 16x20mm "L" shoe 16x20mm	N 04x Sapata "U" 12x15mm Zapata "U" 12x15mm "U" shoe 12x15mm	O 34x Cantoneira plástica Cantонера plástica Plastic angle brackets
P 18x Cantoneira suporte triangular Cantонера soporte triangular Triangle support angle	Q 03x Puxador Square 128mm Tirador Square 128mm 128mm Square handle	R 09x Puxador Indonésia 128mm Tirador Indonésia 128mm 128mm Indonésia handle	S 09x Corrediça metal 350mm Corredera de metal 350mm Sliding metal 350mm	T 08x Pé "U" 50x40x100mm Pie "U" 50x40x100mm Foot "U" 50x40x100mm
U 04x Suporte cabideiro Soporte de percha Coat hanger support	V 02x Trilho Alumínio 1896mm Riel Aluminio 1896mm Aluminum Rail 1896mm	W 02x Trilho PVC 1896mm Carril PVC 1896mm PVC Rail 1896mm	X 01x Kit Roldana JM300 (3Portas) Kit Roldán JM300 (3 Puertas) JM300 Pulley Kit (3 Doors)	Y 02x Perfil "I" 315mm Perfil "I" 315mm Profile "I" 315mm
Z 02x Cabideiro Alum. 616mm Alu 616mm percha Alu coat hanger 616mm	AA 03x Sachê de cola Bolsa de pegamento Glue bag	AB 01x Etiqueta resinada Henn Etiqueta resinada Henn Henn resin label	AC 06x Parafuso 3,5x14mm FLA. Tornillo 3,5x14mm FLA. Screw 3,5x14mm FLA.	

HENN

Ind. e Com. de Móveis Henn
Mondai - SC - Brasil

+55 49 3674.3500

@moveishenn
www.henn.com.br

INSTRUÇÕES DE MONTAGEM



Vídeo de Montagem
Vídeo de montaje
Assembly Video

INSTRUCCIONES DE MONTAJE
ASSEMBLY INSTRUCTIONS

ROUPEIRO URAN 03 PORTAS DESLIZANTES
ARMARIO URAN 02 PUERTAS DESLIZANTES | URAN WARDROBE 02 SLIDING DOORS

- D162-10 - Branco
- D162-70 - Amêndoa
- D162-74 - Gris/Palha
- D162-88 - Moka/Moka/Fendi

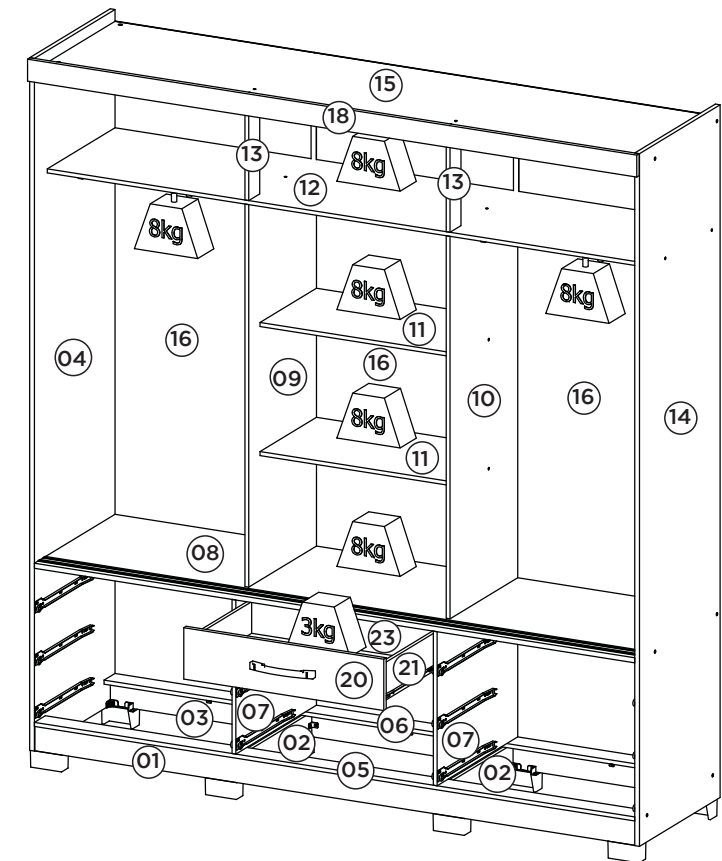

Pesos máximos recomendados com carga distribuída
Peso máximo recomendado con la carga distribuida
Recommended maximum weights with evenly distributed.

Requisitos para montagem
Requisitor para la montaje
Assembly Requirements

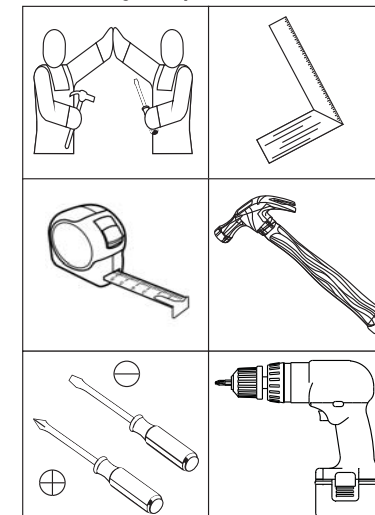

Imagens meramente ilustrativas
Imágenes meramente ilustrativas
Images for illustration only

AVISO

Para limpeza de seu móvel, use uma flanela seca ou umedecida, e não utilize produtos químicos que possam danificar seu produto.

SISTEMA DE MONTAGEM

O sistema de montagem dos produtos, funciona de acordo com a ordem crescente dos números indicados no desenho. Ex: 01, 02, 03, 04... até a conclusão da montagem.

ADVERTENCIA

Para limpieza de su móvil, use una flanela seca o húmeda, y no utilice productos químicos que puedan dañar su producto.

SISTEMA DE MONTAJE

El sistema de montaje de los productos funciona de acuerdo con el orden creciente de los números indicados en el dibujo. Ej.: 01, 02, 03, 04... hasta la conclusión del montaje.

NOTICE

To clean your furniture, use a dry or wet cloth, and do not use chemicals that may damage your product.

ASSEMBLY SYSTEM

The products' assembly system works according to the increasing order of the indicated numbers. For example: 01, 02, 03, 04 ... to the end of the assembly.

A colocação das sapatas é opcional.
 La colocación de los zapatos son opcionales.
 The placement of the shoes are optional.

No caso de serem colocadas as sapatas
 não é necessário a colocação dos pés (T).
 Si se colocan los zapatos
 no es necesario colocar los pies (T).
 In case the shoes are placed
 it is not necessary to place the feet (T).

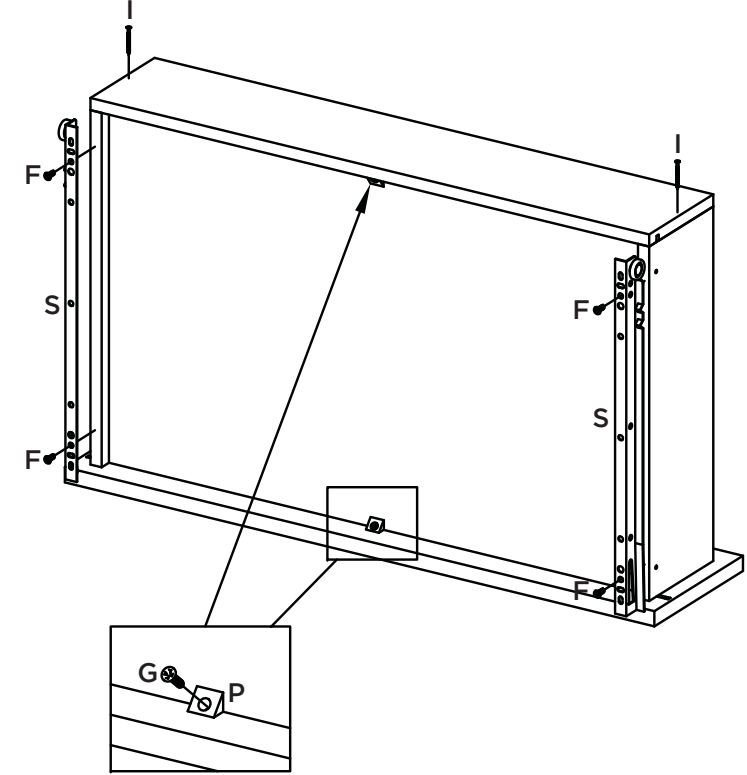
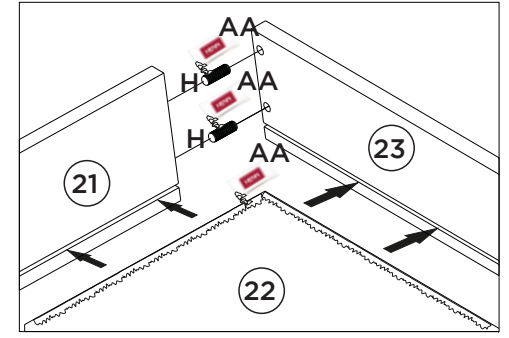
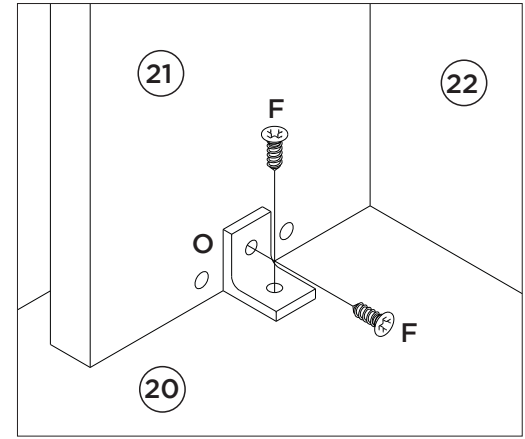
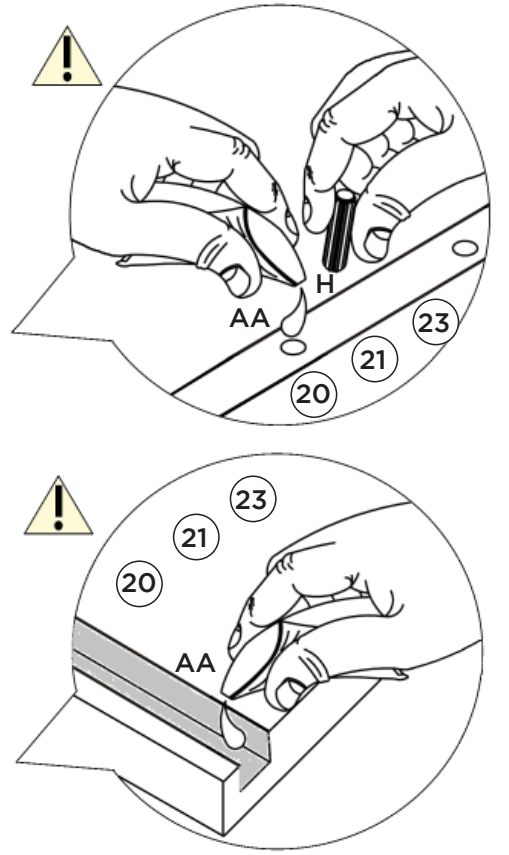
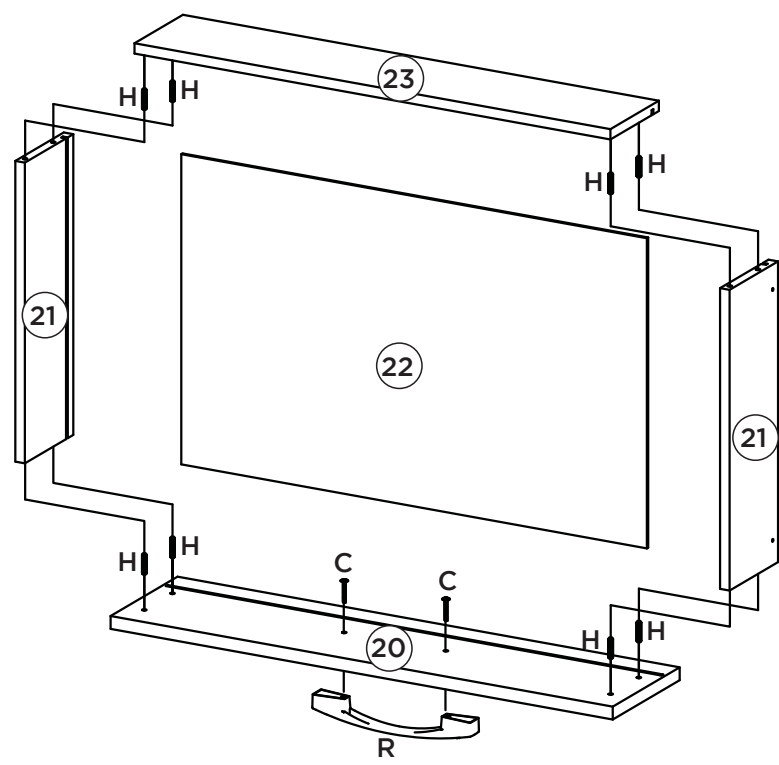
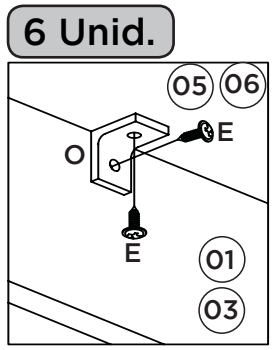
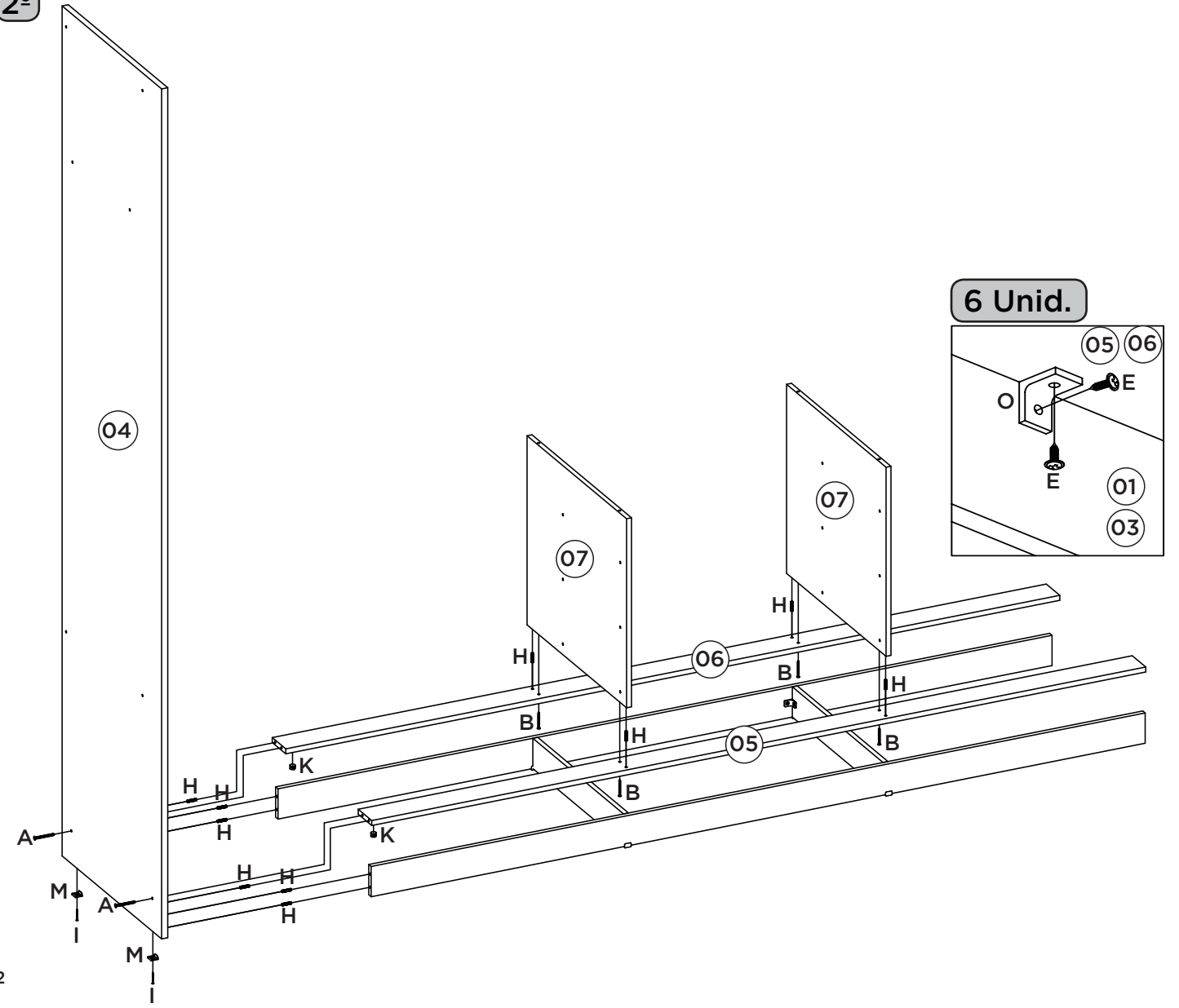
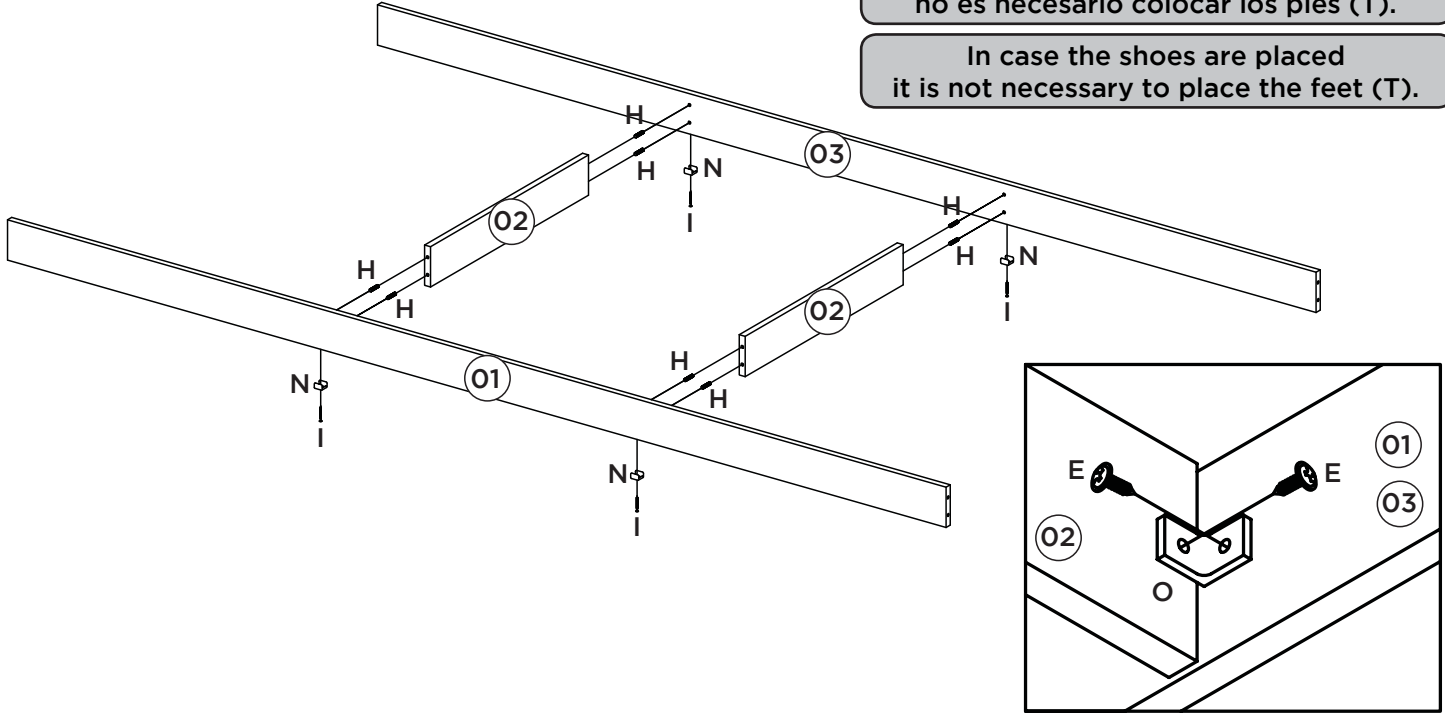

Utilize o sachê de cola (AA) nas cavilhas (H) e nos frisos das gavetas.

Utilice bolsita de pegamento (AA) los pasadores (H) y las perlas los cajones.

Use the glue sachet (AA) on the pegs (H) and on the frieze of the drawers.

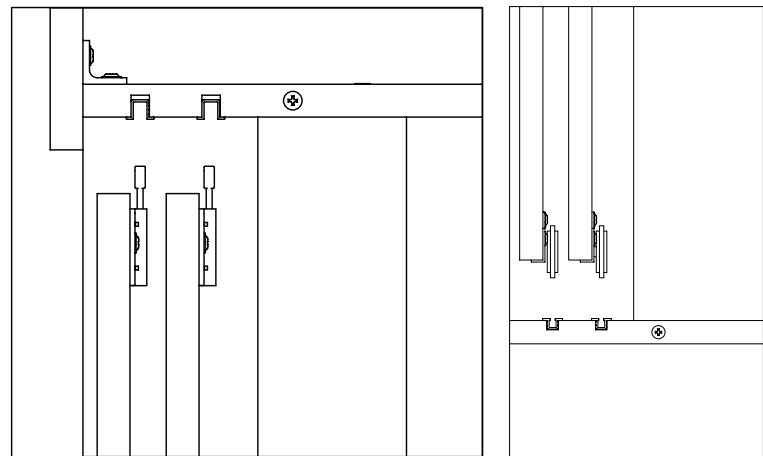

Para a colocação das portas nos trilhos encaixe primeira a porta no trilho de PVC superior (W) e em seguida no trilho de alumínio inferior (V)

Para la colocación de las puertas en la pista instalación de la puerta en la primera banda superior PVC (W) y luego el riel de aluminio inferior (V)

For placing the doors on the rails fitting the door on the PVC rail first (W) and then on the lower aluminum rail (V)

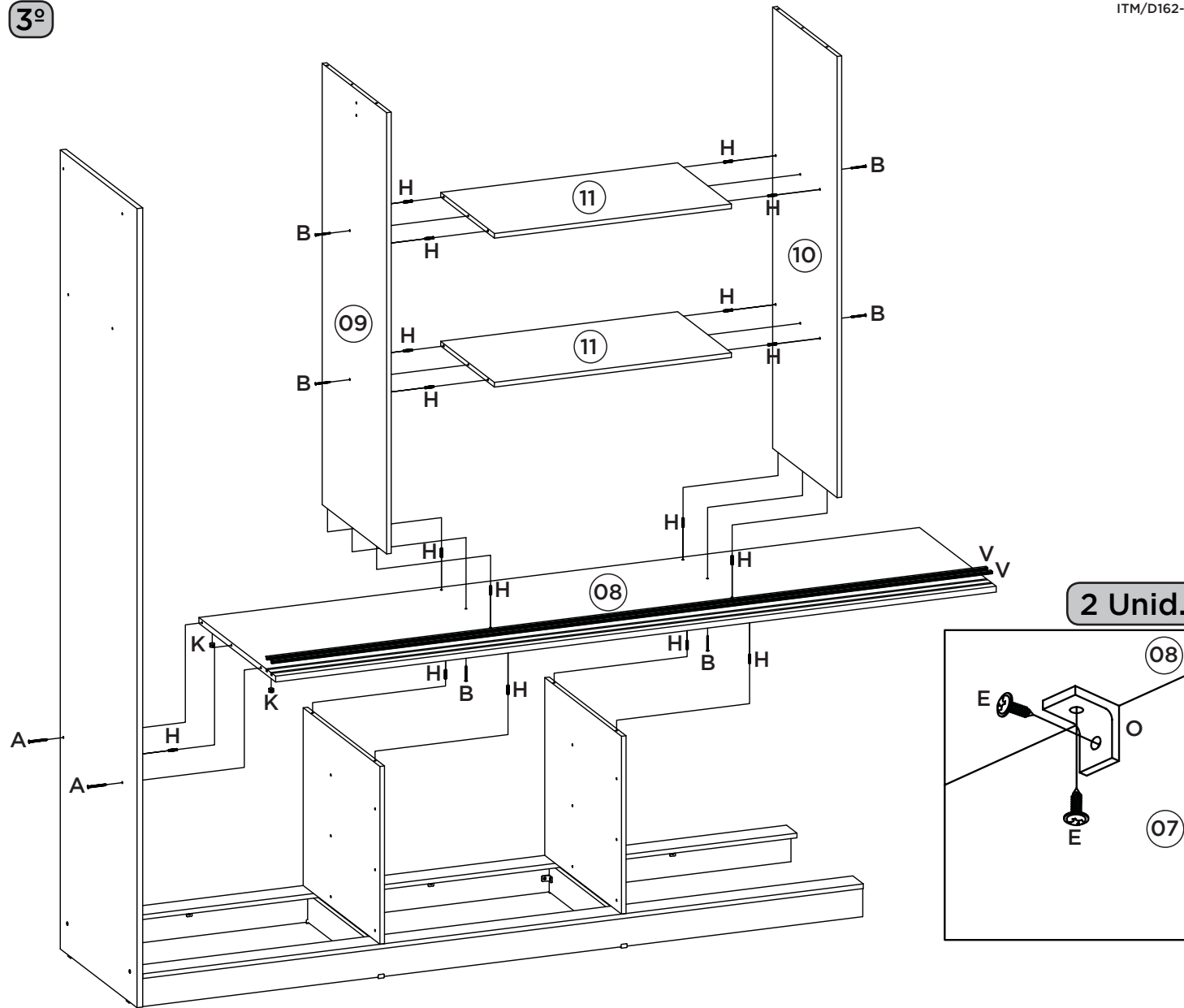
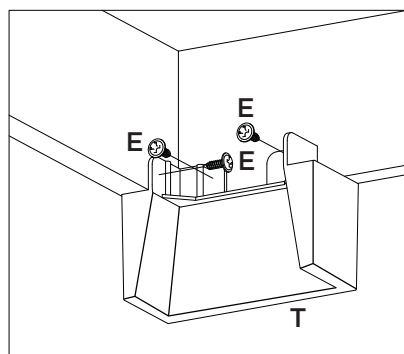
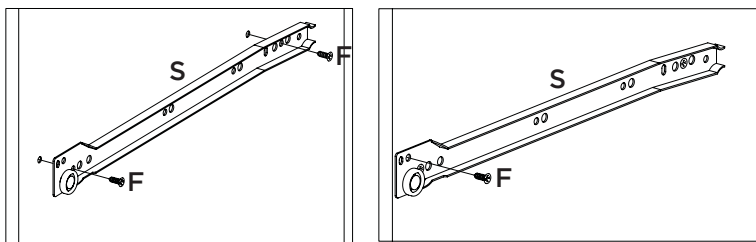
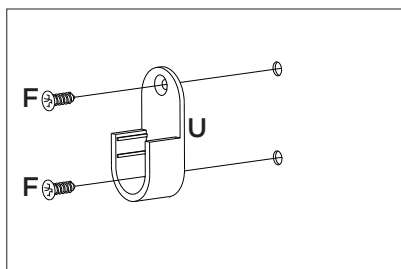
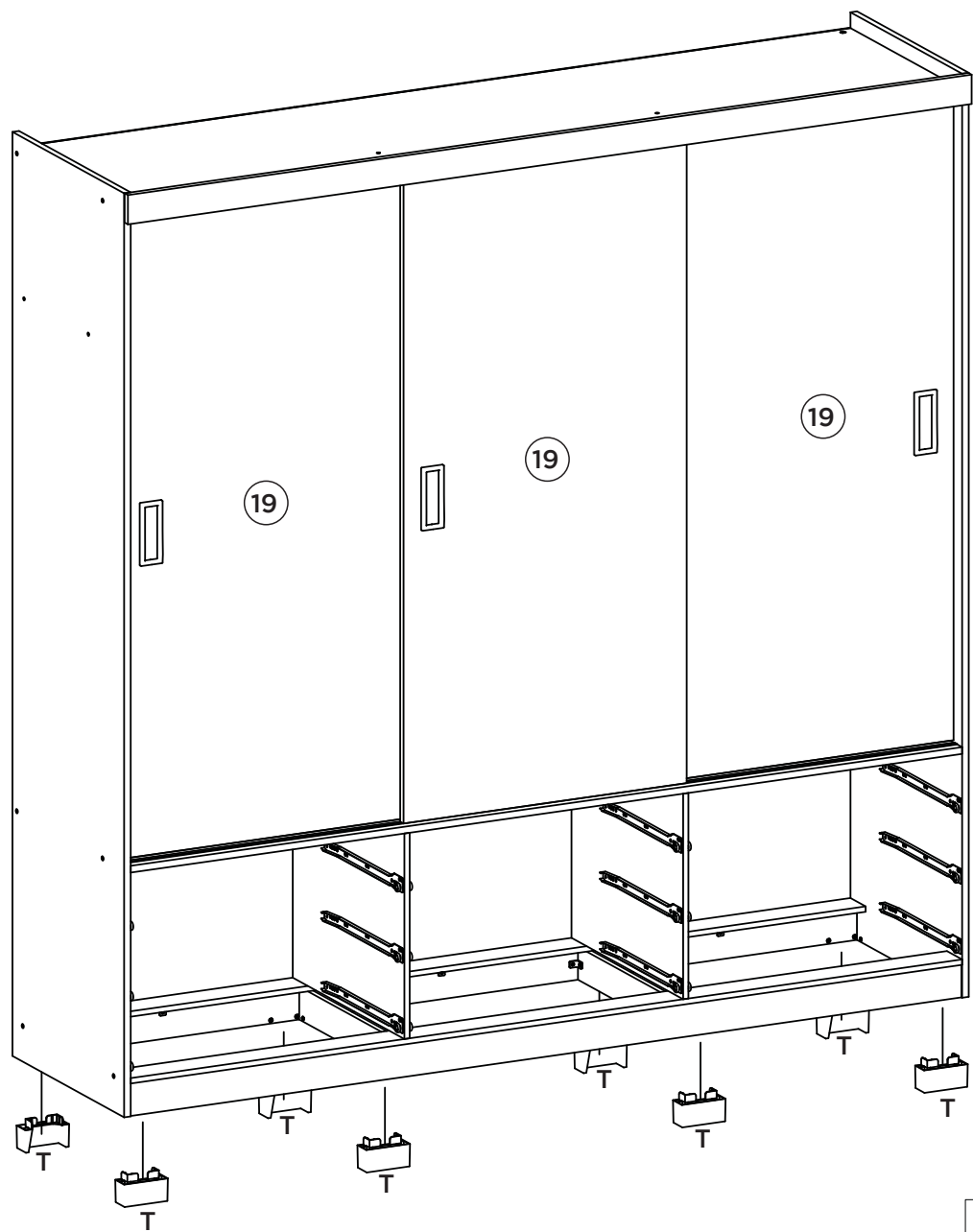

2 Unid.

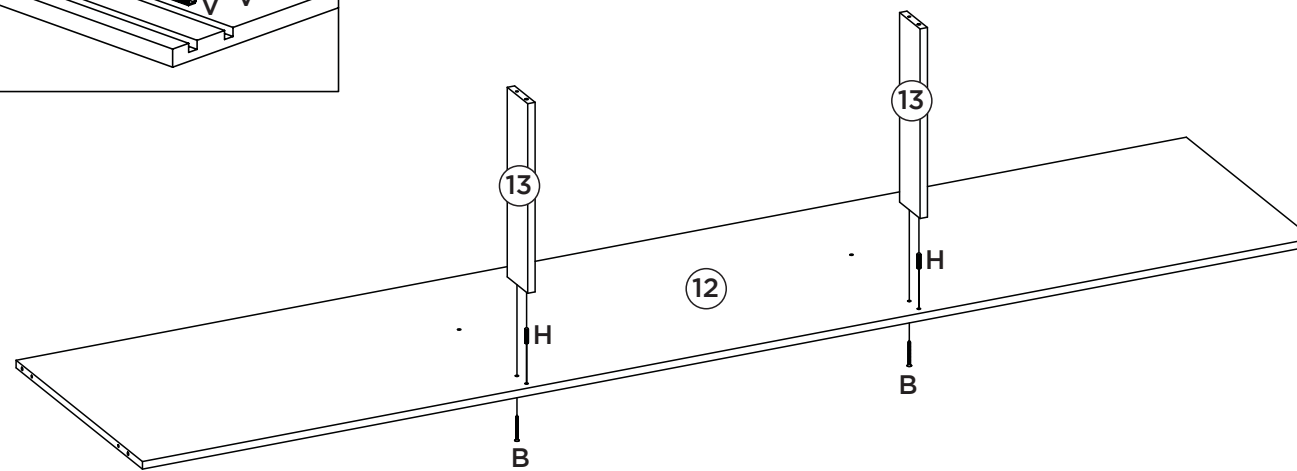
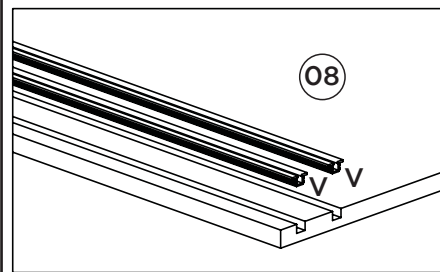

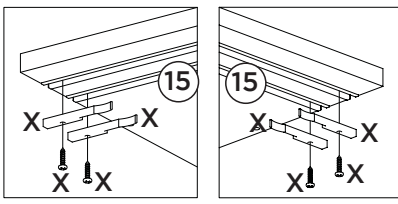
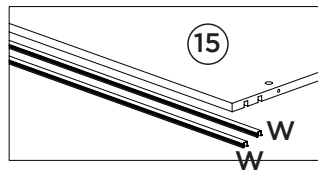
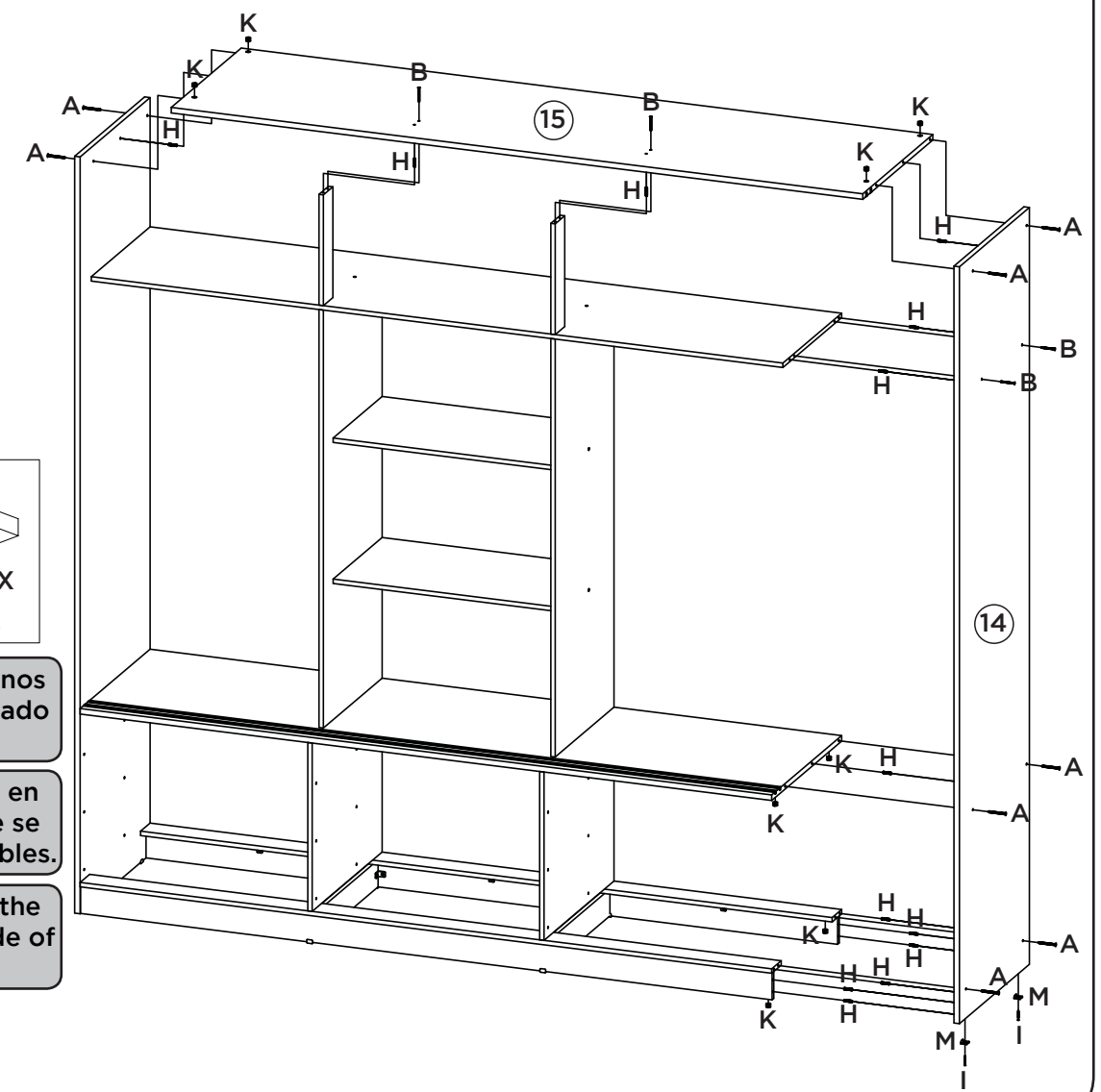
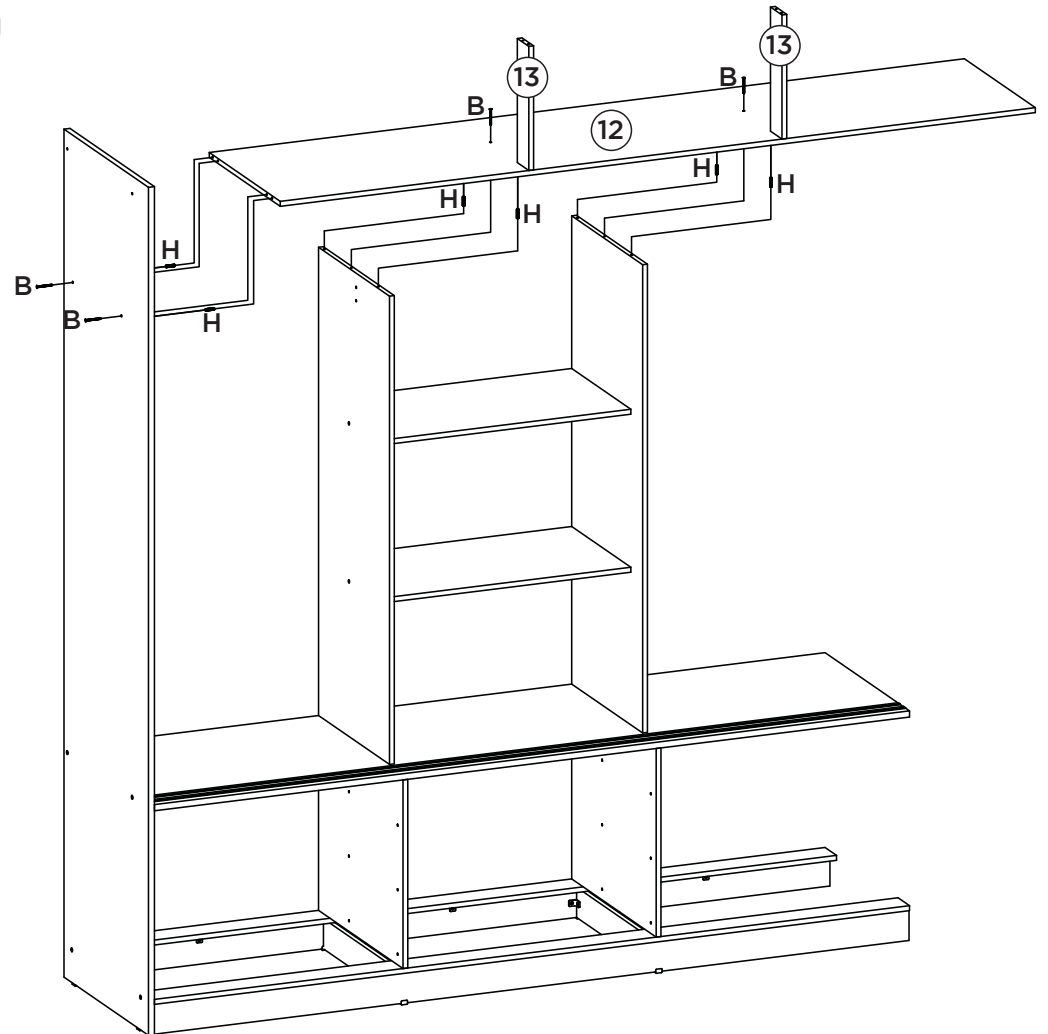

Colocar os freios do kit (X) nos trilhos de PVC (W) e encostado na lateral do móvel.

Colocar el kit de frenos (X) en los rieles de PVC (W) y que se inclina en el lado de los muebles.

Place the kit brakes (X) on the PVC rails (W) against the side of the furniture.

