

Item	Caixa Box	Qty	Descrição Descripción Description	Medidas (mm) Dimensions (mm) Size (measurements) (mm)	Código das Peças Código de las piezas Parts Code
01	2/4	01	Rodapé frontal Rodapié frontal Front footboards	2289x73x15	03271423
02	2/4	02	Travessa do rodapé Carril pie Footboard tray	409x73x15	03301428
03	2/4	01	Rodapé traseiro Rodapié trasero Rear footboard	2289x73x15	03271424
04=08	3/4	01	Base Base Base	768x445x15	03293334
05	1/4	01	Lateral esquerda Lateral izquierda Left side	2250x445x15	03153434
06	1/4	01	Divisão esquerda División izquierda Left division	1629x445x15	03061518
07=19	2/4	03	Prateleira Estante Shelf	753x350x15	03221406
08=04	3/4	01	Base Base Base	768x445x15	03293334
09	1/4	01	Divisão direita División derecha Right division	1629x445x15	03061517
10	2/4	01	Tampa da cômoda Cubierta de la cómoda Dresser cover	753x445x15	03293333
11	2/4	01	Prateleira Central Estantería central Central Shelf	753x250x15	03221404
12	1/4	02	Prateleira Usinada Estantería Usinada Machined Shelf	235x150x15	03221405
13	2/4	01	Moldura Lateral Maior Marco Lateral Mayor Larger Side Frame	768x170x15	03161408
14	2/4	01	Moldura lateral Cornija lateral Side frame	768x60x15	03161407
15	4/4	01	Espelho Espejo Mirror	767x544x3	03032914
16	2/4	02	Ripa do maleiro Portaequipajes de ripa Lath of the closet top shelf	455x68x15	03250680
17	2/4	01	Chão do maleiro Piso del portaequipajes Floor of the closet top shelf	2289x445x15	03293332
18	1/4	01	Lateral direita Lateral derecha Right side	2250x445x15	03153433
19=07	2/4	01	Prateleira Estante Shelf	753x350x15	03221406
20	2/4	01	Tampo Tapa Top	2289x445x15	03293335
21	2/4	01	Fundo Superior Fondo Superior Top Bottom	2311x477x3	03111675
22	4/4	01	Fundo cru Fondo sin procesar Raw bottom	770x703x3	03111676
23	4/4	01	Fundo menor Fondo menos Smaller bottom	770x170x3	03111673
24	4/4	02	Fundo Fondo Bottom	1651x770x3	03111674
25	2/4	01	Chapéu Sombrero Hat	2317x55x15	03050441
26	1/4 e 4/4	06	Porta Menor Puerto Menor Door Minor	465x380x15	03212285
27	4/4	04	Porta Puerta Door	1641x380x15	03212284
28	4/4	04	Frente de gaveta Frente del cajón Drawer front	763x170x15	03131292
29	3/4	08	Lado de gaveta Lado del cajón Drawer side	350x110x15	03140623
30	3/4	04	Fundo de gaveta Fondo del cajón Drawer bottom	709x361x3	03120554
31	3/4	04	Ripa de trás Listón trasero Rear batten	728x110x15	03240732



Ind. e Com. de Móveis Henn
Mondai - SC - Brasil
+55 49 3674.3500
@moveishenn
www.henn.com.br

INSTRUÇÕES DE MONTAGEM

INSTRUCCIONES DE MONTAJE
ASSEMBLY INSTRUCTIONS

ROUPEIRO VIENA 10 PORTAS ARMARIO VIENA 10 PUERTAS | VIENA 10 WARDROBE DOORS D203-94 RÚSTICO | D203-101 CAFÉ

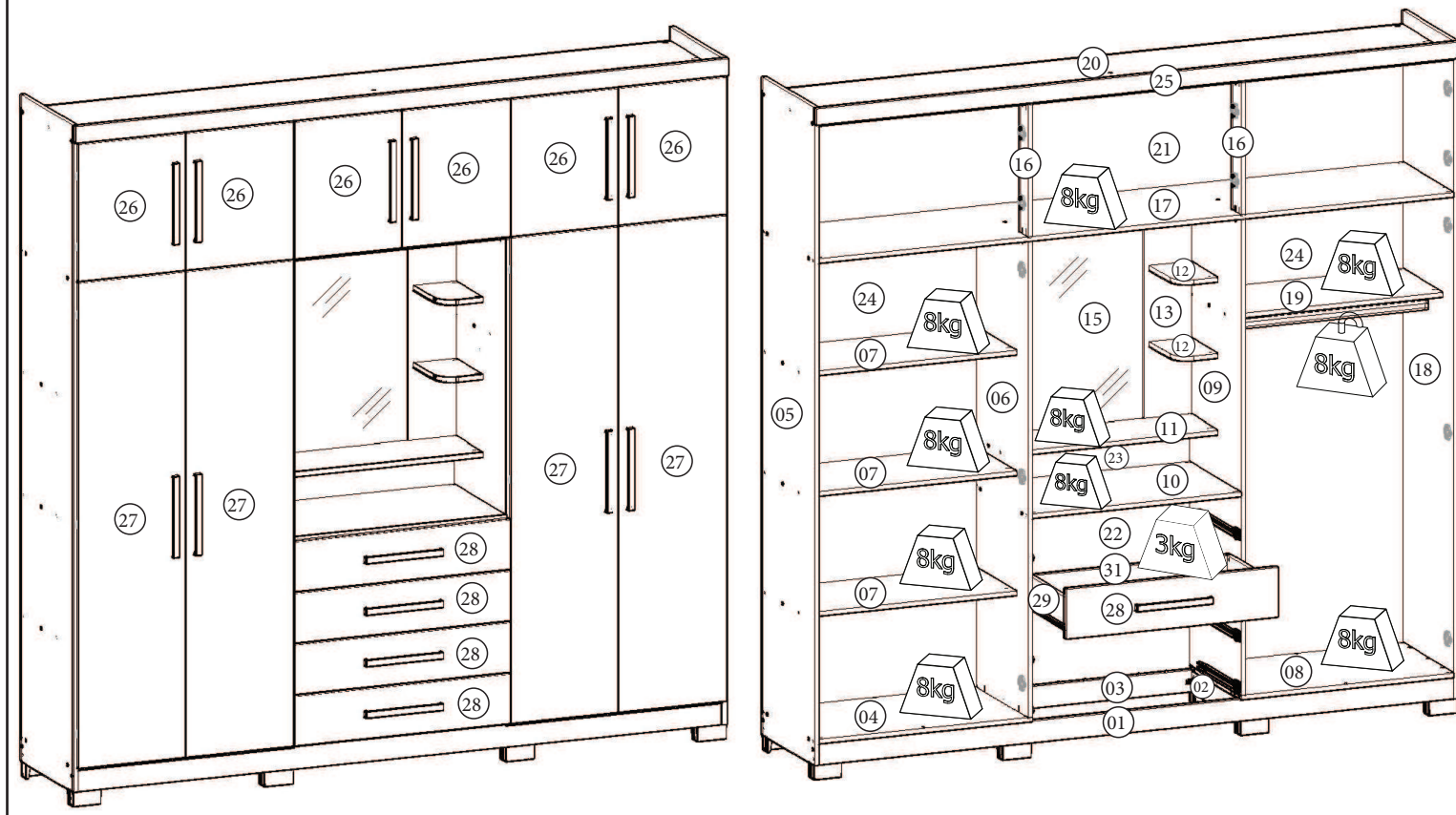

Pesos máximos recomendados com carga distribuída
Peso máximo recomendado con la carga distribuida
Recommended maximum weights with evenly distributed.

AVISO
Para limpeza de seu móvel, use uma flanela seca ou umedecida, e não utilize produtos químicos que possam danificar seu produto.

SISTEMA DE MONTAGEM
O sistema de montagem dos produtos, funciona de acordo com a ordem crescente dos números indicados no desenho. Ex: 01, 02, 03, 04... até a conclusão da montagem.

ADVERTENCIA
Para limpieza de su móvil, use una flanela seca o húmeda, y no utilice productos químicos que puedan dañar su producto.

SISTEMA DE MONTAJE
El sistema de montaje de los productos funciona de acuerdo con el orden creciente de los números indicados en el dibujo. Ej.: 01, 02, 03, 04... hasta la conclusión del montaje.

NOTICE
To clean your furniture, use a dry or wet cloth, and do not use chemicals that may damage your product.

ASSEMBLY SYSTEM
The products' assembly system works according to the increasing order of the indicated numbers. For example: 01, 02, 03, 04 ... to the end of the assembly.

FERRAGENS / HERRAJES / HARDWARE

A Parafuso 4,5x50mm CHT. Tornillo 4,5x50mm CHT. Screw 4,5x50mm CHT.	B Parafuso 3,5x40mm CHT. Tornillo 3,5x40mm CHT. Screw 3,5x40mm CHT.	C Parafuso 3,5x25mm FLA. Tornillo 3,5x25mm FLA. Screw 3,5x25mm FLA.	D Parafuso 3,5x14mm FLA. Tornillo 3,5x14mm FLA. Screw 3,5x14mm FLA.	E Parafuso 3,5x12mm CHT. Tornillo 3,5x12mm CHT. Screw 3,5x12mm CHT.	F Parafuso 3,0x16mm CHT. Tornillo 3,0x16mm CHT. Screw 3,0x16mm CHT.	G Cavilha 8x25mm Cinta 8x25mm Dowel 8x25mm
H Fixador de fundos Fijador de fondos Bottom fixer	I Prego 12x12mm Anelado Clavo 12x12mm Anillado Ringed Nails 12x12mm	J Prego 10x10mm Clavo 10x10mm Nail 10x10mm	K Cantoneira plástica Cantoneira plástica Plastic angle brackets	L Calço metal 5mm Calzado metálico 5mm 5 mm metal shim	M Dobradora metal 26mm Bisagra de metal 26mm 26 mm metal hinge	N Corrediça metal 350mm Corredera de metal 350mm Sliding metal 350mm
O Porca cilíndrica Tuerca cilíndrica Cylindrical nut	P Pé "U" 50x40x100mm Pie "U" 50x40x100mm 50x40x100mm "U" feet	Q Puxador Luxor 256mm Tirador Luxor 256mm 256mm Luxor Handle	R Suporte cabideiro Soporte de percha Coat hanger support	S Cabideiro Alum. 745mm Alum. 745mm percha Alum. coat hanger 745mm	T Parafuso 4,0x25mm FLA MET. Tornillo 4,0x25mm FLA MET. Screw 4,0x25mm FLA MET.	U Porca sextavada Tuerca hexagonal Hex Nut
V Cantoneira suporte triangular Cantoneira soporte triangular Triangle support angle	W Sachê de cola Bolsa de pegamento Glue bag	X Adesivo tapa parafuso 10mm Adhesivo tapón de tornillo 10mm Bolt cover adhesive 10mm	Y Etiqueta resinada Henn Etiqueta resinada Henn Henn resin label			

Requisitos para montagem Requisitor para la montaje Assembly Requirements

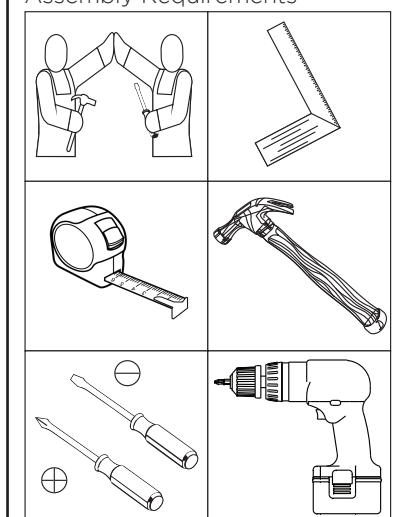

Imagens meramente ilustrativas
Imágenes meramente ilustrativas
Images for illustration only

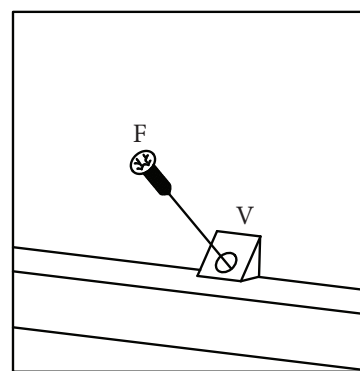
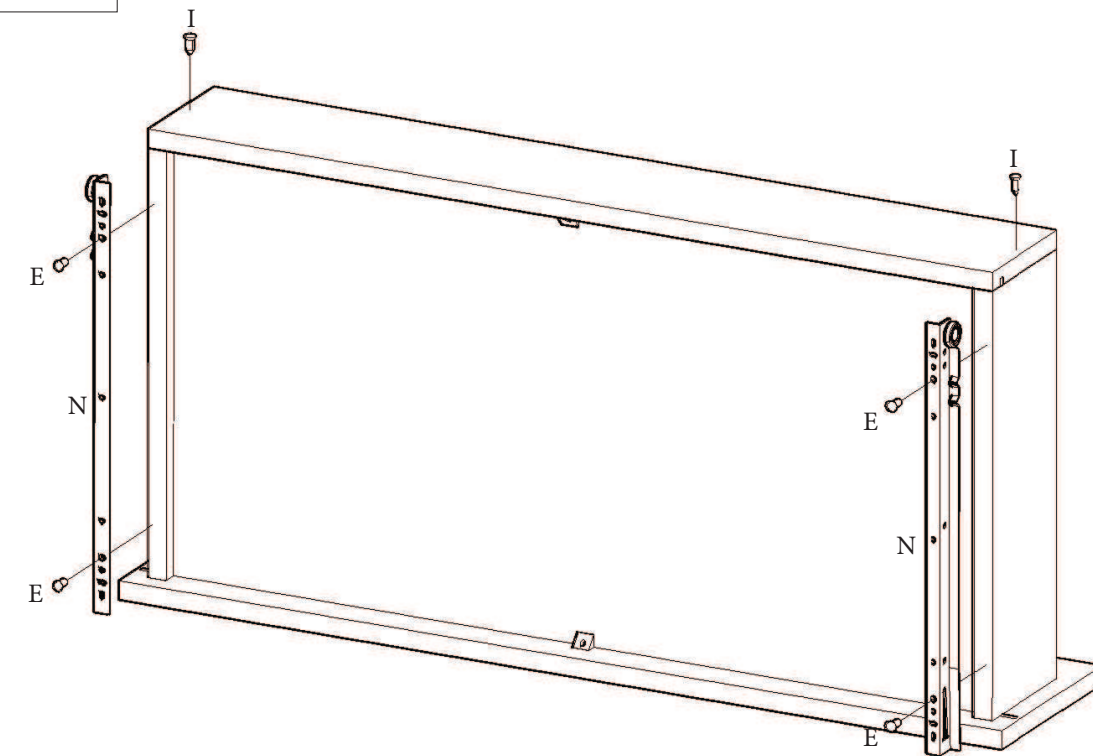
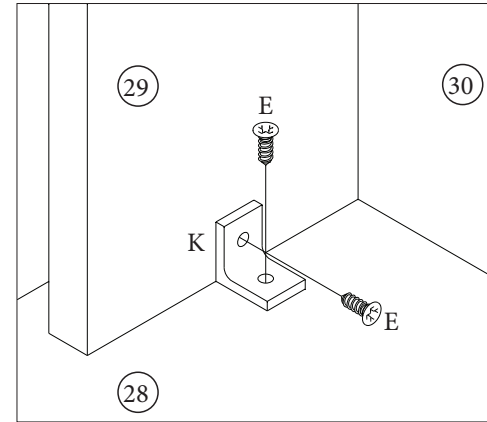
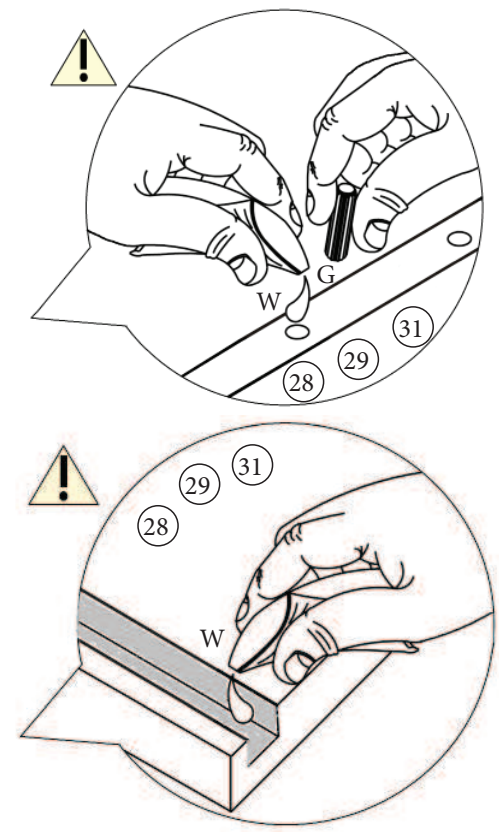
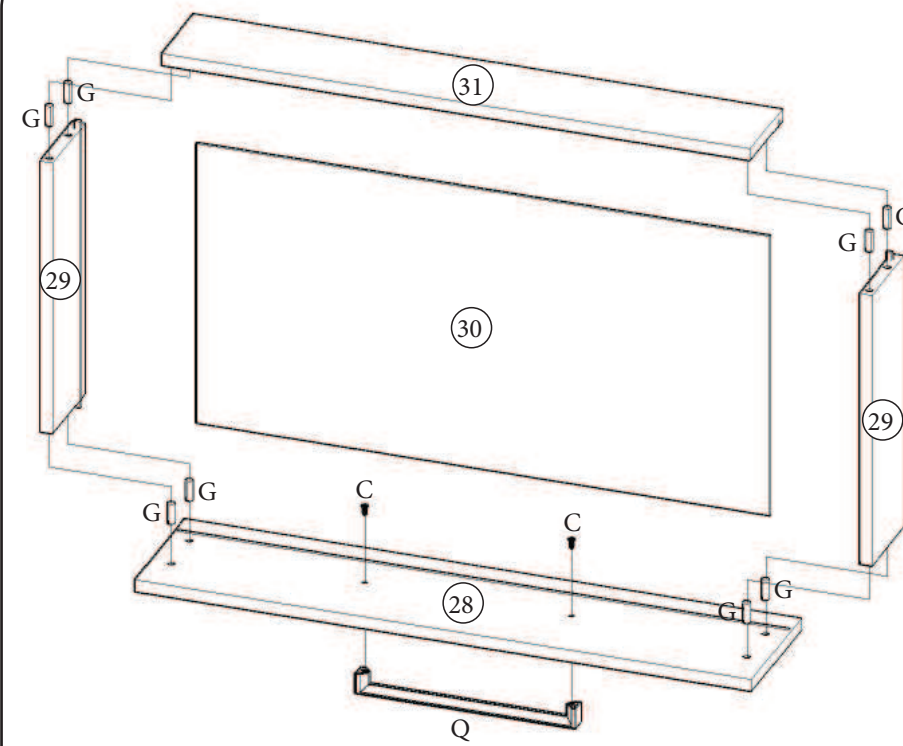
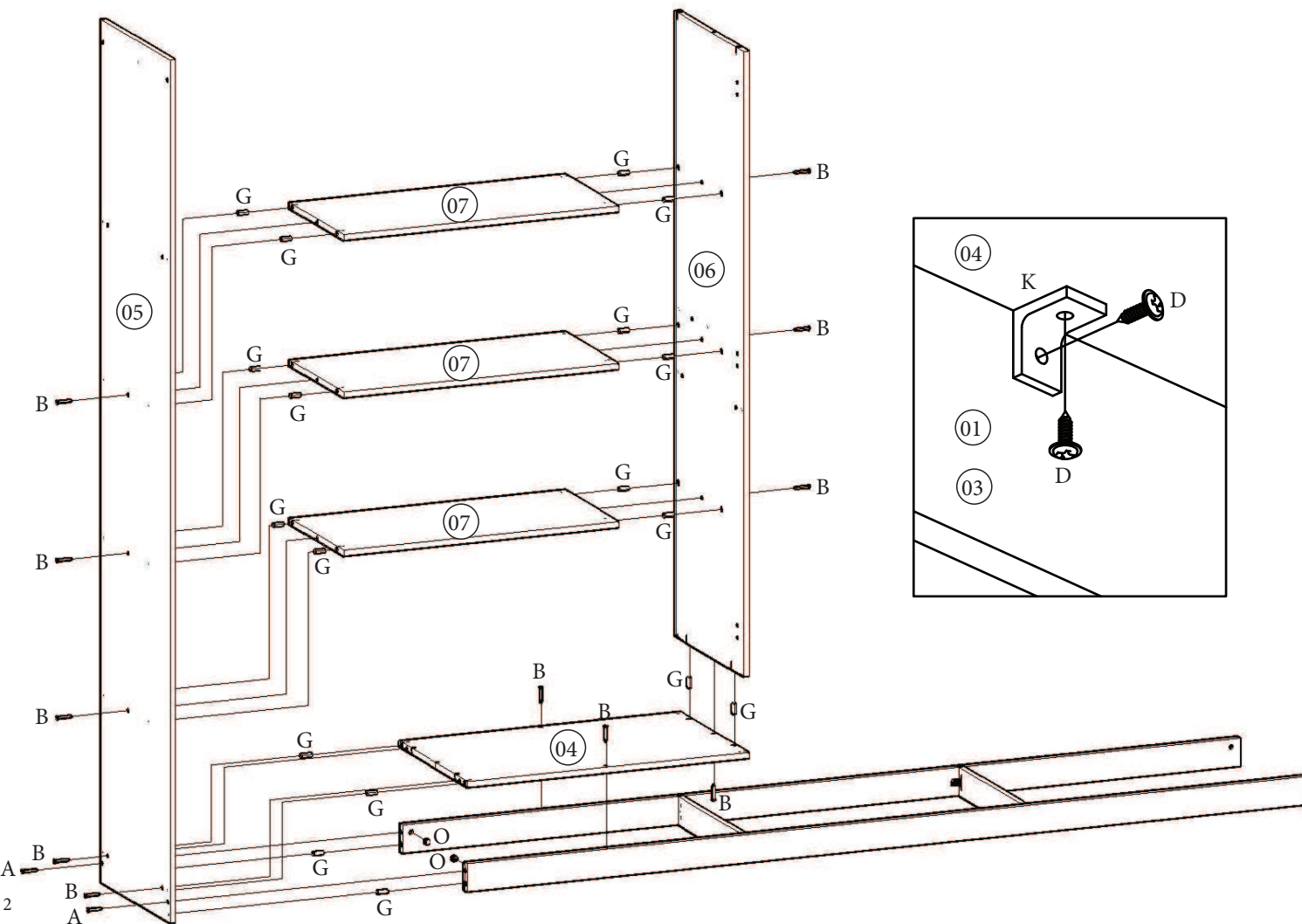
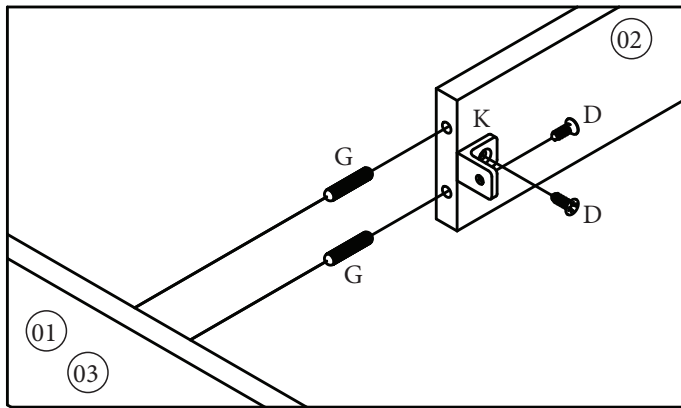
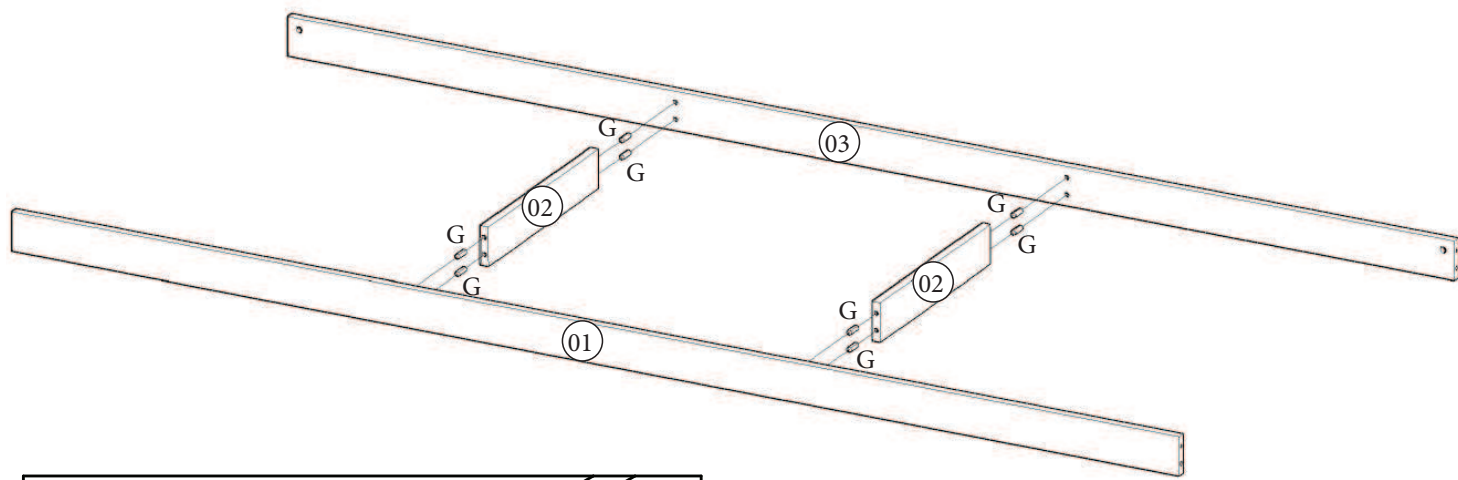

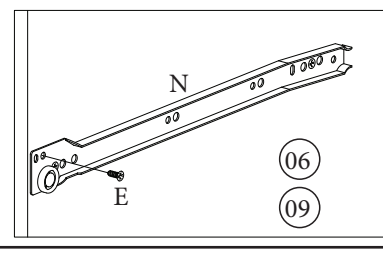
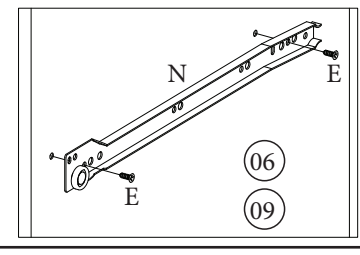
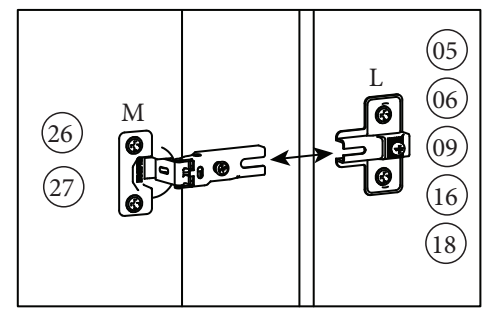
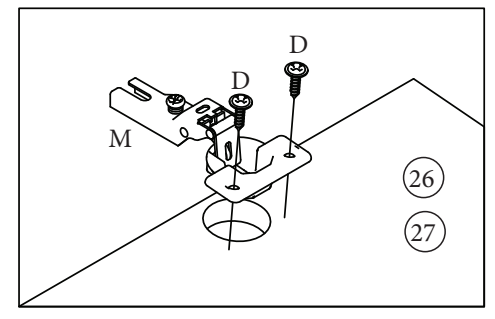
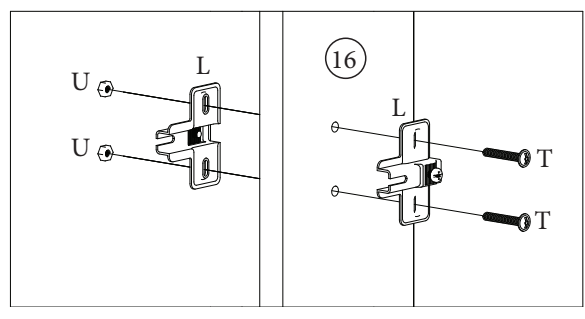
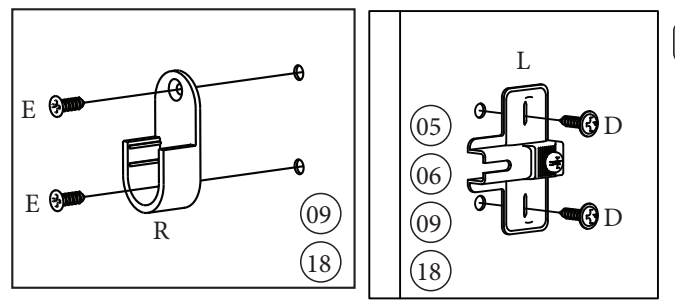
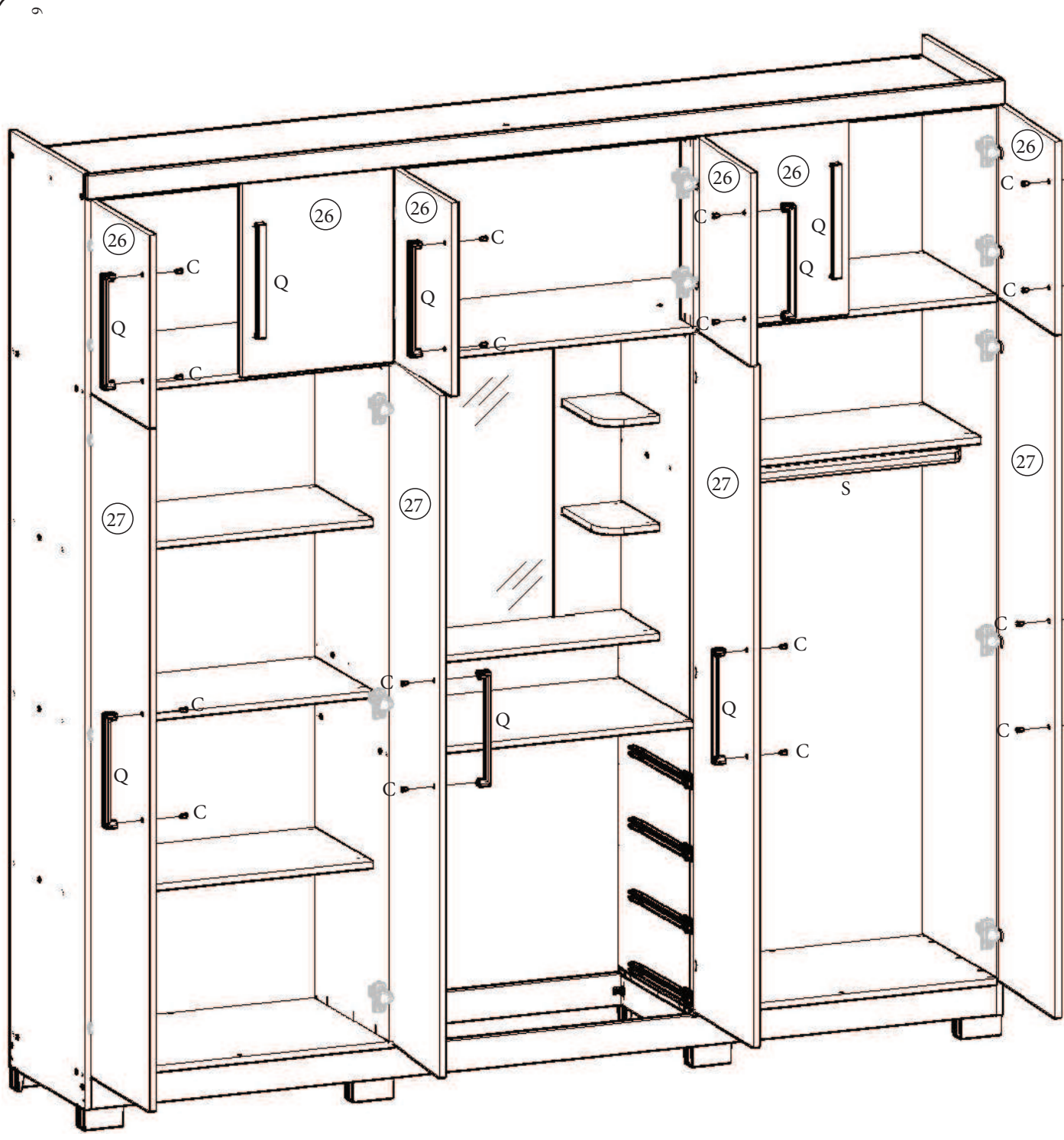

ITM/ID203-

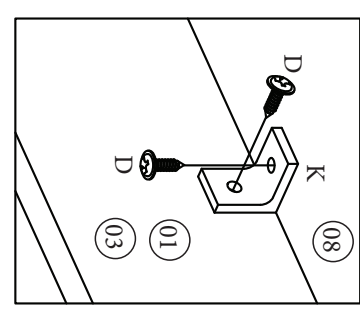
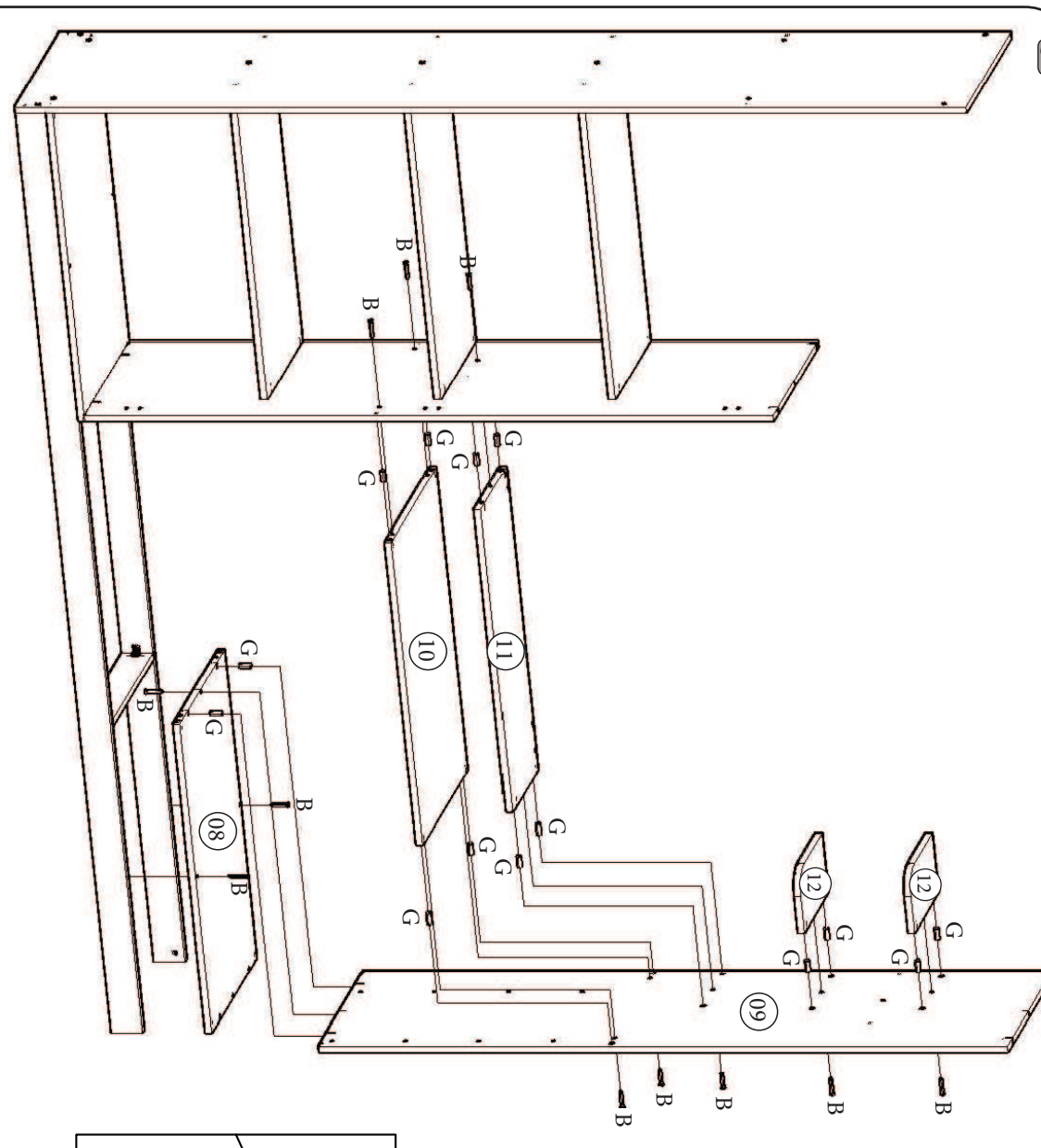
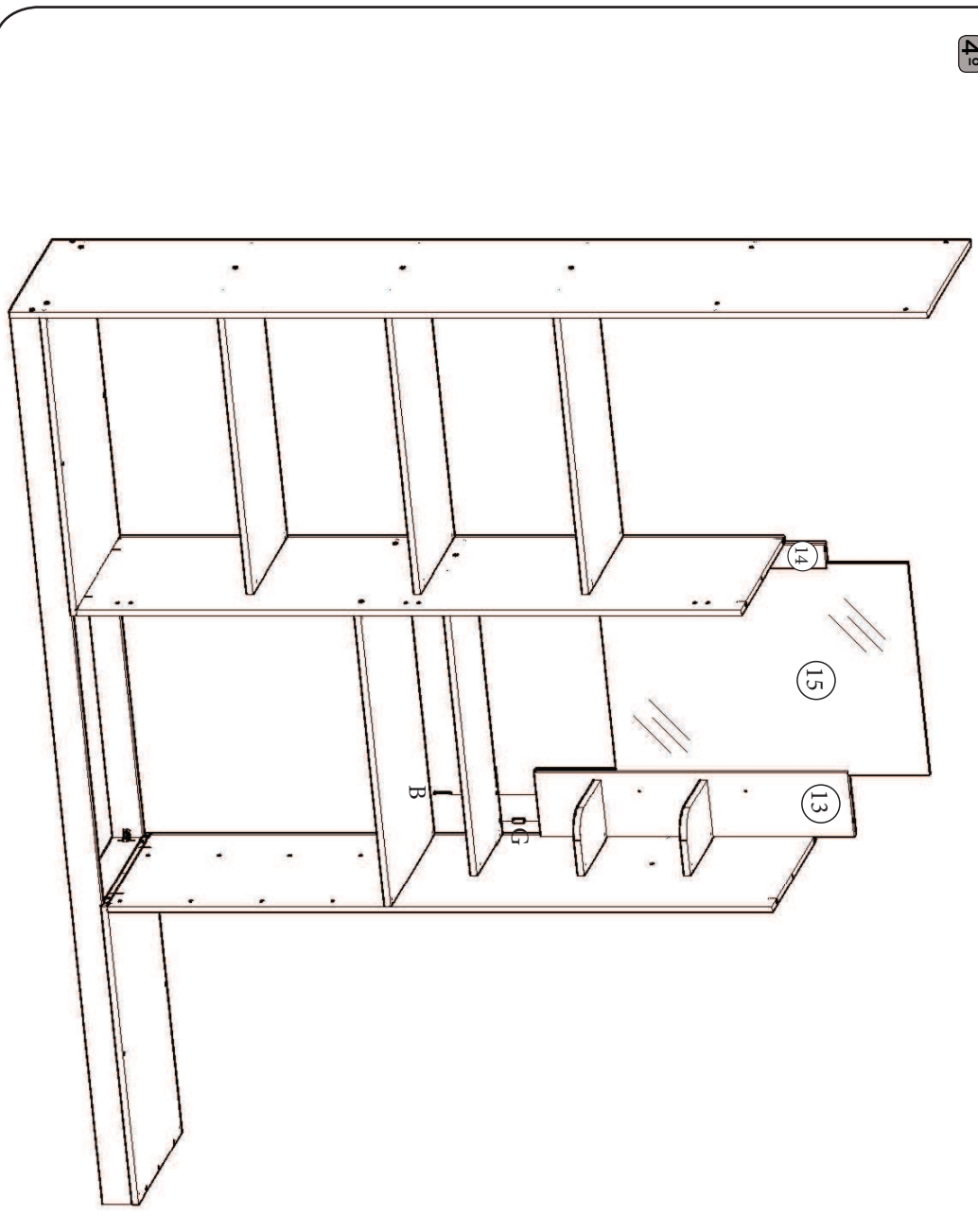

ITM/ID203-

